

WALKER STEET

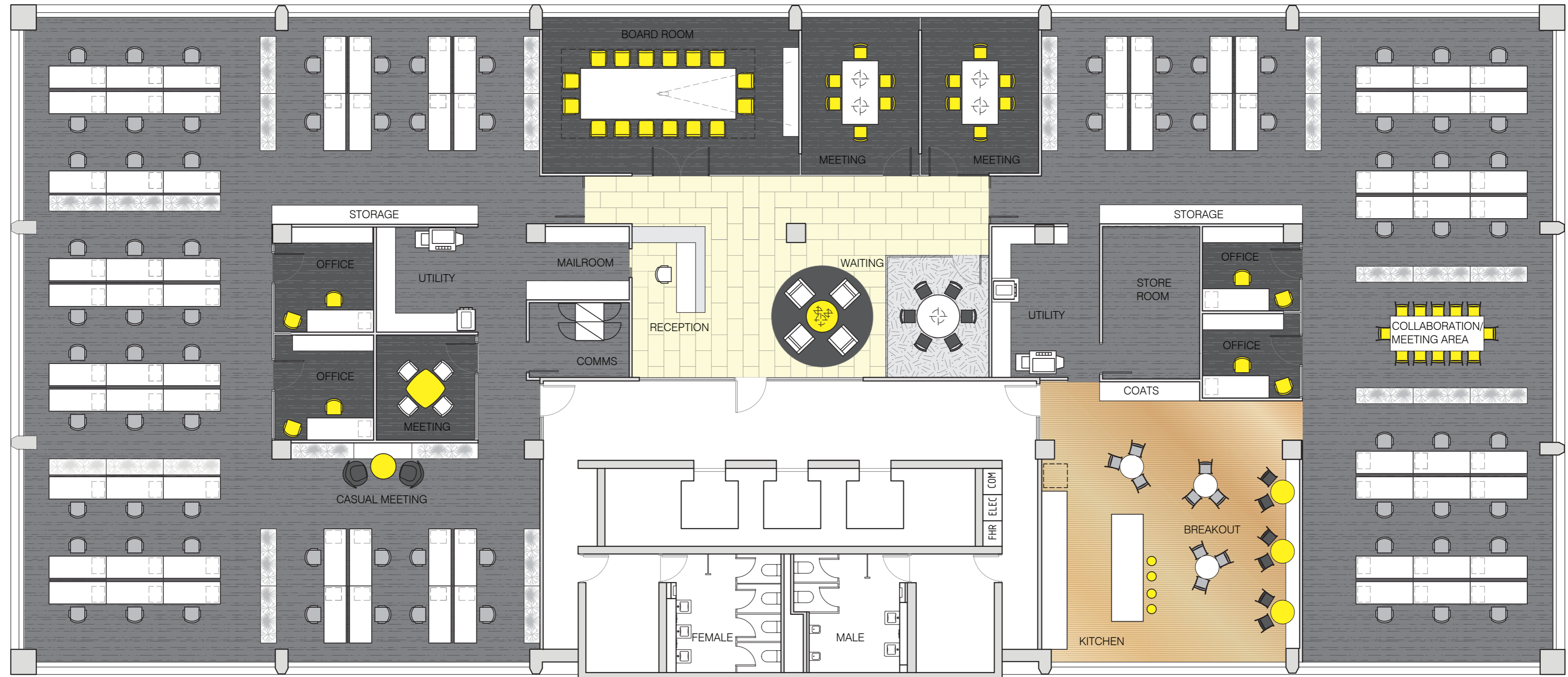

ROYAL PARADE

TENANCY :

WORKSTATIONS:	78
OFFICES:	4
RECEPTION:	1
WAITING:	1
BOARDROOM:	1
MEETING ROOMS:	4
CASUAL MEETING:	2
KITCHEN & BREAKOUT:	1
UTILITY:	2
MAIL ROOM:	1
COMMS ROOM:	1
STORE ROOM:	1
TENANCY AREA:	835 SQM
STAFF/AREA RATIO:	1:10

150135 SK01 1:100@A2

TYPICAL FLOOR
369 ROYAL PARADE, PARKVILLE

PROPOSED OFFICE LAYOUT - WHOLE FLOOR TENANCY

Level 4, 103 Lonsdale Street, Melbourne, Victoria, 3000
+613 9654 4441 info@studio103.com.au www.studio103.com.au

