

PLAN OF LEASE AREAS OF UNIT 'A'
 "ST. HILLIERS ESTATE"
 PERCY STREET, AUBURN

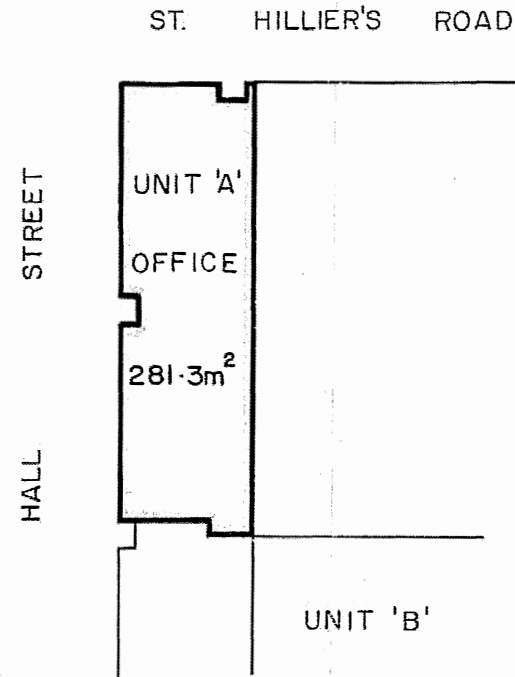
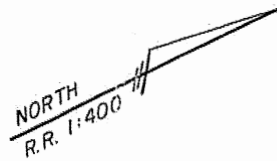
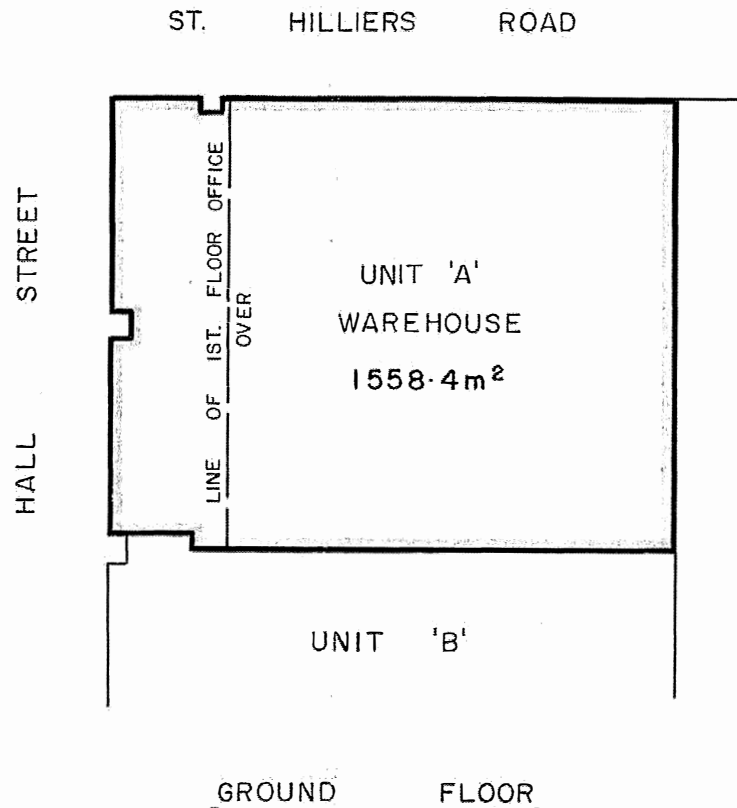

NOTE:

AREAS HAVE BEEN DEDUCED IN ACCORDANCE WITH, AND UNDER INTERPRETATION OF, THE "BOMA METHOD FOR THE MEASUREMENT OF BUILDINGS" REVISED ADDITION MAY 1985 PART 6 GROSS LEASABLE AREA (G.L.A.)

SUMMARY

WAREHOUSE	GRD. FLR.	1558.4m ²
OFFICE	IST. FLR.	281.3m ²
TOTAL G.L.A.		1839.7m ²

IST. FLOOR

