

**CODES:**

WS 000 WORKSTATION TYPE REFER TO FURNITURE SCHEDULE  
 DSK TYPE REFER TO FURNITURE SCHEDULE  
 SMO STORAGE TYPE REFER TO FURNITURE SCHEDULE  
 ESTING STORAGE TYPE REFER TO FURNITURE SCHEDULE  
 TBL TYPE REFER TO FURNITURE SCHEDULE  
 CHA TYPE REFER TO FURNITURE SCHEDULE  
 CRD TYPE REFER TO FURNITURE SCHEDULE  
 CRDZ TYPE REFER TO FURNITURE SCHEDULE  
 DIR TYPE REFER TO FURNITURE SCHEDULE

← DIRECTION OF GRAIN TO VENEER SURFACE

- GENERAL NOTES:**
- FURNITURE PLANS (ASAP SERIES) TO BE READ IN CONJUNCTION WITH FITZ SCHEDULE AND FINISHES SCHEDULE
  - HEAD CONTRACTOR TO OBTAIN AVAILABILITY OF ALL FURNITURE FINISHES ON PLACEMENT OF ORDERS. FINISHES SAMPLES TO BE PROVIDED FOR APPROVAL BY THE DESIGNER AND KEPT ON SITE FOR REFERENCE.
  - HEAD CONTRACTOR TO OBTAIN TECHNICAL SPECIFICATIONS OF ALL FURNITURE OPERATIONAL AND CARE MANUALS ARE TO BE PROVIDED FOR ALL FURNITURE AND ASSOCIATED FINISHES BY SUPPLIERS. THE HEAD CONTRACTOR IS TO COLLECT THIS INFORMATION AND PRODUCE A FOLDER OF TECHNICAL SPECIFICATIONS AND CARE MANUALS.
  - HEAD CONTRACTOR TO OBTAIN TECHNICAL SPECIFICATIONS WITH FINITURE INSTRUCTIONS WHERE THEY REQUIRE SERVICE RETICULATION.
  - HEAD CONTRACTOR TO ALLOW TO REMOVE ALL PROTECTIVE COVERING, PLACE AND ATTACH TO SERVICES ALL WHITE GOODS. ALL DIRECTIONS MANUALS FOR WHITE GOODS TO BE PLACED IN THE CARE MANUAL AND PACKAGED AS PART OF THE WHITE GOODS DELIVERY.
  - WORKSTATION TABLES & OFFICE PARTNERS TO BE CLEANED AFTER REMOVAL OF PROTECTIVE COVERINGS.
  - ALL WORKSURFACES AND TABLES TO BE LEVELLED DURING INSTALLATION TO SUIT ON SITE FLOOR CONDITIONS.

- WHERE LOOSE FURNITURE ITEMS INVOLVE USER OPERATIONAL, IE. HIGHCHAIRS, PLY TABLES, THE SUPPLIER TO PROVIDE TRAINING SESSIONS FOR STAFF AT ALL SITES TO DEMONSTRATE THE PRODUCT OR ADJUST TO SUIT THE USER.
- ALL KITS TO STORED ITEMS ARE TO BE GIVEN TO HEAD CONTRACTOR AND HANDED TO CLIENT AT THE COMPLETION OF THE PROJECT.
- ALL CR Joints TO BE PROTECTED AND INSTALLED AS PART OF HEAD CONTRACTORS SCOPE OF WORKS.

Rev.	Date	Description	Dr.	Chkd.	Appr.
A	18/02/08	PRELIMINARY	AM	JM	BR
B	18/02/08	PRELIMINARY	AM	JM	BR
C	30/03/08	PRELIMINARY	AM	JM	BR
D	03/10/08	TENDER	AM	JM	BR
E	09/10/08	TENDER AMENDMENT	AM	JM	BR
F	07/11/08	FOR CONSTRUCTION	AM	JM	BR
G	19/11/08	FOR CONSTRUCTION	AM	JM	BR
H	25/11/08	FOR CONSTRUCTION	AM	JM	BR

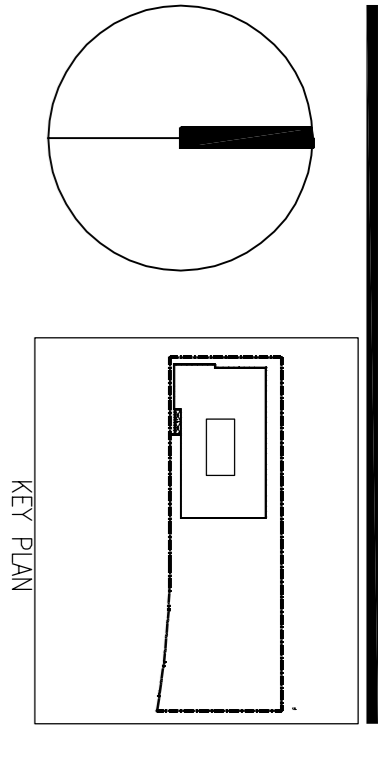

### FOR CONSTRUCTION

**HBO + EMTB**  
 HBO EMTB Interiors  
 Pty Ltd  
 Level 3  
 75 Elizabeth Street  
 Sydney NSW 2001 Australia  
 Tel: (02) 8226 2000  
 Fax: (02) 8226 2000  
 Email: info@hboemt.com.au

**FOSTERS AUSTRALIA**

**LEVEL 7 AND 8**  
**5 RIDER BOULEVARD**  
**LEVEL 8**  
**FURNITURE PLAN**

File Ref: HSP-416 (rev 1) - Corporate New Product/SLD/AM  
 Scale: 1:100 @ A1  
 Job No: SY1416  
 Drawing No: IA-508  
 Rev: H  
 Friday, December 19, 2008

All dimensions subject to on site verification prior to execution of work. Figured dimensions shall be taken in preference to scaling. All rights reserved. © COPYRIGHT of HBO+EMTB Pty. Ltd 2001