

 Atherden Street

7 ATHERDEN
STREET

THE ROCKS

FOR LEASE



7 ATHERDEN STREET

THE ROCKS

The opportunity exists to secure a historical location in the heart of The Rocks.

Built in circa 1881, 7 Atherden Street is commonly known as one of 4 continuous terraces facing the Avery Terraces located on Atherden Street.

The opportunity allows potential tenants to capitalize on a vibrant location servicing the needs of local businesses and visitors alike, ideally suited to bespoke low impact café, High Tea offer or similar.

Coupled with outdoor seating on the corner Playfair and Atherden this is very unique opportunity.

With a significant history your design needs to enhance and capture the surroundings protecting the heritage fabric and providing an offer not currently replicated within The Rocks.

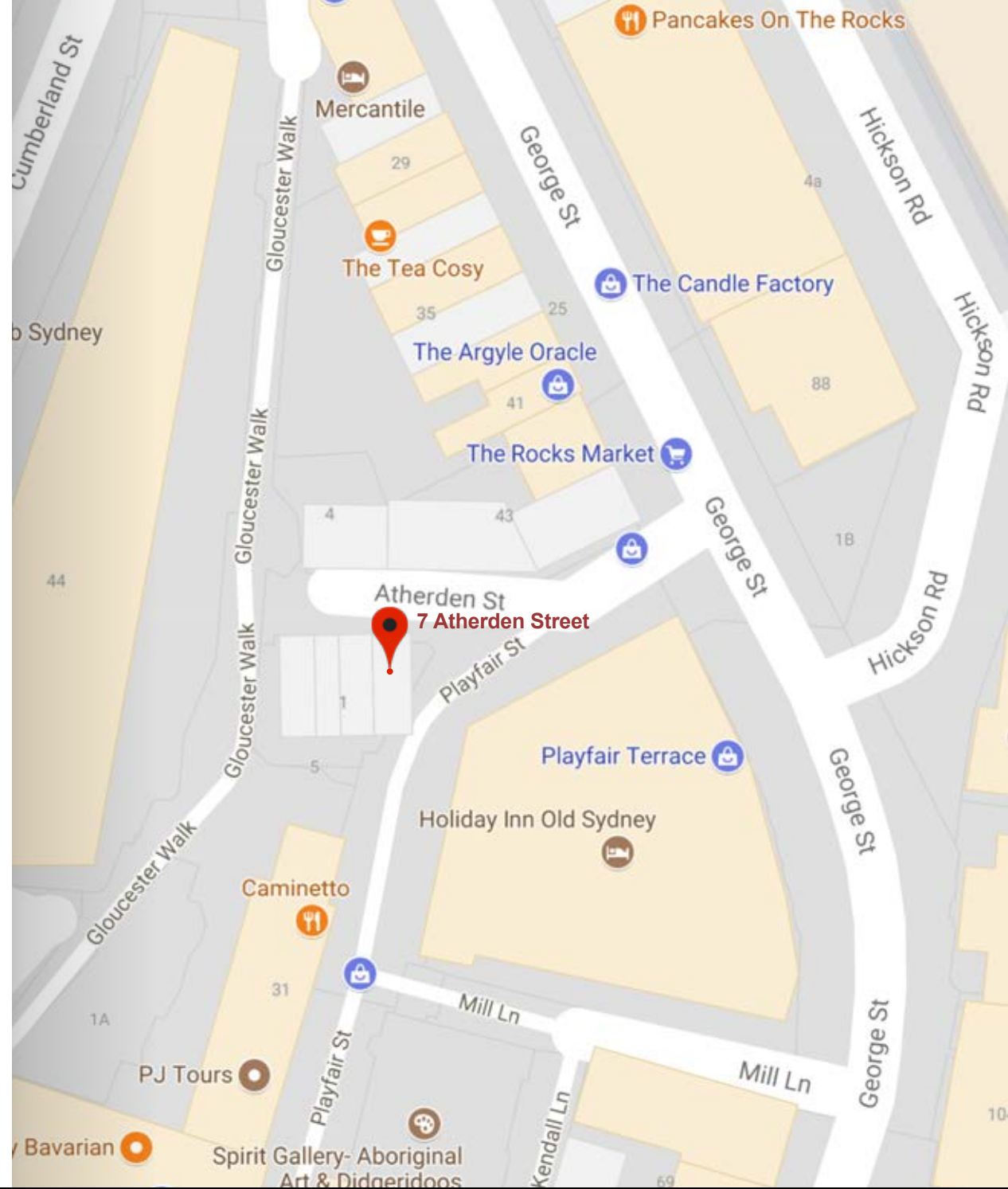

7 ATHERDEN STREET

THE ROCKS

- Multi-level premises, interconnecting stairwell
- Full kitchen facilities
- Full bathroom facilities
- 4 Separate working areas
- A Grand street presence
- A truly unique location steeped in history
- Outdoor seating under license

Ground level 43.1sqm

First Floor 27.9sqm

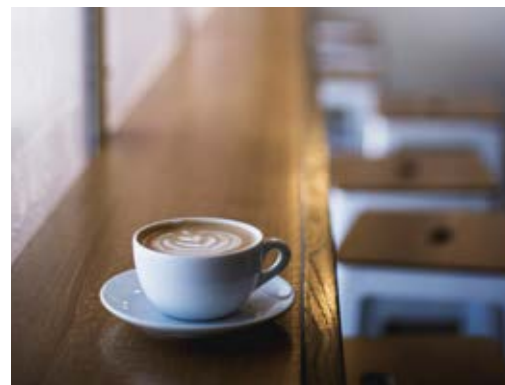

7 ATHERDEN
STREET
THE ROCKS

GROUND LEVEL

NORTH
↓

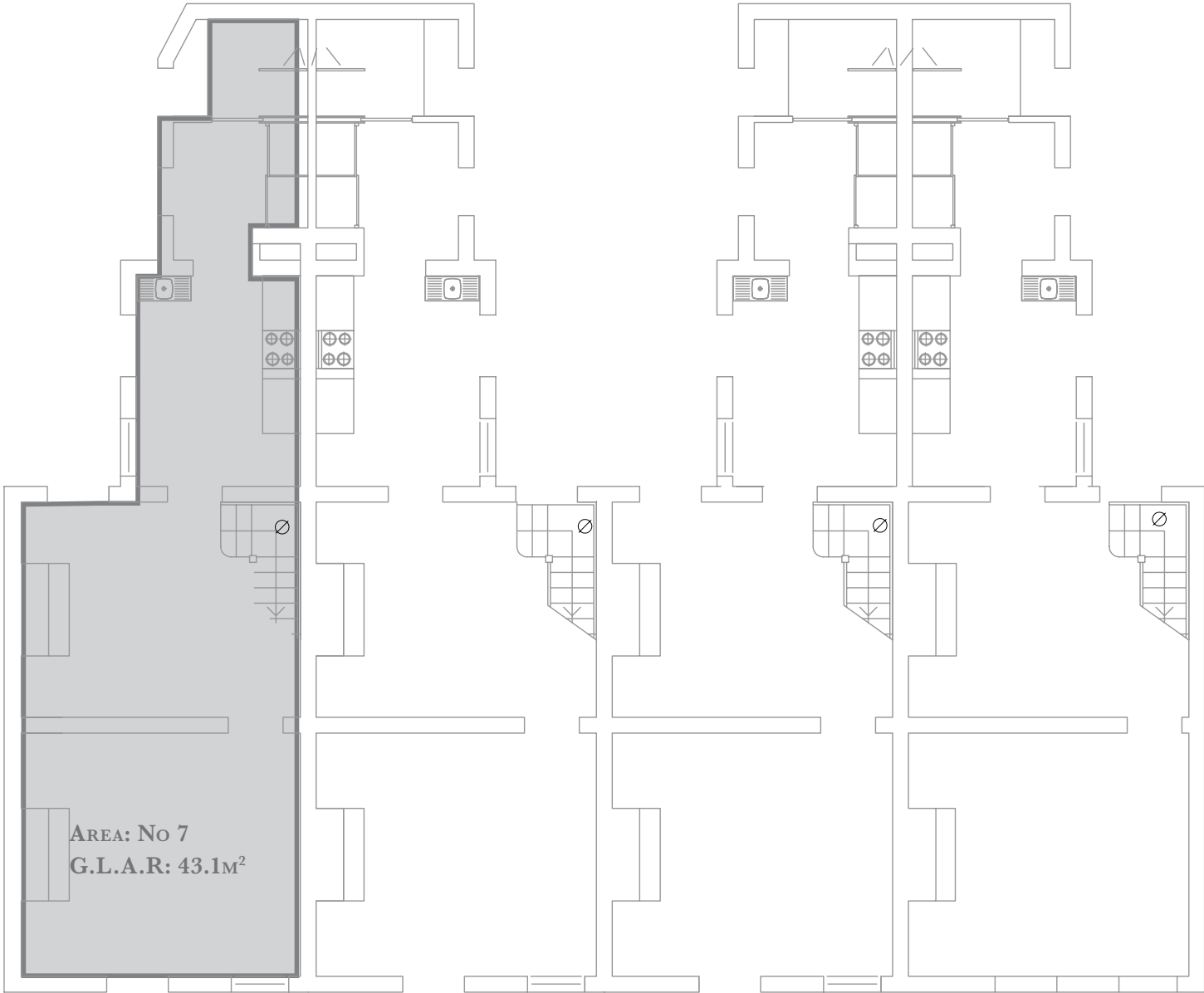

AREA: No 7
G.L.A.R: 43.1M²

7 ATHERDEN
STREET
THE ROCKS

FIRST FLOOR

NORTH
↓

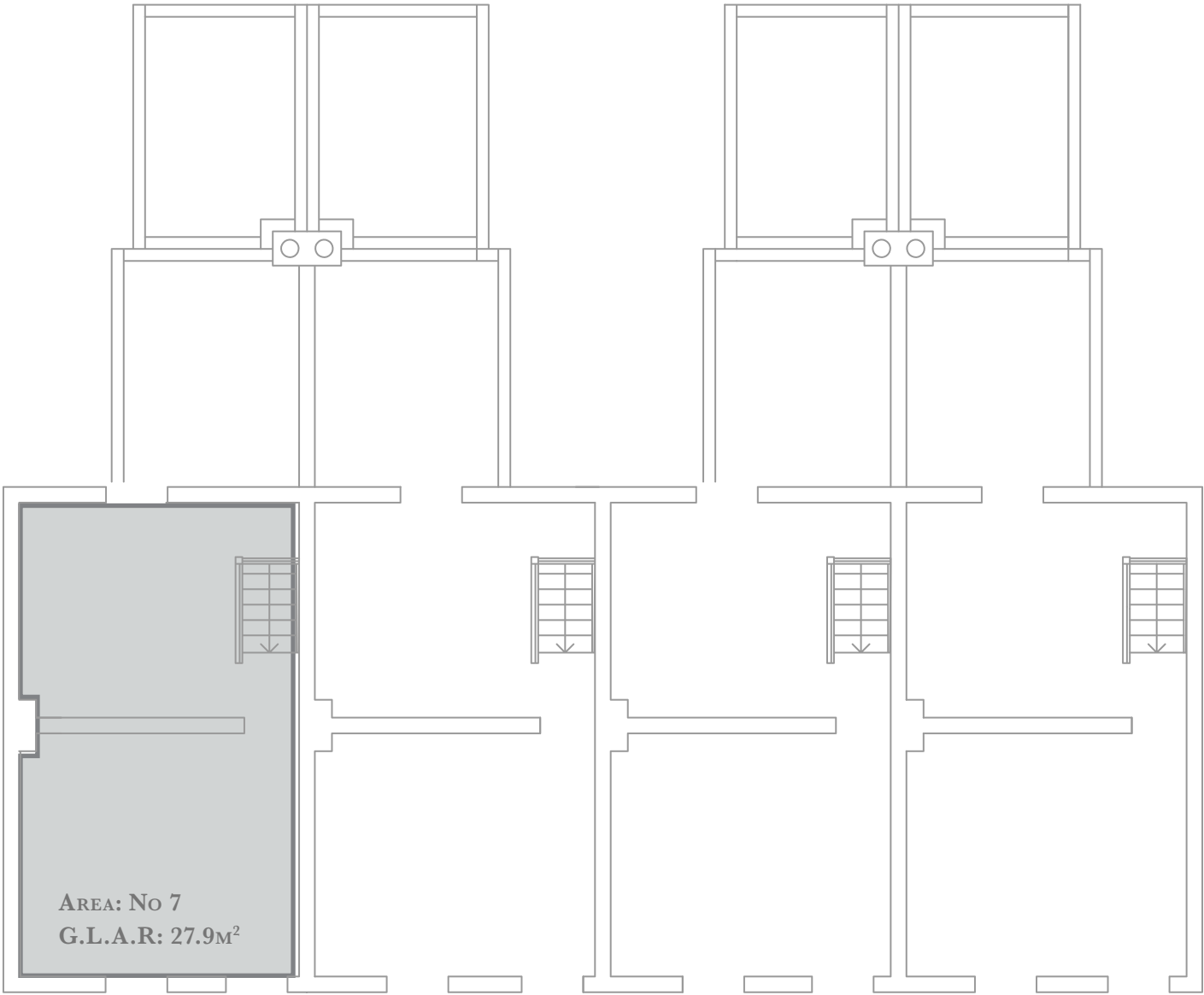

STONEBRIDGE

This exciting retail offering is part of Place Management New South Wales new leasing direction and precinct revitalization welcoming new retailers into an evolving dynamic precinct.

In keeping with The Rocks unique brand and identity, your business should offer an exceptional brand built around passion, style and excellence.

Fitouts are required to be of a premium standard designed to complement the surrounding tenancies and local heritage.

Interested parties or their agents, are not to contact or disrupt any existing tenants occupying the premises.

To inspect or discuss the premises please contact

TIM ANDREWS

Director – Retail Leasing

STONEBRIDGE

Stonebridge Property Group
Level 32, Australia Square
264-278 George Street
Sydney NSW 2000 Australia

M +61 408 616 708

E tandrews@stonebridge.com.au

Stonebridge.com.au