

**GROUND FLOOR**

**FIRST FLOOR**

SIR DONALD BRADMAN DRIVE

**Information Schedule**

Tenancy 2		Tenancy 1	
Ground Floor		Showroom	385.8 m <sup>2</sup>
Showroom	1,026.8 m <sup>2</sup>	Tea / Amenities	24.0 m <sup>2</sup>
Amenities A	6.3 m <sup>2</sup>	<b>Total Area</b>	<b>409.8 m<sup>2</sup></b>
Amenities B	6.2 m <sup>2</sup>		
First Floor			
Showroom	432.4 m <sup>2</sup>		
Tea A	5.0 m <sup>2</sup>		
Amenities A	11.7 m <sup>2</sup>		
Tea B	7.3 m <sup>2</sup>		
Amenities B	13.1 m <sup>2</sup>		
<b>Total Area</b>	<b>1,508.8 m<sup>2</sup></b>		

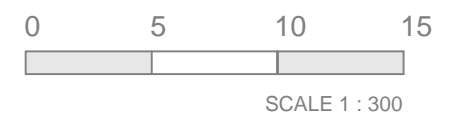

**Disclaimer:** This plan has been prepared for marketing purposes only. Interested parties should undertake their own enquiries as to the accuracy of the information. Areas taken from Realserve Lettable Area Survey, Ref: 44390. Dated: 06/05/13.

Plan Prepared For:

**MARKETING DRAWING**  
12 - 18 Sir Donald Bradman Drive  
Mile End, SA

Date:	23/02/2011
Ref:	44390
Rev:	-
Drawn:	MC
Checked:	IN
Scale:	1:300 @ A3
Sheet:	1 of 2

sydney canberra melbourne brisbane **adelaide** perth

Real Estate Plans & Surveys [www.realserve.com.au](http://www.realserve.com.au)

P 08 8293 5393  
F 08 8219 9954

# LETTABLE AREA PLAN FOR 12-18 SIR DONALD BRADMAN DRIVE, MILE END, SA

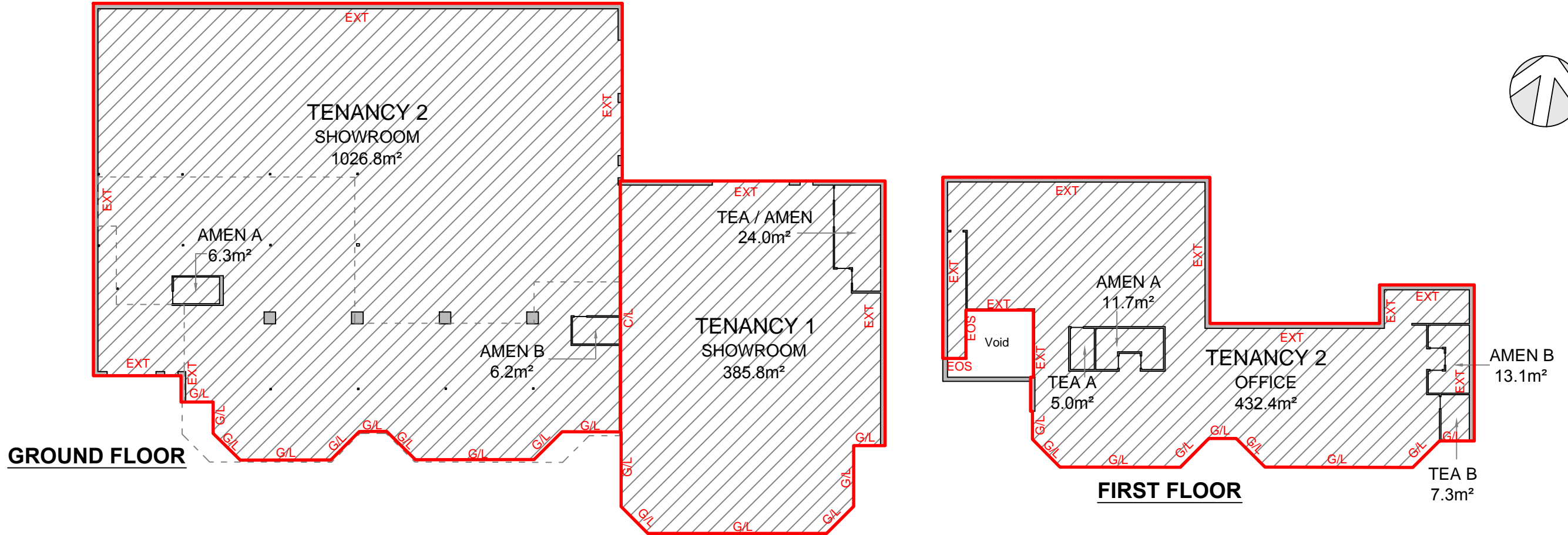
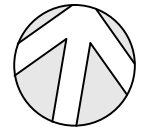

METHOD OF MEASUREMENT	SCHEDULE OF AREAS	
<p>AREAS HAVE BEEN CALCULATED IN ACCORDANCE WITH THE PROPERTY COUNCIL OF AUSTRALIA (PCA) METHOD OF MEASUREMENT FOR LETTABLE AREA (MARCH 1997)</p> <p>(SURVEY DATE 06/05/2011)</p> <p>LETTABLE AREA </p> <p><b>GUIDELINES USED</b></p> <p>GROSS LETTABLE AREA</p>	<p>TENANCY 2</p> <p>GROUND FLOOR</p> <p>SHOWROOM 1,026.8 m<sup>2</sup></p> <p>AMENITIES A 6.3 m<sup>2</sup></p> <p>AMENITIES B 6.2 m<sup>2</sup></p> <p>FIRST FLOOR</p> <p>OFFICE 432.4 m<sup>2</sup></p> <p>TEA A 5.0 m<sup>2</sup></p> <p>AMENITIES A 11.7 m<sup>2</sup></p> <p>TEA B 7.3 m<sup>2</sup></p> <p>AMENITIES B 13.1 m<sup>2</sup></p> <p><b>TOTAL AREA 1,508.8 m<sup>2</sup></b></p>	<p>TENANCY1</p> <p>GROUND FLOOR</p> <p>SHOWROOM 385.8 m<sup>2</sup></p> <p>TEA / AMENITIES 24.0 m<sup>2</sup></p> <p><b>TOTAL AREA 409.8 m<sup>2</sup></b></p>

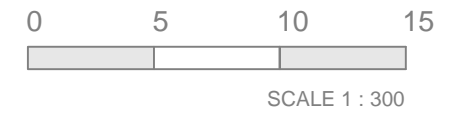

INT - INTERNAL FACE  
 EXT - EXTERNAL FACE  
 C/L - CENTRELINE WALL  
 G/L - GLASS LINE  
 EOS - EDGE OF STRUCTURE

PLAN PREPARED FOR:  
**LEEDWELL  
 PROPERTY**

**LETTABLE AREA PLAN**  
 12 - 18 SIR DONALD BRADMAN DRIVE,  
 MILE END, SA

DATE: 07/05/2013  
 REF: 44390 REV: -  
 DRAWN: MC CHECKED: IN  
 SCALE: 1:300 @ A3 SHEET: 2

sydney canberra melbourne brisbane **adelaide** perth  
**REALSERVE**  
 Real Estate Plans & Surveys  
 P 08 8293 5393  
 F 08 8219 9954  
[www.realserve.com.au](http://www.realserve.com.au)