

NOW LEASING

Woolworths Lake Munmorah - Opening July 2013



RSCS

For all leasing enquiries contact the exclusive leasing agent:

Wayne Hancock
0417 134 608
wayne@rscs.net.au

Emanuel Cassimatis
0419 888 146
emanuel@rscs.net.au

Woolworths
the fresh food people



Woolworths Marketplace Lake Munmorah

The Shopping Centre Features

- 3,800sqm Woolworths supermarket
- 15 specialty stores
- 300sqm medical centre
- 510 on-grade parking spaces
- A range of fresh food, fast food and service shops that will create the community hub for this growing residential catchment

Location

- The new Woolworths shopping centre will be located on the corner of Pacific Highway and Tall Timbers Road
- Pacific Highway is the major carriageway throughout the Wyong region, linking Newcastle to the north with Wyong/Gosford to the south.

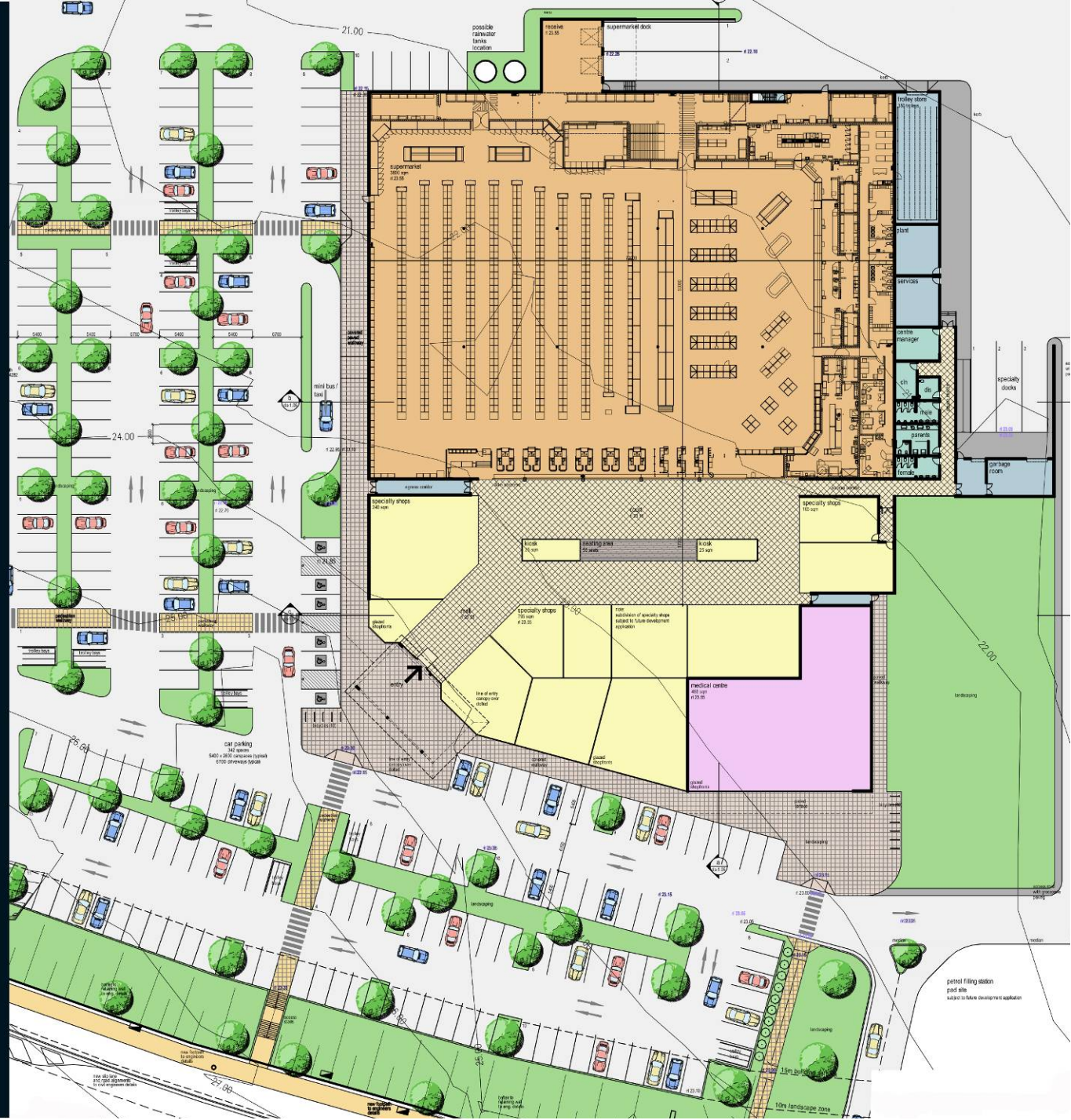

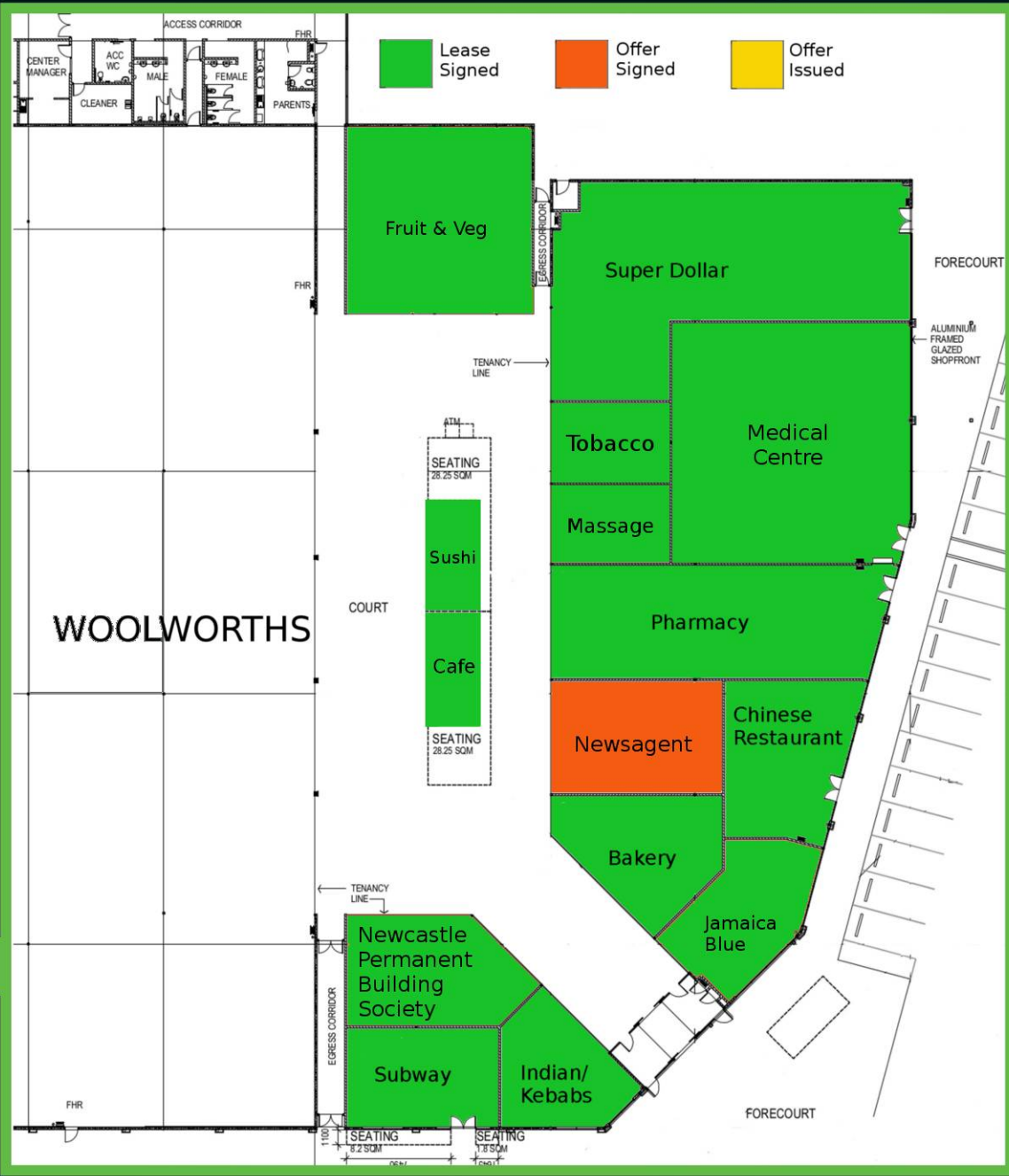

Key Trade Area Facts

- The main trade area has a population of 15,300 people.
- The trade area population is projected to increase to around 18,130 residents by 2016.
- The Lake Munmorah trade area includes a mix of both younger families and older retirees.
- The trade area retail spending for the year to June 2007 is estimated at \$147.2 million, which is projected to increase to \$190.6 million by 2016, reflecting an average real annual growthrate of 2.9%.
- The only supermarket within the trade area currently is a Foodworks store of around 650 sqm at Summerland Point.



For all leasing enquiries contact
the exclusive leasing agents:

Retail Shopping Centre Services

Wayne Hancock
0417 134 608
wayne@rscs.net.au

Emanuel Cassimatis
0419 888 146
emanuel@rscs.net.au

www.rscs.net.au



Disclaimer: Information or visuals contained, enclosed and / or attached in / with this correspondence (including financials) is passed on, through us, by owners and their consultants. We as agents don't verify accuracy. Rely only on your own enquiries. Assume visual images enclosed (eg plans, photography, specifications, artist impressions, brochures) are strictly indicative-conceptual only (any statements to the contrary endorsed on such material are attributable to the author, not us). Appearance or layout of anything depicted may alter at any time without reference to us. All visual material and designs are subject to change at any time. Price lists are not offers to sell / lease / hold properties, or fix an asking price - they are last known asking prices only; we are not valuers and make no comment as to value. "Sold / leased" designations show only that stock is "currently not available" - not that the property is contracted / settled. Any information supplied may have changed since we received it and we take no responsibility for that. No reliance should be placed on any answer or volunteered information in a call with our staff. Statements of any kind will not be deemed authorised unless in writing signed by one of our directors. This document (including attachments) is only intended for its addressee/s and may contain privileged or confidential information. Unauthorised use, copying or distribution of this document or any part of its contents, is prohibited. If you receive this document in error please telephone us and return it by post. We will reimburse you for any reasonable expenses incurred in meeting this request.