



Information Memorandum

Grand Central Towers
15 Bowes Street, PHILLIP ACT
Unit 436 – UP 13537

Sentia Real Estate

Specifications

Type:	Retail/Office	Parking:	1 bay											
Title:	Strata – UP 13537	Unit Number:	C3B (436)											
Area:	142m ²	Site Area:	3,377m ²											
Existing Sublease:	CHP Investments Pty Ltd (t/a Oh My Dough) <table border="1"> <thead> <tr> <th>Unit</th> <th>Area</th> <th>Net Rent</th> <th>Termination Date</th> <th>Option Period</th> </tr> </thead> <tbody> <tr> <td>C3B</td> <td>140</td> <td>\$ 102,200 + GST</td> <td>14 December 2034</td> <td>5 years</td> </tr> </tbody> </table>				Unit	Area	Net Rent	Termination Date	Option Period	C3B	140	\$ 102,200 + GST	14 December 2034	5 years
Unit	Area	Net Rent	Termination Date	Option Period										
C3B	140	\$ 102,200 + GST	14 December 2034	5 years										
Lease Summary:	CHP Investments Pty Ltd currently own two other restaurants in Canberra – Manoosh in Campbell and Greenway. They have committed to a 12 + 5-year lease at Grand Central Towers on a net rent of \$102,200 Per Annum (ex GST). The tenant pays all outgoings and incurs 3.25% annual increases. The tenant has a rent-free period which will end on 15 June 2023 (6 months' rent free from the lease commencement date).													
Outgoings:	<p>*Current outgoings estimate:</p> <table> <tr> <td>General Rates:</td> <td>\$ 4,220.00</td> </tr> <tr> <td>Water & Sewerage Rates:</td> <td>\$ 702.24</td> </tr> <tr> <td>Strata Levies:</td> <td>\$ 3,113.99</td> </tr> <tr> <td>Total Annual Outgoings:</td> <td>\$ 8,036.23</td> </tr> </table> <p>Lessee Share: 100% The Lessee is responsible for paying their share of all outgoings.</p>				General Rates:	\$ 4,220.00	Water & Sewerage Rates:	\$ 702.24	Strata Levies:	\$ 3,113.99	Total Annual Outgoings:	\$ 8,036.23		
General Rates:	\$ 4,220.00													
Water & Sewerage Rates:	\$ 702.24													
Strata Levies:	\$ 3,113.99													
Total Annual Outgoings:	\$ 8,036.23													
Features:	<ul style="list-style-type: none"> ➤ One of only eleven boutique commercial tenancies in the building ➤ 430 apartments above ➤ Fantastic exposure corner tenancy ➤ Shared toilet facilities ➤ Immense growth in this surrounding area over the next 20 years – ACT Governments Planning Strategy indicates Woden Valley will account for 8.35% of the entire ACT population by 2041. ➤ The tenant has commenced an extensive fitout, which is estimated to cost in excess of \$800,000 (ex GST) once completed. 													





Asking Price

\$1,650,000

Our industry tools and market experience have assisted us in preparing the asking price for this property. Note, the sale will be treated as a going concern and therefore will not incur any GST. There is no stamp duty payable at the asking price.

PLAN

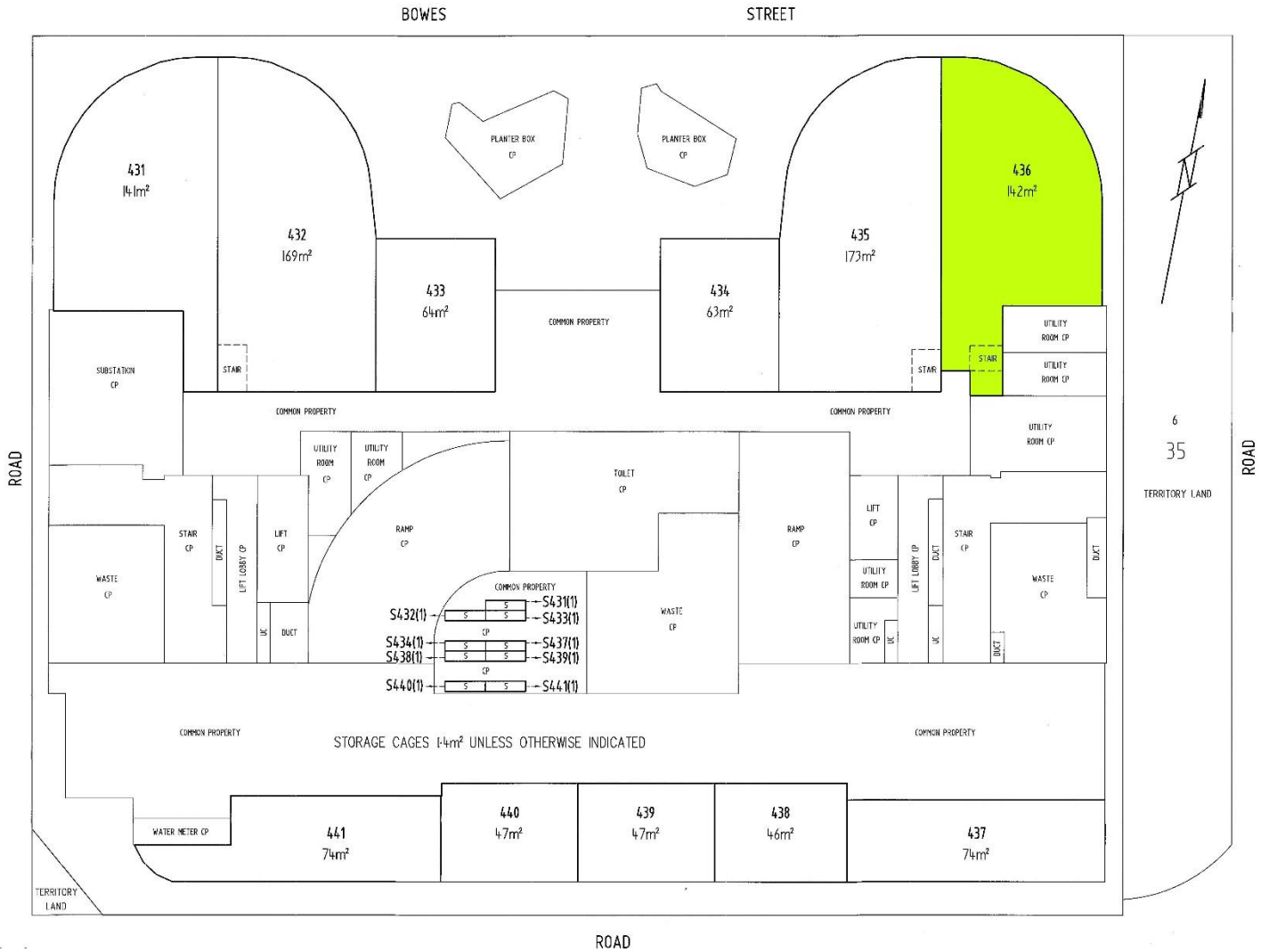

CONTACT



Chris Antos

Director

m. 0422 837 647

chris@sentiaRE.com.au





Our Defining Property is Trust

By engaging Sentia, you are one step closer to achieving your desired results. Real estate is not black and white. There are a spectrum of choices when dealing with property and each decision paints a new picture of possibilities of what could be someone's best move ever.

Your choice of agent, listing method, and marketing materials can all impact on your final result considerably. Sentia are here to guide you in this exciting journey. Our industry leadership, years of experience and passionate agents is the reason we are setting new standards in real estate.



Sentia Vision

To change the way people think when they hear the words “real estate” and make Sentia the nation’s preferred agency by focusing on a quality experience. Our passionate agents are the reason we are setting new standards in real estate.



Sentia Mission

To provide an innovative and honest approach to real estate, with you at the forefront.



Sentia Values

Our team comes first.

We value and reward teamwork over individual effort.

We put ourselves in your shoes.

We can be trusted to do the right thing by our clients and by each other.

We partner with you to deliver a great service using our collective strengths to do our best.

We think and act like owners.

We take responsibility, act with empowerment, and are fully engaged by what we do.

Our reputation is a core asset.

We are authentic, ethical and fair. We strive to be known for our commitment to honesty, trust and transparency in the Real Estate industry.



Sentia Real Estate

WINNER: COMMERCIAL AGENCY OF THE YEAR



Sentia Real Estate

WINNER: COMMERCIAL AGENCY OF THE YEAR



Through engaging Sentia, you have peace of mind that you are working with one of the best agencies in the industry.

Services



Sales

Whether you are first-time seller or a real estate mogul, selling a property is one of the biggest financial decisions you can make—each and every time. Our quality of service and marketing is unparalleled and provides the best circumstances for a straightforward and successful sale.



Property Management

Our experienced agents help you increase your bottom line while taking the hassle out of managing your property.

We use sophisticated software that reliably controls the finest details of property management, ensuring consistent owner payouts and providing straightforward and easy-to-read monthly reports directly to your email. For all maintenance requests, take advantage of our expert and reliable network of tradespeople for all your maintenance needs.



Leasing

Rent your property faster—and to the right tenants. Let our experts do the job for you. Along with our extensive database, we promote your property to the largest possible leasing market.

Our comprehensive listing services will increase viewings and help you rent your property faster and our agents prepare intelligent lease agreements, built upon our many years of experience, which protects all of your interests as a landlord.



Project Sales

Our client base is diverse and so are our services. Working with Canberra's top developers makes the project sales area a natural fit for both us and our clients.

With so many mixed-use developments being constructed in our region, an agent that can advise with whole of project in mind means our clients have a seamless highly integrated service that ultimately creates a better outcome.

Our Team

The Sentia sales and leasing team offers you dedicated agents, multi-skilled in both the residential and commercial realms ensure a seamless approach to any listing. We take immense pride in our amazing team of highly passionate agents.

Real estate is not black and white. There is a spectrum of choices when dealing with property. Each decision paints a new picture of possibilities of what could be your best move ever. Of all the factors that affect the best value and terms when selling or leasing your property, partnering with knowledgeable and experienced agents should be at the top of the list.



Chris Antos
Director
0422 837 647



Alex Smith
Director
0409 007 649



Simon McGuire
Director
0418 693 635



Julian Glover
Client Manager
0417 235 264



Andrew Brient
Client Manager
0400 165 120



Perry Cole
CFO
0420 555 870



Phyllis Lourandos
Centre Manager Fyshwick Markets
0412 622 590



Christopher Farmer
Executive - Sales & Leasing
0415 735 777

Next Steps

Should you be interested in purchasing this property, please contact Chris Antos for a copy of the lease and the sale proposal.

Sentia Real Estate

33 Flinders Way
Griffith ACT 2603

Alex Smith

Director
0409 007 649
alex@sentiaRE.com.au

Julian Glover

Client Manager
0417 235 264
julian@sentiaRE.com.au

Andrew Brient

Client Manager
0400 165 120
andrew@sentiaRE.com.au

Phyllis Lourandos

Centre Manager - Fyshwick Fresh Food Markets
0412 622 590
phyllis@sentiare.com.au

Chris Antos

Director
422 837 647
chris@sentiaRE.com.au

Simon McGuire

Director
0418 693 635
simon@sentiaRE.com.au

Perry Cole

CFO
0420 555 870
perry@sentiare.com.au

Christopher Farmer

Executive - Sales & Leasing
0415 735 777
ChrisF@sentiaRE.com.au