

SITE ANALYSIS

• **LOT 11 CENTRO COURT BROOKLYN**
 SITE AREA: 765.00 sqmtrs
 BUILDING AREAS: WAREHOUSE 15.2 x 25.0 = 380.00 sqmtrs
 OFFICE 11.0 x 6.0 (less splay 3.0) 63.00 sqmtrs
 TOTAL BLDG AREA 443.00 sqmtrs
 Less Loading Bay 3.6 x 7.6 27.36 sqmtrs
 Toilet 3.1 x 2.6 8.00 sqmtrs
 Entry 2.00 sqmtrs
 Ext. Walls 16.00 sqmtrs
 Sub-total 53.36 sqmtrs
 Leaseable Floor Area 389.64 sqmtrs
 1.5 cars/100 sqmtrs
 3.896 x 1.5 = 5.844 cars (less than 6.5 = 6 cars)
 SITE COVERAGE: 57.90%

• **LOT 10 CENTRO COURT BROOKLYN**
 SITE AREA: 775.00 sqmtrs
 BUILDING AREAS: WAREHOUSE (23.2 x 20) - 34 430.00 sqmtrs
 OFFICE 6.0 x 8.2 49.20 sqmtrs
 TOTAL BLDG AREA 479.20 sqmtrs
 Less Loading Bay 3.6 x 7.6 27.36 sqmtrs
 Toilet 3.1 x 2.6 8.00 sqmtrs
 Entry 2.00 sqmtrs
 Ext. Walls 16.00 sqmtrs
 Sub-total 53.36 sqmtrs
 Leaseable Floor Area 425.84 sqmtrs
 1.5 cars/100 sqmtrs
 4.258 x 1.5 = 6.38 cars (less than 6.5 = 6 cars)
 SITE COVERAGE: 54.94%

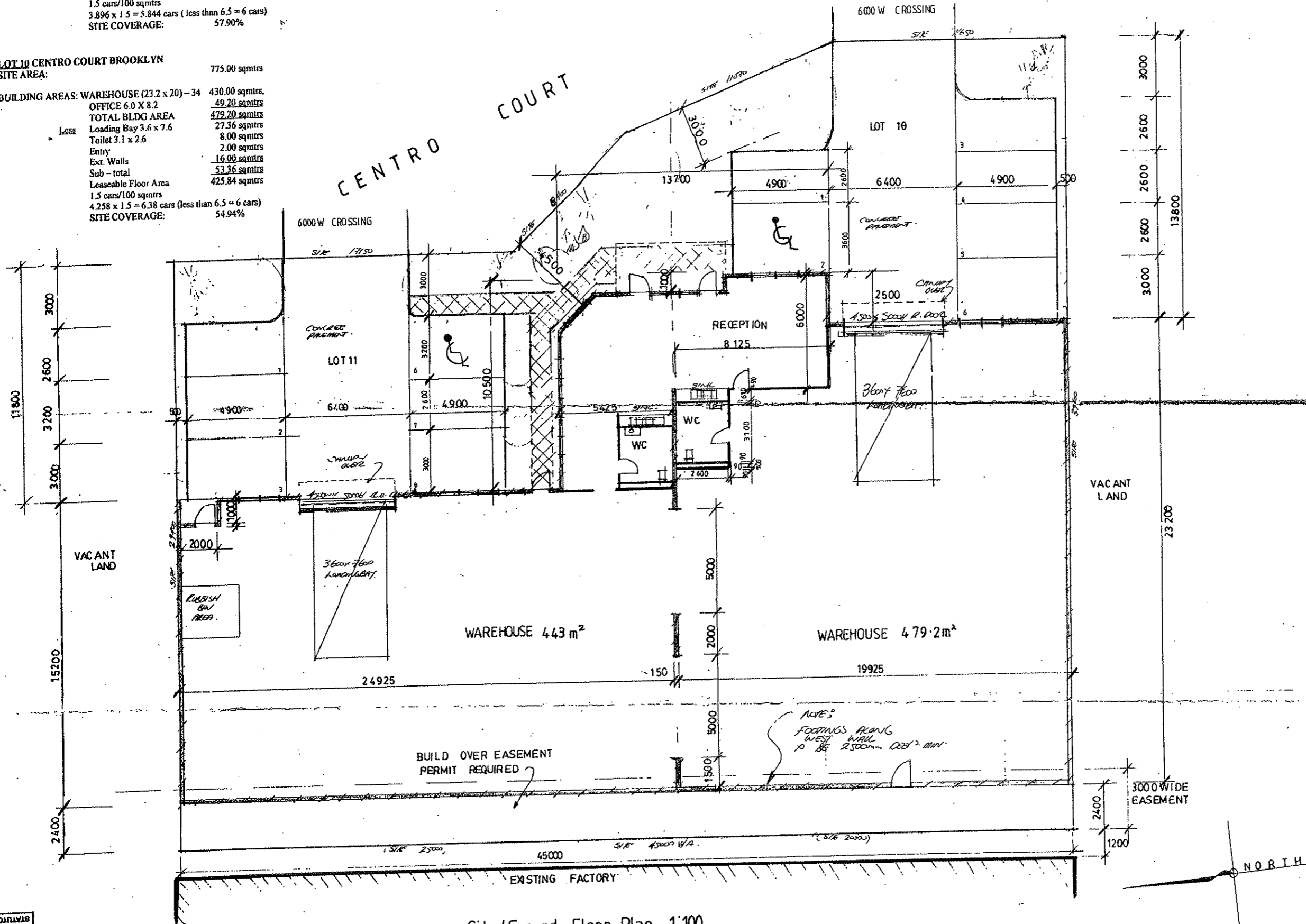

Site/Ground Floor Plan 1:100

RECEIVED BY
 6 JUL 2005
 STATUTORY PLANNING

PLANNING & ENVIRONMENT ACT 1987
 BRIMBANK PLANNING SCHEME
 Plans referred to in Planning Permit
 Application No. 1782/2005
 Sheet 1 of 4
 STATUTORY PLANNING
 Date: 28 SEP 2007

PROPOSED WAREHOUSE
 LOTS 10-11 CENTRO CRT
 BROOKLYN

FOR A. BASILE

drawn AT
 date 21/11/05
 amendments 4, 5, 7, 14, 15, 16, 17, 18, 19, 20, 21, 22, 23, 24, 25, 26, 27, 28, 29, 30, 31, 32, 33, 34, 35, 36, 37, 38, 39, 40, 41, 42, 43, 44, 45, 46, 47, 48, 49, 50, 51, 52, 53, 54, 55, 56, 57, 58, 59, 60, 61, 62, 63, 64, 65, 66, 67, 68, 69, 70, 71, 72, 73, 74, 75, 76, 77, 78, 79, 80, 81, 82, 83, 84, 85, 86, 87, 88, 89, 90, 91, 92, 93, 94, 95, 96, 97, 98, 99, 100
 job no 6018-1 M2

COMPLETE
 DRAFTING SERVICE

ANDREW FARRUGIA
 PH: 9471 3333
 Mobile: 0414 541 107



60 CROWN STREET, MELB VIC 3122
 FOR PROFESSIONAL
 DRAWING AND SERVICE

STATUTORY PLANNING
 1 JUL 05
 RECEIVED BY