

## FIRE SAFETY MEASURES

### EXISTING FIRE SAFETY MEASURES

FIRE DETECTION & ALARM SYSTEM	AS1670.1 - 1991
EMERGENCY LIGHTING	AS2293.1 - 1998
EXIT LIGHTS	AS2293.1 - 1998
PORTABLE FIRE EXTINGUISHERS	AS2444 - 1985
FIRE DOORS	AS 1905.1 - 1990
EWIS	AS 2220.2 - 1986
FIRE CONTROL CENTRE	BCA90 E1.8
ACCESS PANELS & HOPPERS	BCA90 C3.13
FIRE HYDRANT INSTALLATION	REFER ANNUAL FIRE SAFETY STATEMENT
FIRE HOSE REELS	REFER ANNUAL FIRE SAFETY STATEMENT
AUTOMATIC FIRE SPRINKLERS	REFER ANNUAL FIRE SAFETY STATEMENT

NOTE: NO CHANGES PROPOSED TO EXISTING FIRE SAFETY INSTALLATIONS.

### LEGEND

CARPET	CARPET TILE FINISH TO SPEC
D01 - D03	ALUM. FRAMED GLAZED SLIDING DOOR TO SPEC
D04	FLUSH PANEL POCKET SLIDING DOOR TO SPEC
DESK 1 - 6	STANDARD 1800 x 1800 MELAMINE FINISH WORKSTATION (COLOUR TBA)
HGP	HALF-GLASS PARTITION, SOLID WALL UP TO 1000MM ABOVE FLOOR
FHGP + F	FULL HEIGHT ALUM FRAMED GLASS PARTITION + FILM TO SPEC
PB1	FULL HEIGHT STEEL STUD & PLASTERBOARD PARTITION TO SPEC
PB2	FULL HEIGHT STEEL STUD & PLASTERBOARD ACOUSTIC PARTITION TO SPEC
WP1	WORKSTATION PARTITION 1350H WITH PINBOARD FABRIC LINING (COLOUR TBA)
3DMP	3 DRAWER MOBILE PEDESTAL 450MM WIDE
2DLF	3 DRAWER LATERAL FILE 900W x 500D x 670H
4DFC	4 DRAWER FILING CABINET 470W x 600D x 1370H
OHS1	OVERHEAD SHELF 1200W x 350H x 750H
OHS2	OVERHEAD SHELF 900W x 350D x 750H
OHC1	OVERHEAD CUPBOARD 900W x 350D x 900H
SS	STAINLESS STEEL SINK WITH DRAINAGE TO SPEC
SAFE	710W x 640D x 1200H SAFE
SH1	SHELF UNIT 1 1200W x 400D x 2100H - 5 SHELVES

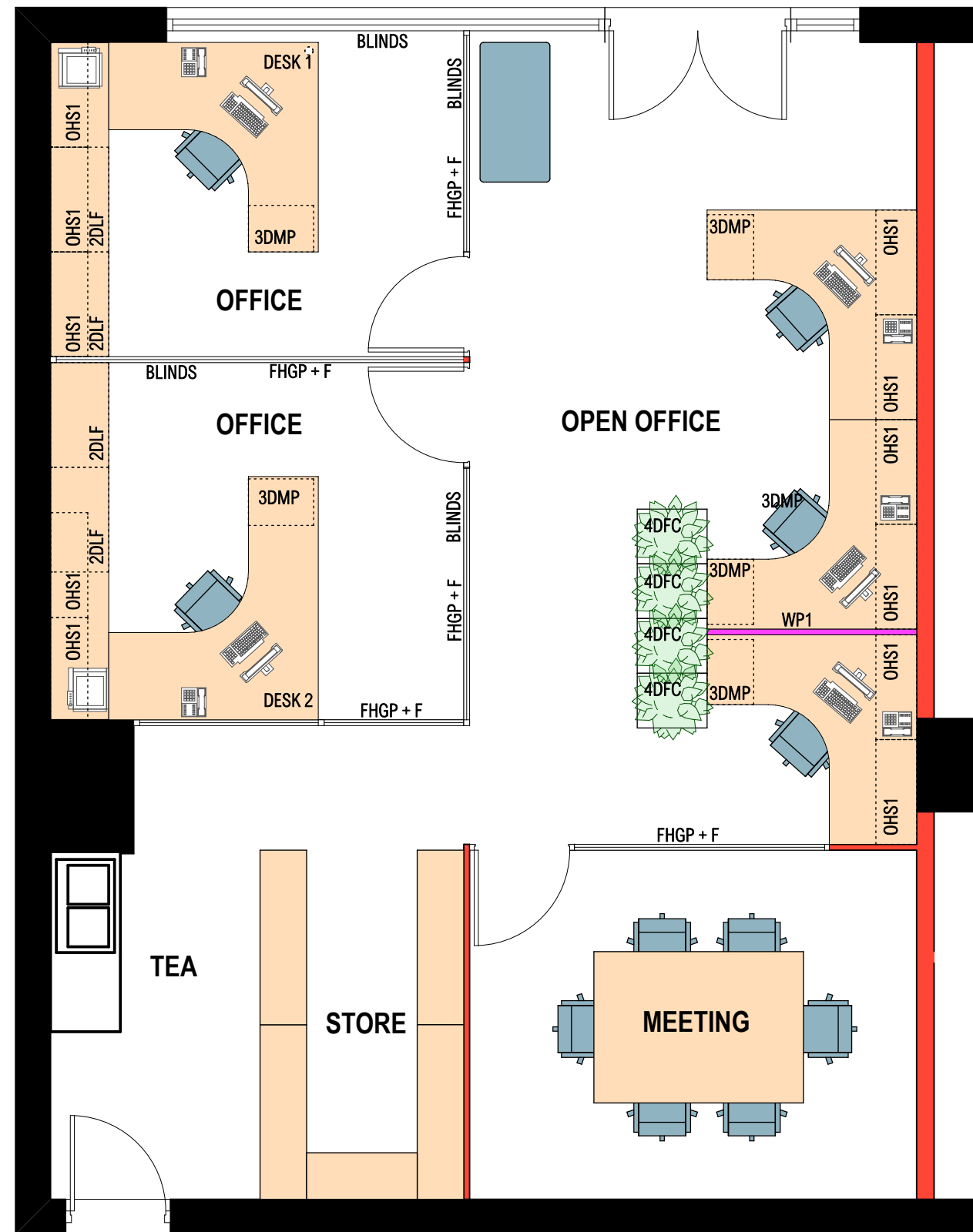
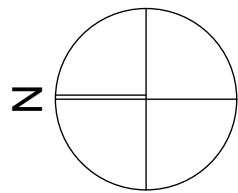

## TENANCY G2 - CONCEPT LAYOUT

1:50