

FIRST FLOOR

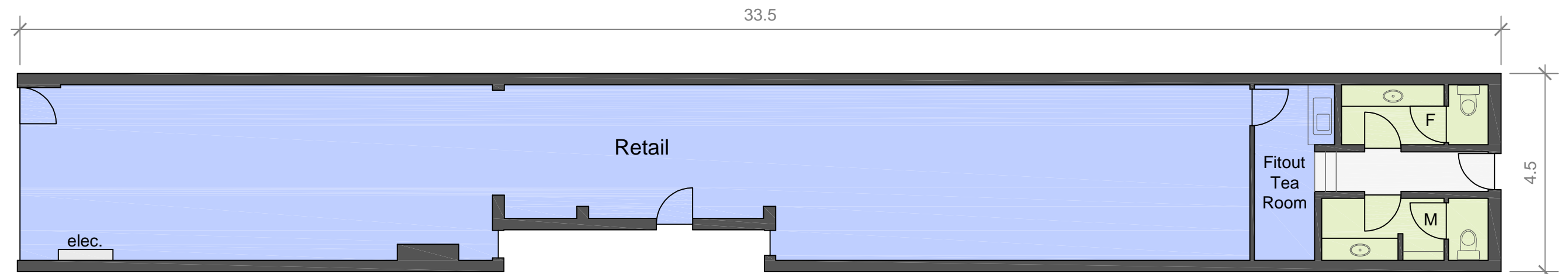
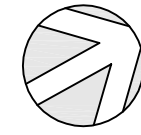

GROUND FLOOR

Information Schedule

Ground Floor	
Retail	119 m ²
Fitout Tea Room	6 m ²
Amenities	13 m ²
Accessway	5 m ²
First Floor	
Office	71 m ²
Total Area	214 m²

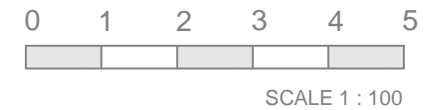

Disclaimer: This plan has been prepared for marketing purposes only. Interested parties should undertake their own enquiries as to the accuracy of the information. Areas are approximate and dimension rounding may result in area discrepancies.

Plan
Prepared
For:



MARKETING DRAWING
487 Malvern Road
SOUTH YARRA, VIC

Date: 26/04/2012	
Ref: 41226	Rev: 0
Drawn: AP	Checked: IN
Scale: 1:100 @ A3	Sheet: 2 of 2

sydney canberra **melbourne** brisbane adelaide perth



Real Estate Plans & Surveys

P 03 9415 6565

F 03 9923 6307

www.realserve.com.au