

10 0 20 40 60 80 100mm

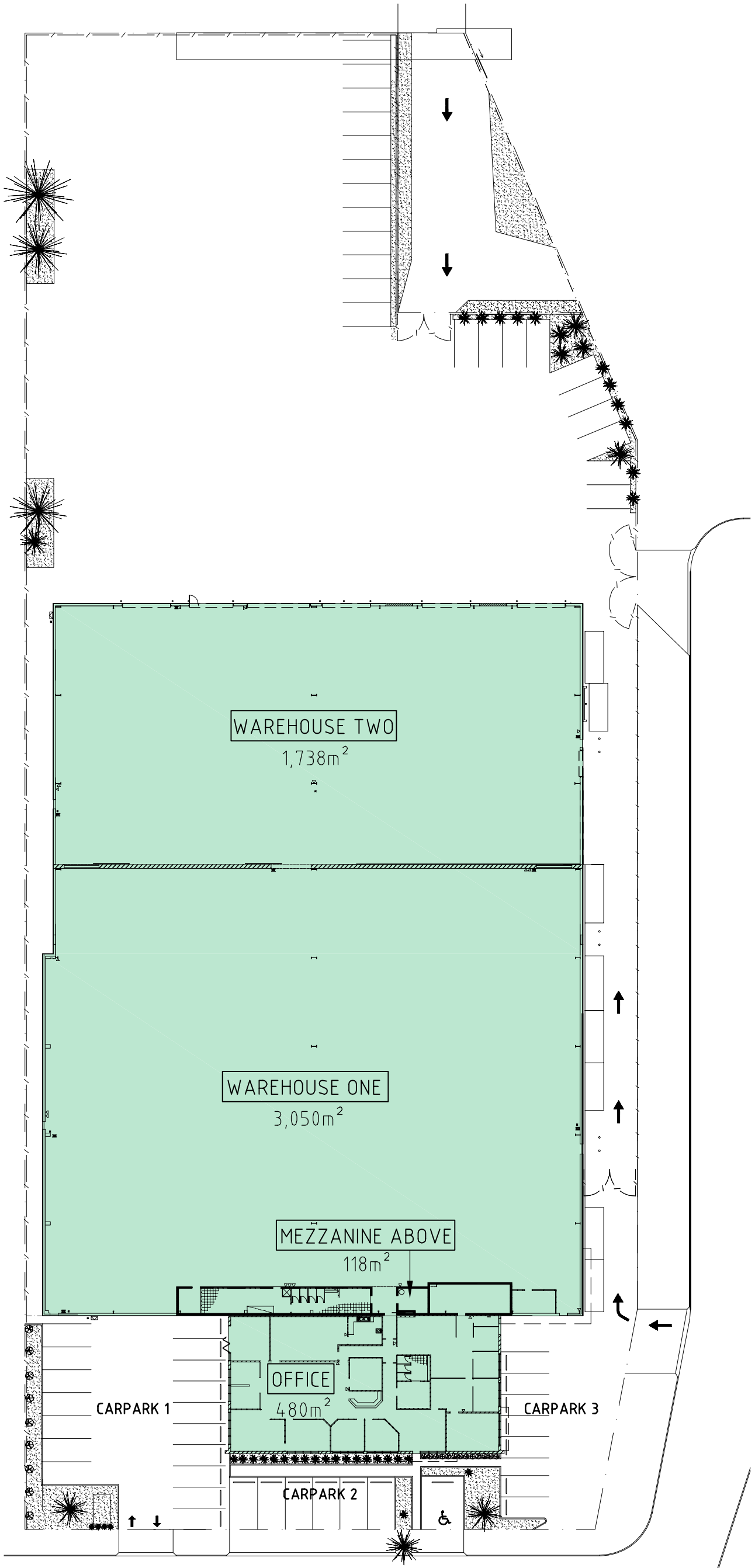

PRELIMINARY DRAWINGS

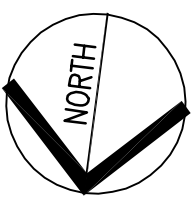

BUILDING AREAS:	
WAREHOUSE ONE:	3,050m ²
WAREHOUSE TWO:	1,738m ²
MEZZANINE:	118m ²
TOTAL WAREHOUSE:	4,906m ²
EXISTING OFFICE	480m ²

16.6.2017 'B' Warehouse, and office areas amended as per client requests.
 15.6.2017 'A' Warehouse, mezzanine and office areas shown as per client requests.



TIR CONSULTING
 Building Design | Construction | Project Management
 Ph: (08) 8410 7377
 Fax: (08) 8410 7388
 Email: info@tirconsulting.com.au

Level 2, 12 - 24 Gilles Street,
 Adelaide South Australia 5000
www.tirconsulting.com.au
 ACH993 500 591 | BLD 106 100
 Since 1984

CLIENT
 RICHARD PAGLIARO

PROJECT
 Residential | Commercial | Industrial
 OFFICE/WAREHOUSE AT
 No.21 OXENHAM STREET,
 DUDLEY PARK. S.A.

TITLE
 PROPOSED OFFICE WAREHOUSE
 REFURBISHMENT SITE PLANS
 "OPTION 1"

SCALES	DRAWN
1:500 UN.O.	SS
DATE	JOB NO.
© JAN.2016	13006
	SIZE
	A3
	REV.
	B

13006 PL1 of 5

THESE DESIGNS ARE COPYRIGHT. LEGAL ACTION WILL BE TAKEN AGAINST ANY INFRINGEMENT. IN PART OR IN WHOLE, UNLESS WRITTEN AUTHORITY IS GIVEN BY THE DESIGNER.

CHECK ALL LEVELS & DIMENSIONS ON SITE PRIOR TO COMMENCING ANY WORK. REPORT ANY DISCREPANCIES TO THE DESIGNER IMMEDIATELY. FIGURED DIMENSIONS SHALL TAKE PREFERENCE OVER SCALED DRAWINGS.