

Site Layout Plan
scale 1 : 100

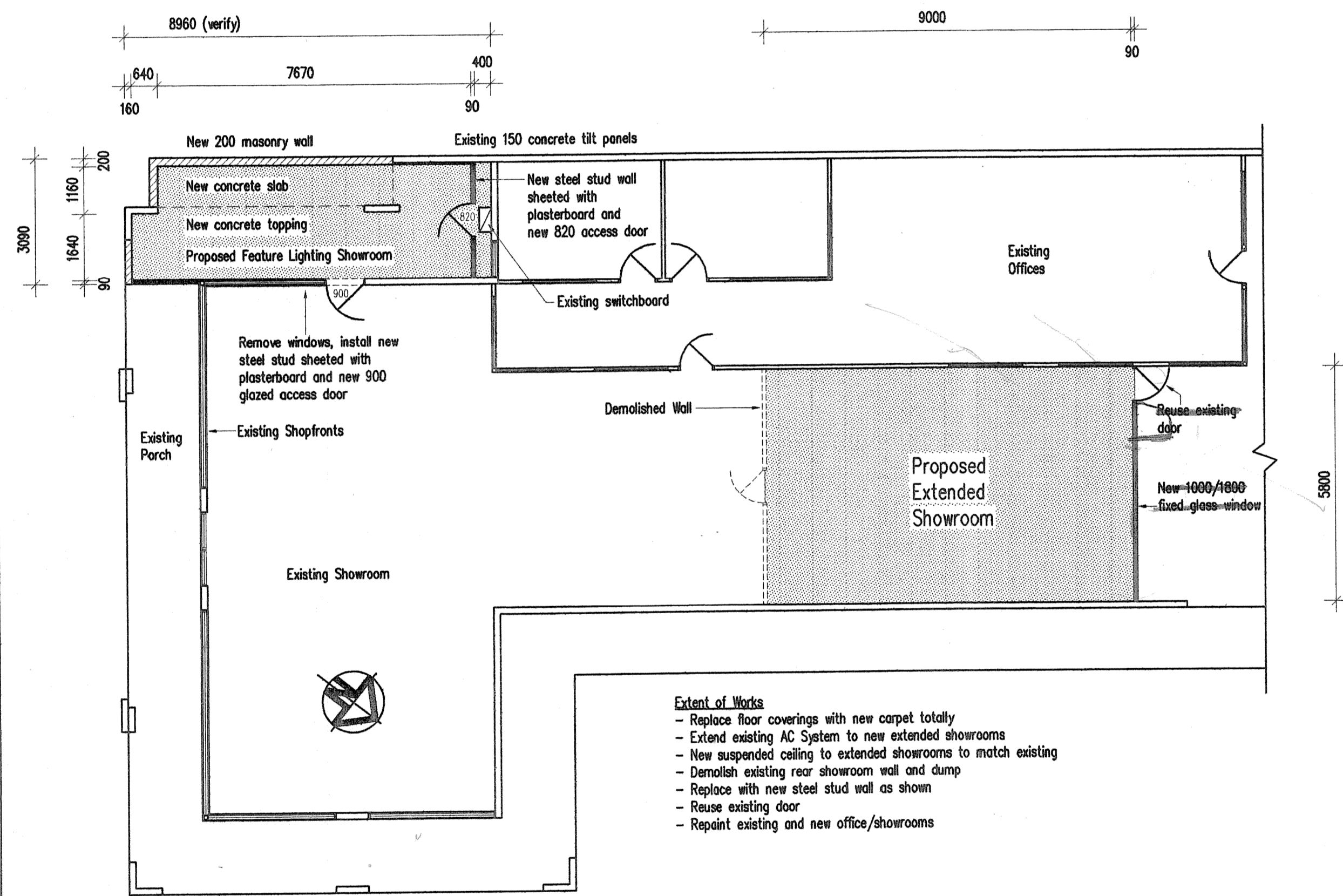

Part Floor Layout Plan - South-East End
scale 1 : 100

- Extent of Works**
- Replace floor coverings with new carpet totally
 - Extend existing AC System to new extended showrooms
 - New suspended ceiling to extended showrooms to match existing
 - Demolish existing rear showroom wall and dump
 - Replace with new steel stud wall as shown
 - Reuse existing door
 - Repaint existing and new office/showrooms

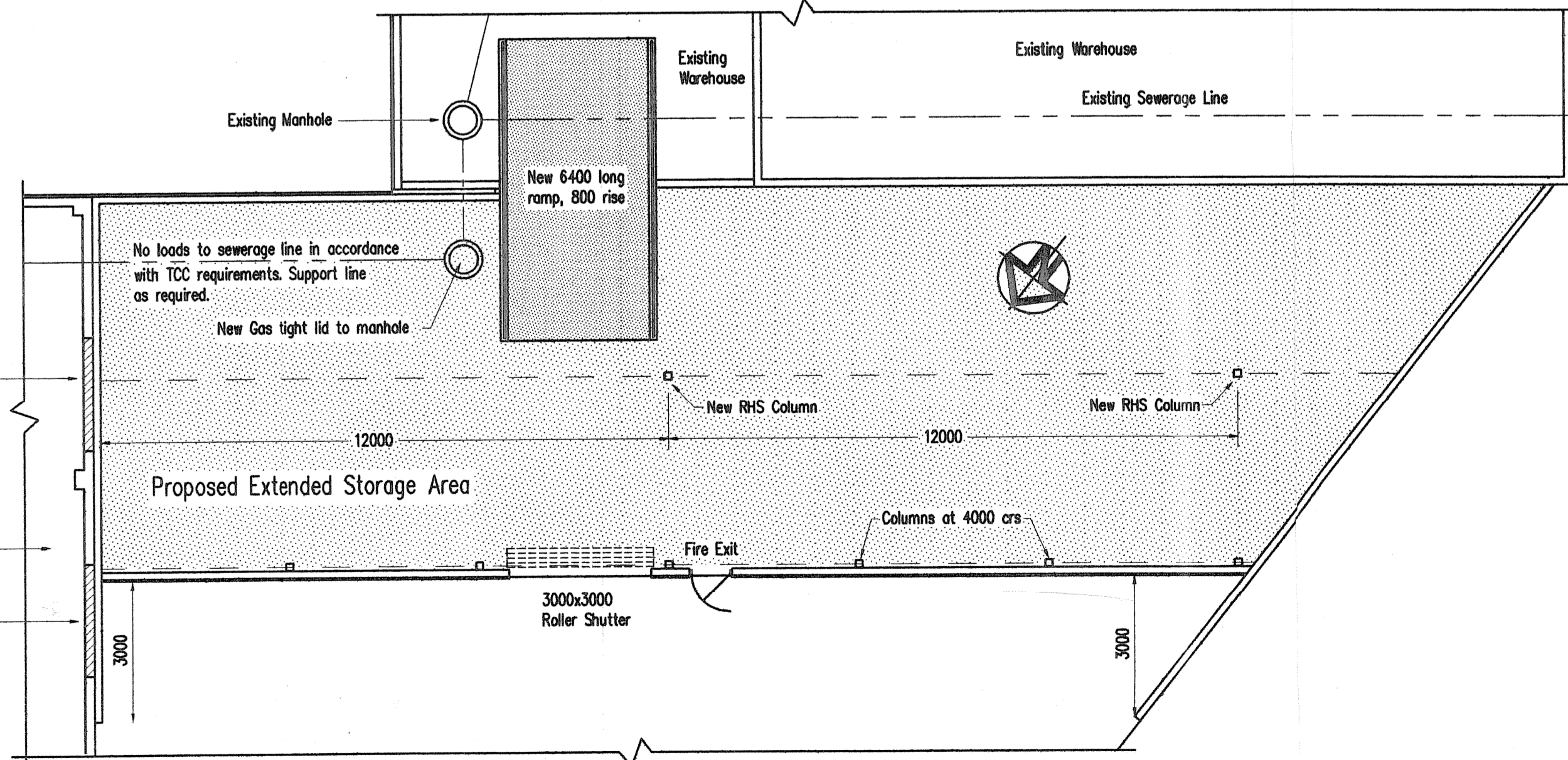

Part Floor Layout Plan - North-West End
scale 1 : 100

Preliminary Drawing
Not For Construction

Builder

Notes

BARRY SWITZER DRAFTING SERVICE
P.O. Box 21 AITKENVALE Q 4814
4 Magnolia Court, ANNANDALE Q 4814
Ph 4775 2504 - Fax 4775 2595
Mobile Ph 0429 - 001 726
Email - barryswitzer@iprimus.com.au

Australian Business Number
ABN - 20 480 678 058

COPYRIGHT ©
Copyright Laws Prohibit the use of this design in any form without written consent from Barry Switzer Drafting Service.
Building Designers Association of Queensland Inc.
MEMBER 2003

Licensed Under The Queensland Building Services Authority (QBSA Act 1991)
Building Design/Drafting - Residential Design/Drafting
Contractor License Number - 021077

Verify all dimensions on site before commencing any Building Works

PROJECT NO. 892 - F1 Revision A

Client
Cannon Park Pty Ltd
Project
Extensions/Alterations to Warehouse Location
239 Dairyple Road, Garbutt Q 4814

Scale 1 : 200, 100	Drawn B. J. Switzer
Date September 2003	Sheet No. 1 A - A1