

Making space for greatness

Goodman

Space for:

high expectations

FORESTRIDGE BUSINESS PARK
14 AQUATIC DRIVE, FRENCHS FOREST, NSW

Opportunity

Ideally located between Sydney's Northern Beaches, Chatswood and the North Shore, Forestridge Business Park offers the opportunity to provide a better work-life balance for you and your staff.

Forestridge Business Park is conveniently located between Aquatic Drive and Warringah Road in Frenchs Forest. Office space is available for lease at competitive rates, making it a must-see space for properties in this area.





Smart move

Private vehicle

Conveniently located between Aquatic Drive and Warringah Road in Frenchs Forest, about 600 metres from Allambie Road. Forestridge Business Park is only a short distance from Brookvale, the Northern Beaches and Chatswood. It is also less than 20 kilometres from the Sydney CBD.

Buses

There are nine bus routes that run past the property linking to Chatswood, the Sydney CBD, Northern Beaches and Warringah Mall.



CENTRALLY CONNECTED



200M
to nearest
bus



200M
to swimming
pool



1.3KM
to gym



5.1KM
to Warringah
Mall



10KM
to Chatswood



Modern workspace

- + High quality office spaces from 206–3,394 sqm
- + Range of office suites (including whole floors with atrium feature)
- + Some include a fitout with fixed partitioned offices and workstations while others are refurbished, open-plan style and ready for customer fitout
- + Local amenities include ATM, gourmet café, post office and aquatic centre. A Virgin Active gym is located 1.3 kilometres away
- + Dedicated car parking provided with a ratio of 1:33
- + 4.5-star NABERS energy rating.



GROUND FLOOR PLAN

AREA SCHEDULE	SQM
Unit	
Building 1 – Suite G.01	210
Building 4 – Suite G.01	493

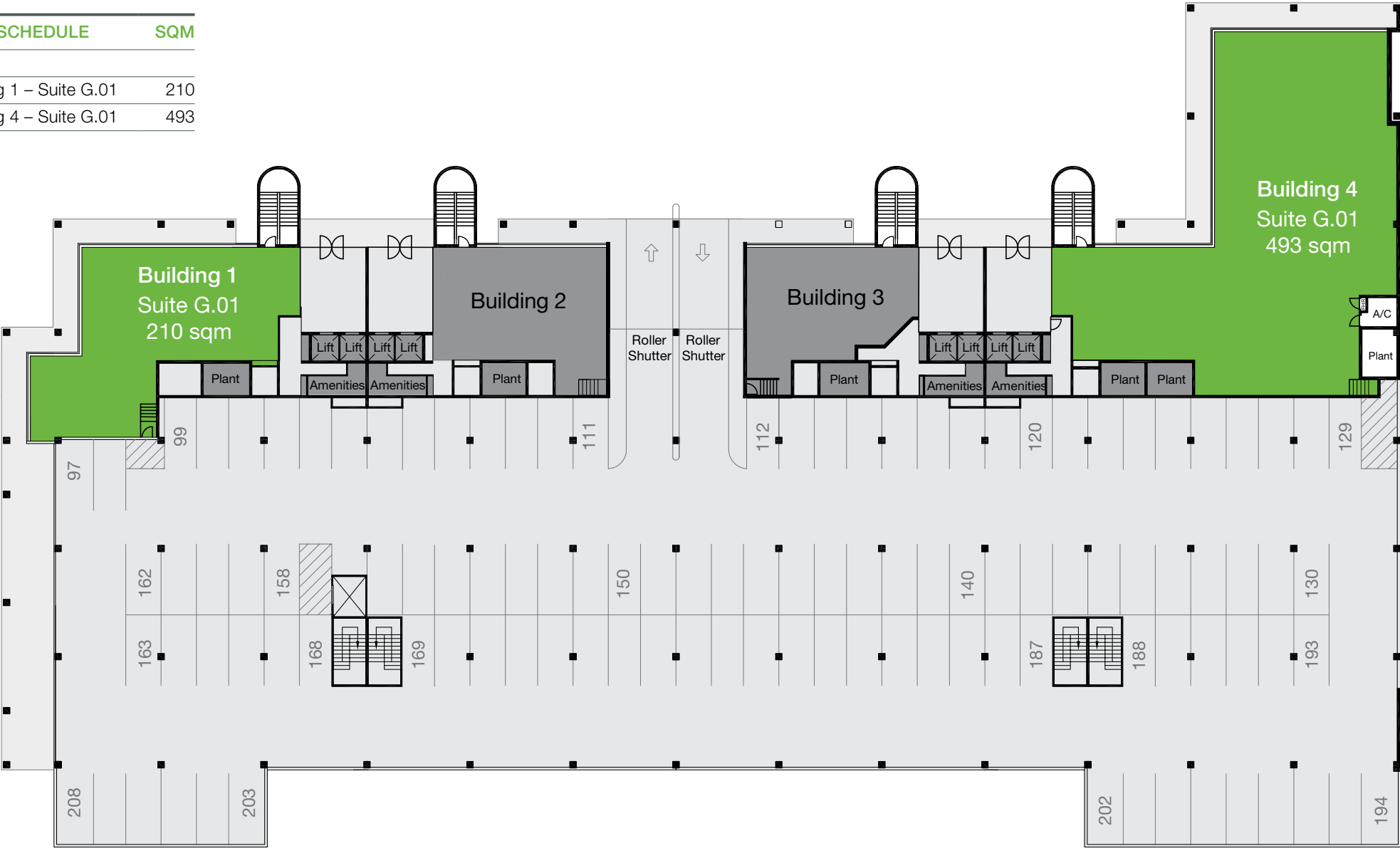

AREA SCHEDULE	SQM
Unit	
Building 1 – Suite 1.01	336
Building 2 – Suite 1.01	830
Building 4 – Suite 1.01	553.4
Building 4 – Suite 1.02	206



AREA SCHEDULE	SQM
Unit	
Building 1 – Suite 3.01	449
Building 2, 3 & 4 – Level 3	970–3,394

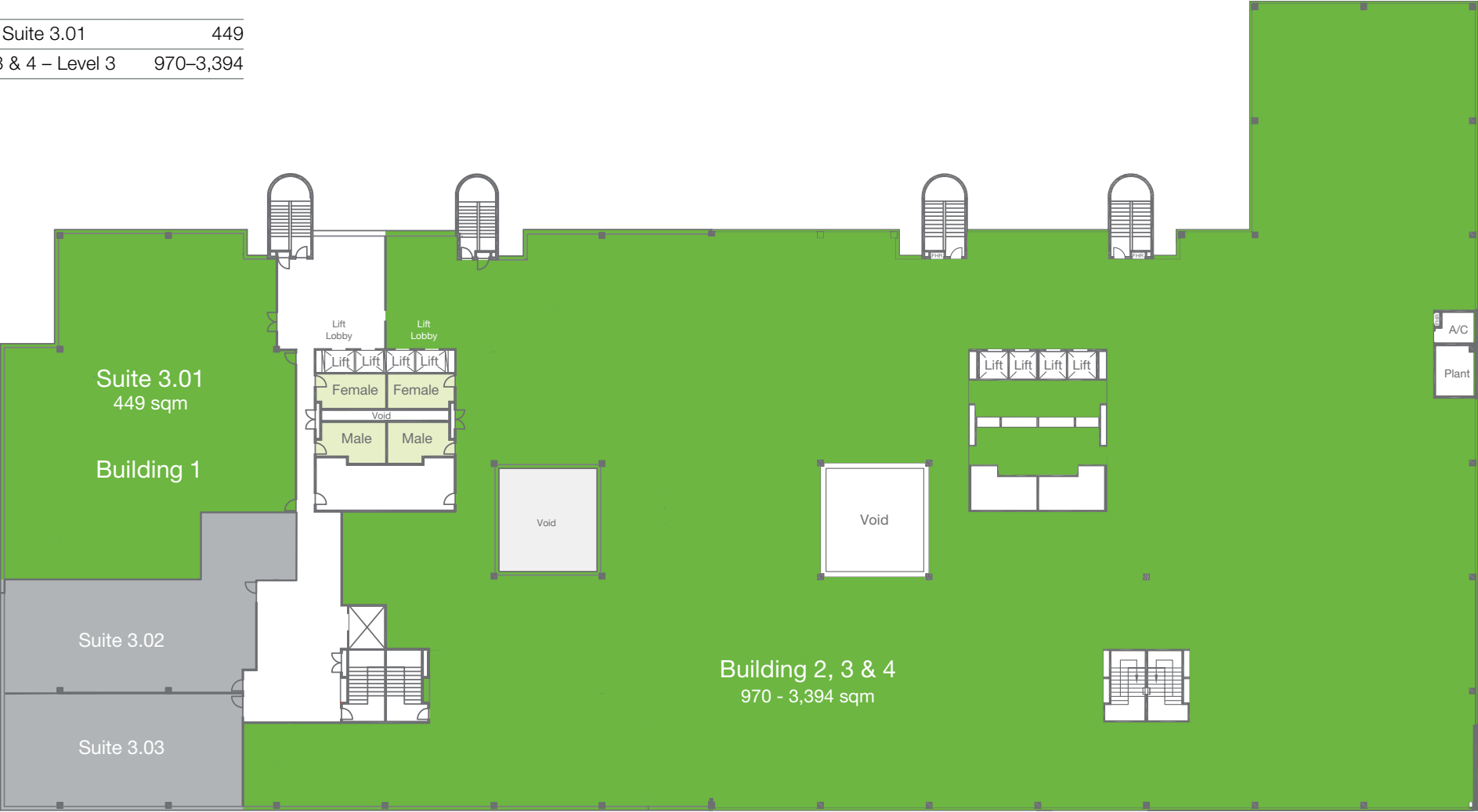

Customer focus

Dedicated Building Managers provide on-site support for day-to-day operations, while Property and Asset Managers are available to discuss leasing, administration or modifications to tenancies.

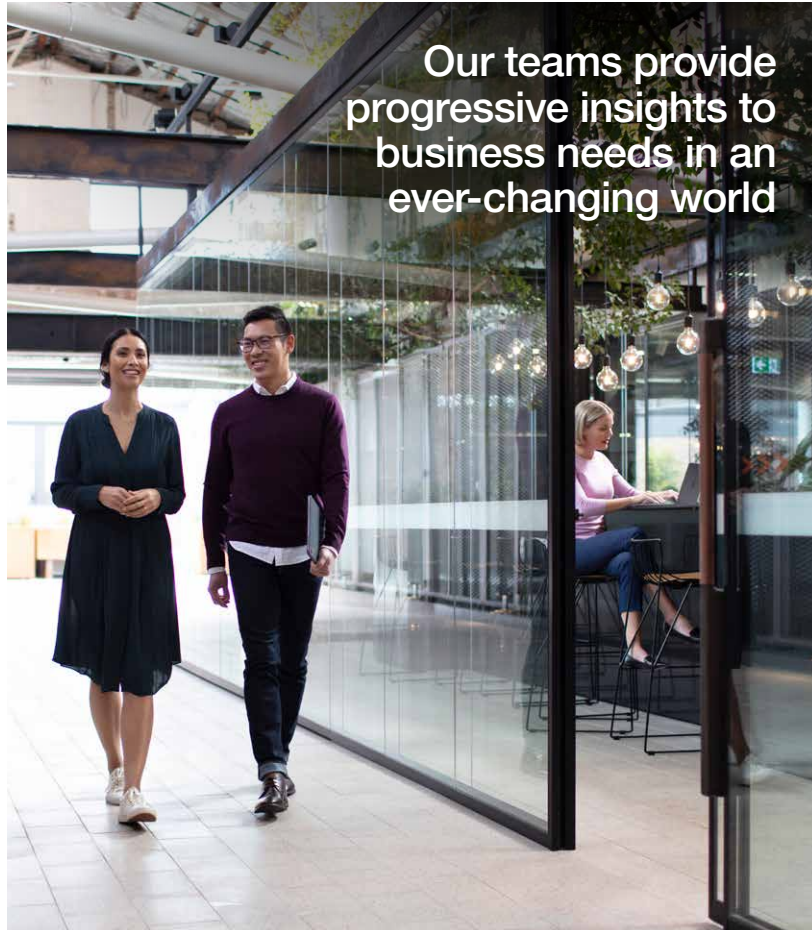

Our teams provide progressive insights to business needs in an ever-changing world



Service

Our in-house property services teams attend to customers' operational needs and provide unparalleled maintenance and presentation standards.



Contact

**Renee Cullen**

Senior Asset Manager

T 02 9230 7431

M 0404 587 955

renee.cullen@goodman.com

Matthew Hamilton

Senior Portfolio Manager

T 02 9230 7329

M 0409 047 762

matthew.hamilton@goodman.com

Goodman

The Hayesbery

1-11 Hayes Road

Rosebery NSW 2018

T 02 9230 7400

[View this property online](#)

goodman.com/au



This document has been prepared by Goodman Property Services (Aust) Pty Ltd ABN 40 088 981 793 for general information purposes only. Whilst every care has been taken in relation to its accuracy, no warranty of accuracy is given or implied. You should obtain your own independent advice before making any decisions about the property referred to in this document. Images contained in this document have been used to enable the customer to visualise the development concepts only, and are not intended to definitively represent the final product. November 2021