

YAMANTO CENTRAL

NOW LEASING

OPENING MID 2021

JOIN **coles** **Kmart**
AND 50 SPECIALTY STORES



488 WARWICK ROAD, YAMANTO, QLD

FAST FACTS



COLES, KMART
& 50 speciality stores



20,000M²
total GLA



950 CAR PARKS
(750 undercover)



MARKET CENTRAL
1750m² fresh food
market hall precinct



CENTRAL EATS
a licensed indoor/outdoor
dining & entertainment precinct



5.4% ANNUAL
POPULATION GROWTH
in the main trade area
3x national average



\$974M IN
RETAIL SPEND
by 2032 (7.8%pa)



54,000+ UNDER
SERVICED CONSUMERS
in the main trade area

WHERE IS YAMANTO CENTRAL?



Yamanto Central is a next-generation sub-regional shopping centre situated in a fast growing region. A celebration of local independent and national retailers, Yamanto Central is 35km from inner-city Brisbane, and 5km south of the Ipswich CBD. It is phase 1 of the planned 22.5ha Yamanto

Town Centre. The nearby Amberley RAAF Base has 7,000+ service personnel which contributes to the significantly higher median household income when compared to the wider Ipswich area.

KEY DEMOGRAPHICS

AGE DISTRIBUTION

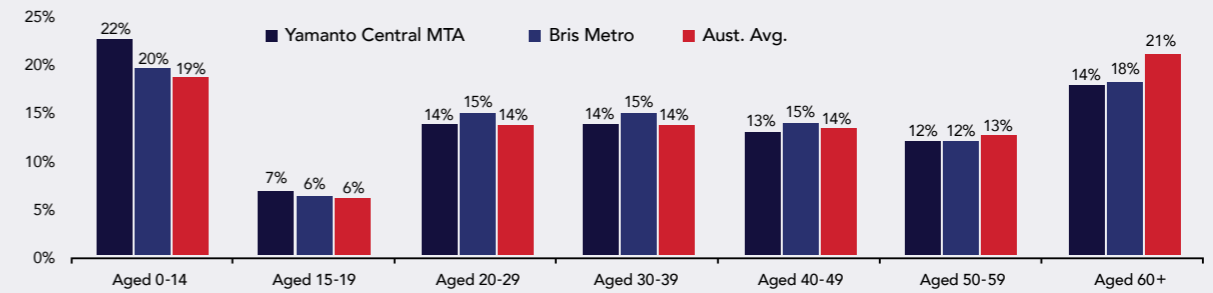

COUNTRY OF BIRTH

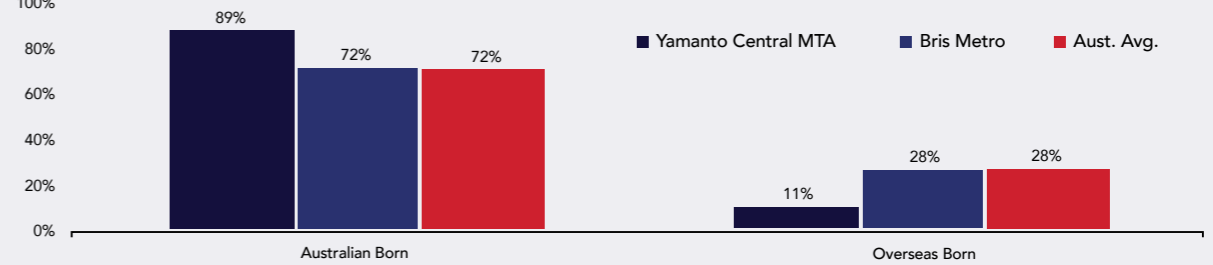

FAMILY TYPE

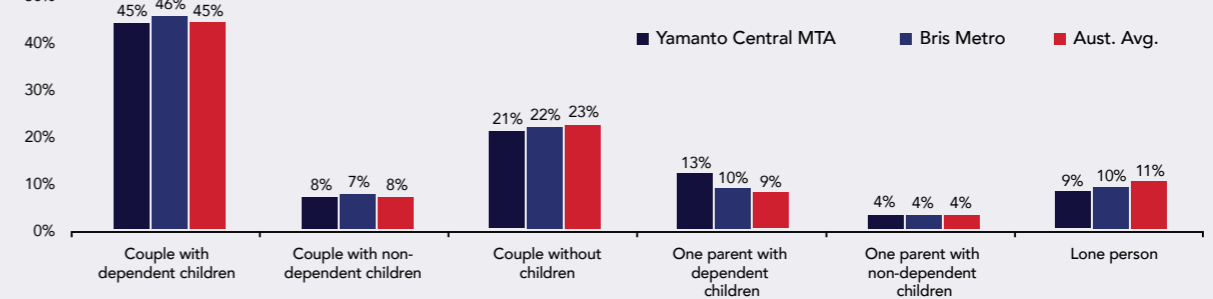

Source: ABS Census or Population & Housing, 2016; MacroPlan Dimasi

MEDIAN HOUSEHOLD INCOME

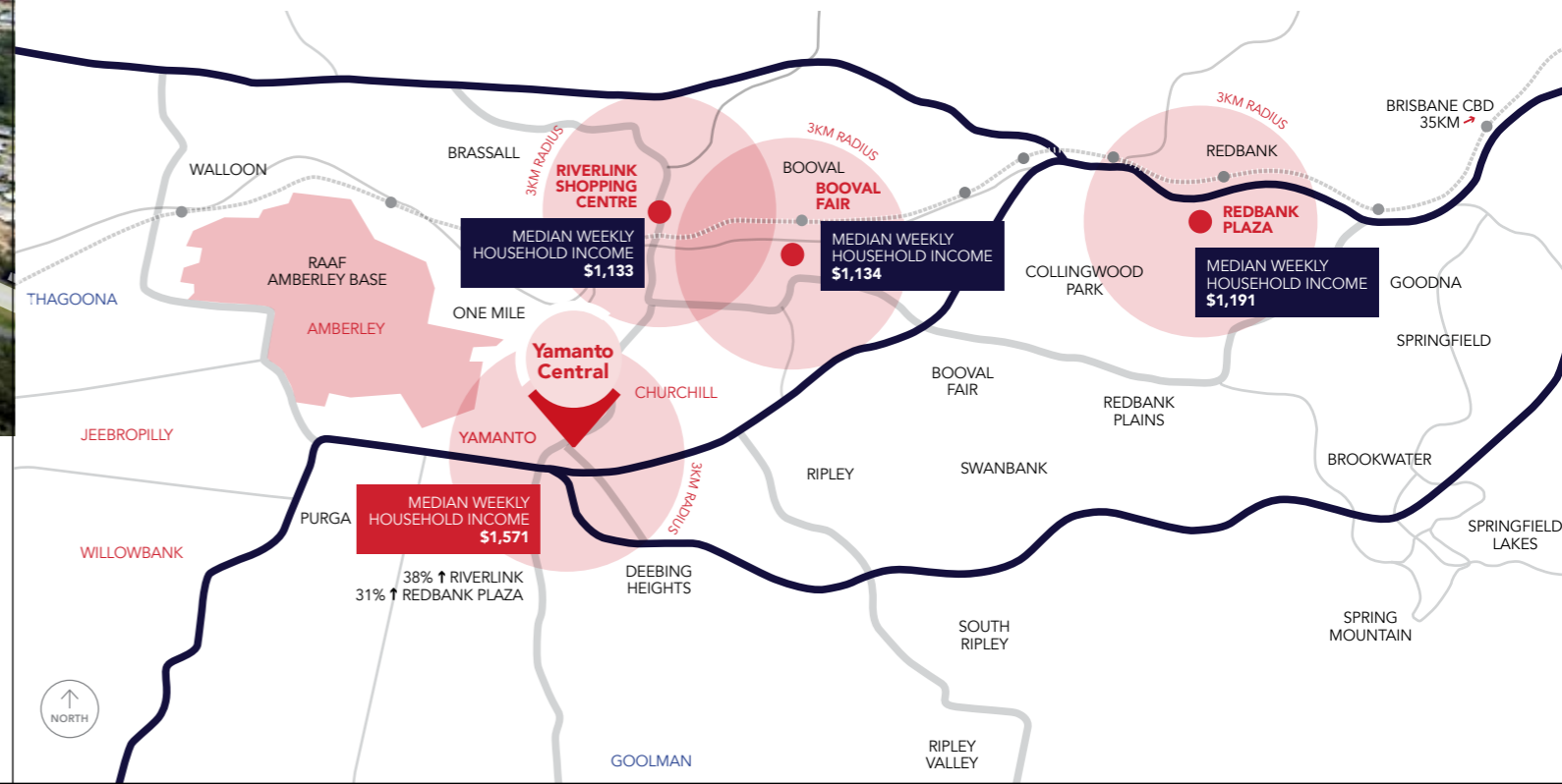

CENTRE PLAN

L1
LEVEL ONE

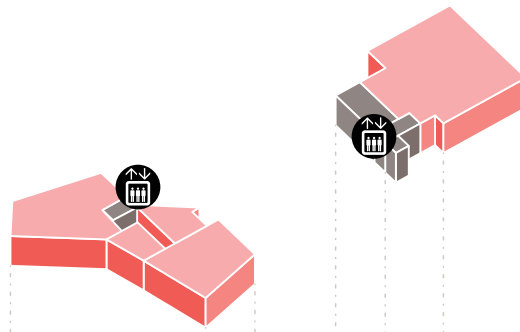

G
GROUND LEVEL

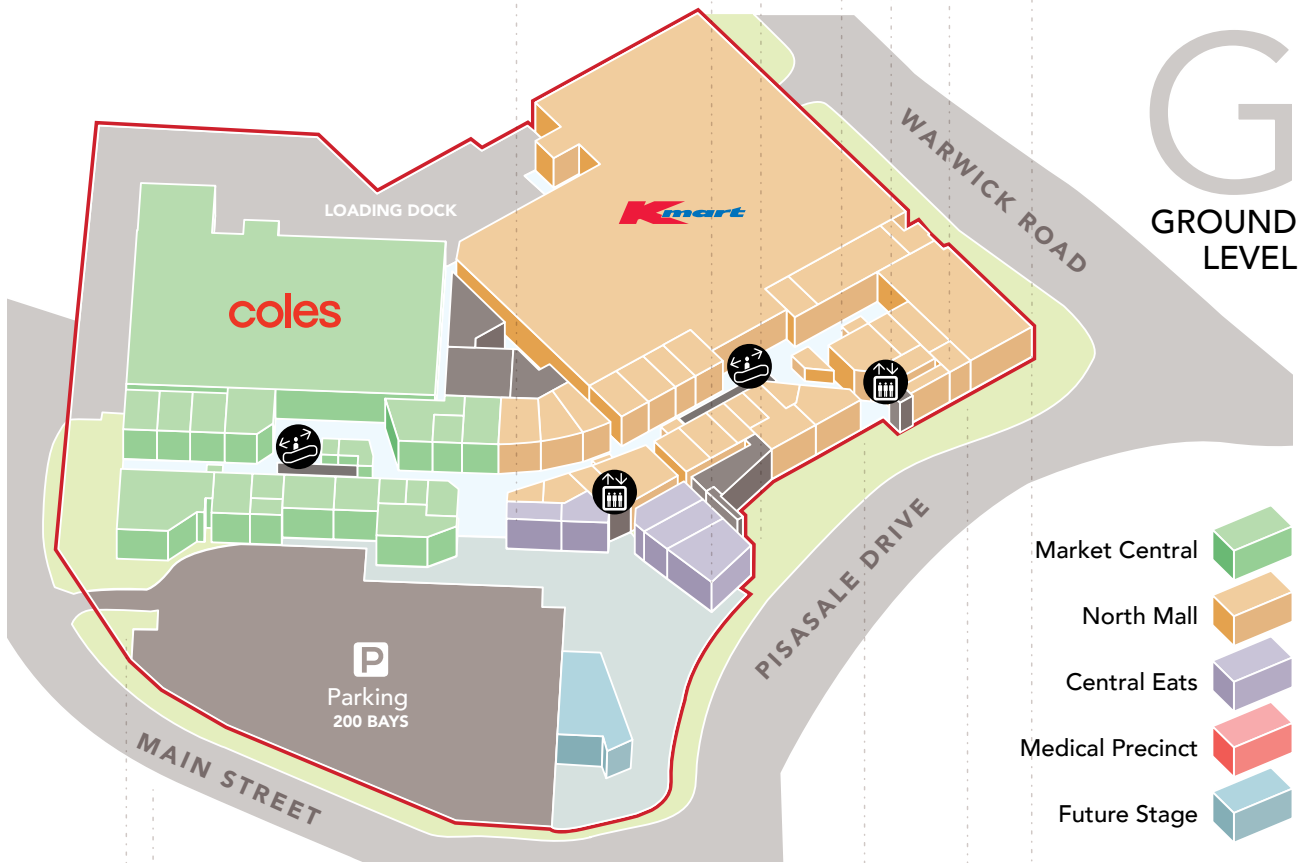

- Market Central
- North Mall
- Central Eats
- Medical Precinct
- Future Stage

750 Basement Car Parks

Indoor Recreation & Swim School

Lift Access to all levels

Travelator

B
BASEMENT LEVEL

For all leasing enquiries, contact:

Chris McLaren | 0452 288 484 | chrism@comac.com.au
 Michael Haddrick | 0411 468 660 | michaelh@comac.com.au

yamantocentral.com.au



Disclaimer: Yamanto Central Shopping Centre or agent gives no warranty as to the accuracy of the information provided in this brochure which is subject to change and does not accept any liability for any error or discrepancy in that information. Parties should make their own enquiries in relation to any information provided. While Yamanto Central Shopping Centre has prepared various plans and other information with respect to the Centre they do not constitute a promise or representation on the part of Yamanto Central Shopping Centre or the agent.