

COUNCIL'S CERTIFICATE
PARRAMATTA CITY COUNCIL (Name of Council)

having satisfied itself that the requirements of the Strata Schemes (Freehold Development) Act, 1973 and Strata Schemes (Leasehold Development) Act, 1986 have been complied with, approves of the proposed:

- Strata plan
- Strata plan of subdivision

illustrated in the annexure to this certificate.

~~The strata plan/strata plan of subdivision is part of a development scheme. The council is satisfied that the plan is consistent with any conditions of any development consent and that the plan gives effect to the stage of the strata development contract to which it relates.~~

~~The Council does not object to the encroachment of the building beyond alignment of the.....~~

~~This approval is given on the condition that the use of lot(s)..... (being utility lot/s designed to be used primarily for the storage or accommodation of boats, motor vehicles or goods and not for human occupation as a residence, office, shop or the like) is restricted to the proprietor or proprietor of a lot or proposed lot (not being such a utility lot) the subject of the strata scheme concerned, as referred to in section 39 of the Strata Schemes (Freehold Development) Act, 1973 or section 39 of the Strata Schemes (Leasehold Development) Act, 1986.~~

Date: 22 January 2001
Subdivision No: DP803347
Council Manager/Authorised Person: [Signature]

Signatures, seals and statements of intention to create easements, restrictions on the use of land or positive covenants

SURVEYOR'S CERTIFICATE

ROBERT WILLIAM BARKER

DENNY LINKER & CO. DX 630 SYDNEY

a surveyor registered under the Surveyor Act 1929 hereby certify that:

- (1) each applicable requirement of Schedule 1A to Strata Schemes (Freehold Development) Act, 1973 and Schedule 1A to Strata Schemes (Leasehold Development) Act, 1986 has been complied with.
- (2) the building encroaches on land (other than a public street) in respect of which encroachment on appropriate easement has been created by registered plan of subdivision.
- (3) the survey information recorded in any accompanying location plan is accurate.

Signature: R.W. Barker.
Date: 6.12.2000

This is sheet 1 of my Plan in 7 sheets

- Delete if inapplicable
- + State whether dealing or plan, and quote registered number

PLAN OF SUBDIVISION OF LOT 3 D. P. 803347

L.G.A. : PARRAMATTA Locality : CLYDE

Parish : LIBERTY PLAINS County : CUMBERLAND

Reduction Ratio: 1: Lengths are in metres 

Name of, and *address for service of notices on, the body corporation

THE OWNERS
STRATA PLAN No. 64725
No. 13 BERRY STREET
CLYDE 2142

SP64725

Registered:  (3.2.2001)

CA: SEE CERTIFICATE

Purpose: STRATA PLAN

Ref Map: U 0052-72#

Last Plan: DP803347

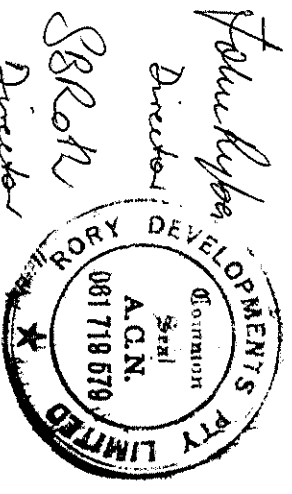

INDUSTRIAL

(Insert type being adopted) Model By-laws adopted for this scheme

Keeping of Animals - Option A/B/C

Schedule of By-laws - sheets filed with plan

No By-laws apply

Strike out whichever is inapplicable

FOR LOCATION PLAN SEE SHEET 2

SURVEYOR'S REFERENCE : 990512 SP

Plan Drawing only to appear in this space

Plan Drawing only to appear in this space

LOCATION PLAN

SP64725

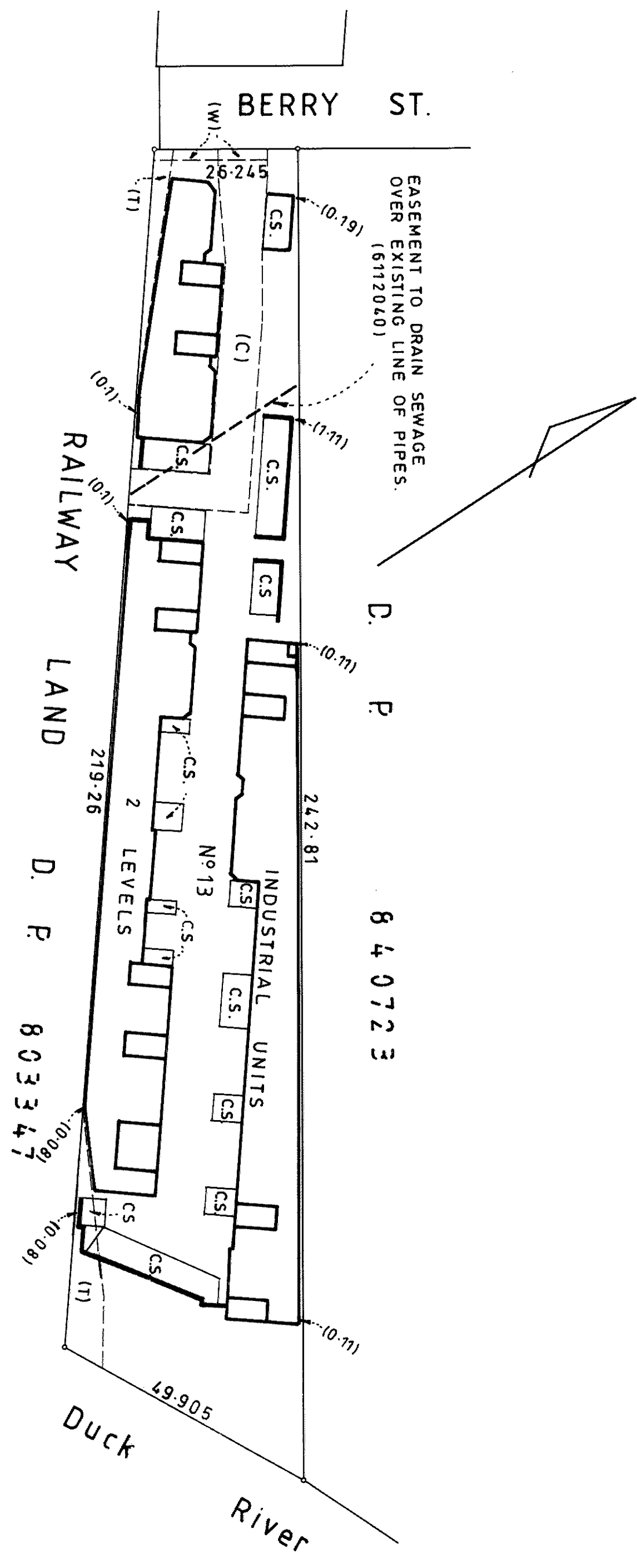

- (T) EASEMENT FOR TRANSMISSION LINE. (6112040)
- (C) RIGHT OF CARRIAGEWAY 6.5-7.5 WIDE & VARIABLE. (7385163)
- (W) EASEMENT FOR WATER SUPPLY 2 WIDE. (7385163)

C.S. - CAR SPACES

Reduction Ratio 1 : 800

Lengths are in metres



R.W. Barber
 Surveyor Registered under Surveyors Act 1929

W. Smith
 General Manager/Authorized Person

SURVEYOR'S REFERENCE : 990512 SP

STRATA PLAN SP64725

SCHEDULE OF UNIT ENTITLEMENTS

LOT N ^o	U.E.	LOT N ^o	U.E.
1	26	18	28
2	23	19	24
3	35	20	25
4	36	21	23
5 & 6	28 EACH	22	27
7	39	23	38
8	38	24	29
9	29	25	38
10	37	26	26
11	29	27	29
12	31	28	26
13	23	29	37
14	26	30	27
15	23	31 & 32	35 EACH
16	27	33	51
17	24	AGGREGATE	1000

NOTE: MEASUREMENTS OF FLOOR AREA SHOWN ARE APPROXIMATE AND ARE CALCULATED FOR THE PURPOSE OF THE STRATA SCHEMES (FREEHOLD DEVELOPMENT) ACT 1973 ONLY. THESE AREAS MAY DIFFER FROM MEASUREMENTS OF FLOOR AREA FOR OTHER PURPOSES.

THE STRATUM OF THE CAR SPACES IS RESTRICTED TO 2.5 METRES ABOVE THE UPPER SURFACE OF THE CONCRETE SLAB THEREOF.

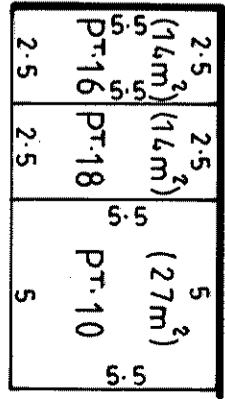
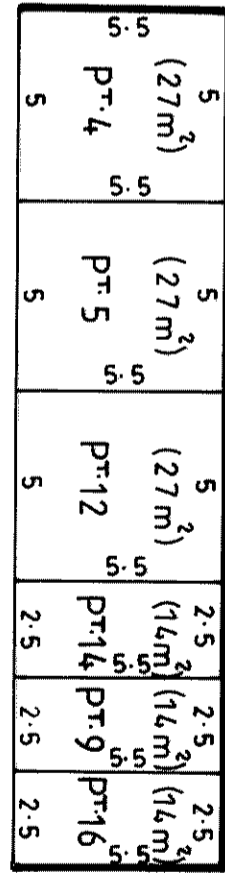
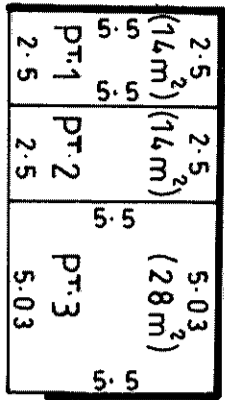

COMMON

PROPERTY

ADJOINS

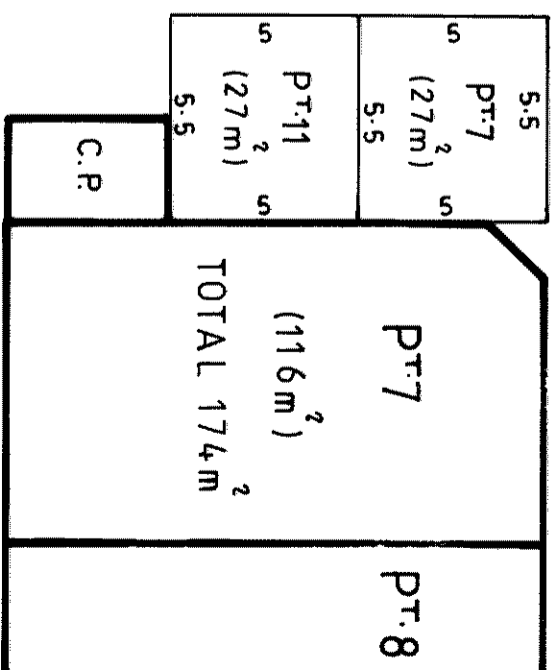
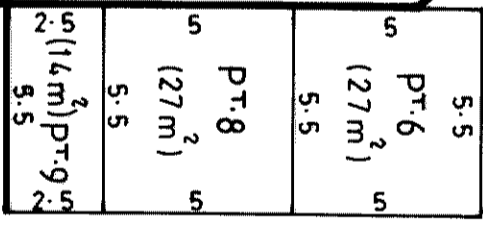
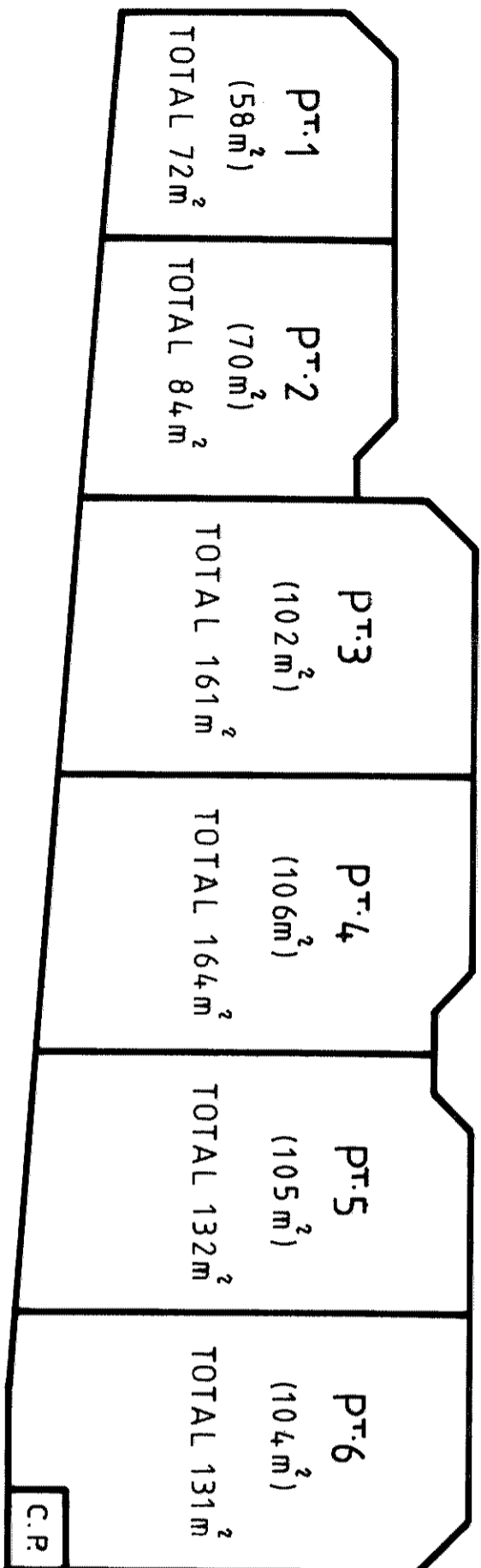

LEVEL 1

C.P. - COMMON PROPERTY

SHEET 4

Reduction Ratio 1 : 200

Lengths are in metres



R.W. Barber
Surveyor Registered under Surveyors Act 1929

R. Bennett
General Manager/Authorised Person

NOTE: MEASUREMENTS OF FLOOR AREA SHOWN ARE APPROXIMATE AND ARE CALCULATED FOR THE PURPOSE OF THE STRATA SCHEMES (FREEHOLD DEVELOPMENT) ACT 1973 ONLY. THESE AREAS MAY DIFFER FROM MEASUREMENTS OF FLOOR AREA FOR OTHER PURPOSES.

THE STRATUM OF THE CARSPACES IS RESTRICTED TO 2.5 METRES ABOVE THE UPPER SURFACE OF THE CONCRETE SLAB THEREOF.

SP64725

COMMON PROPERTY

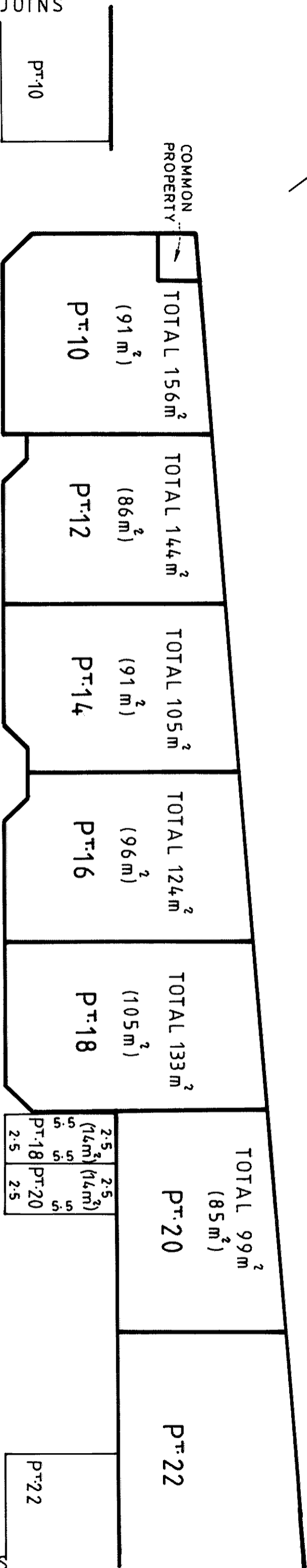

COMMON

PROPERTY

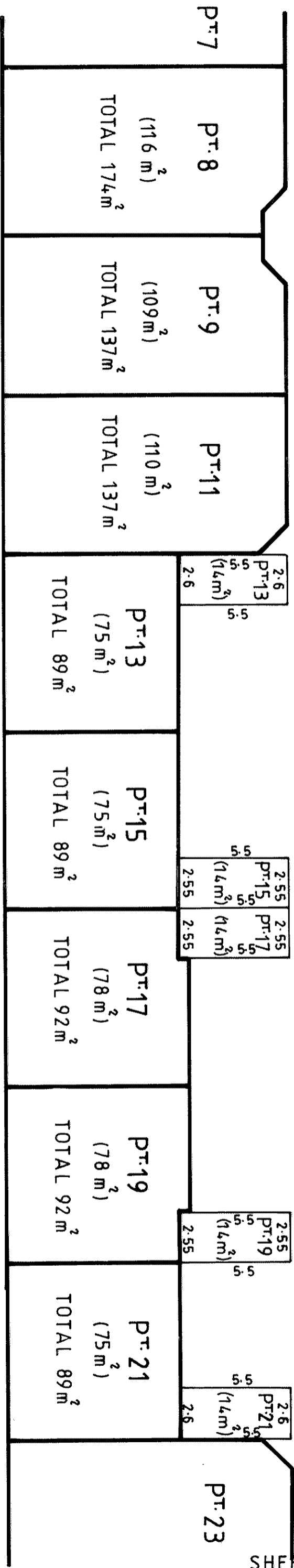

LEVEL 1

Reduction Ratio 1 : 200

Lengths are in metres

R.W. Barker
 Surveyor Registered under Surveyors Act 1929

W. Bennett
 General Manager/Authorised Person

SURVEYOR'S REFERENCE : 990512 SP



*OFFICE USE ONLY

SHEET 3 ADJOINS

SHEET 5 ADJOINS

NOTE: MEASUREMENTS OF FLOOR AREA SHOWN ARE APPROXIMATE AND ARE CALCULATED FOR THE PURPOSE OF THE STRATA SCHEMES (FREEHOLD DEVELOPMENT) ACT 1973 ONLY. THESE AREAS MAY DIFFER FROM MEASUREMENTS OF FLOOR AREA FOR OTHER PURPOSES. THE STRATUM OF THE CARSPACES IS RESTRICTED TO 2.5 METRES ABOVE THE UPPER SURFACE OF THE CONCRETE FLOOR THEREOF.

SP64725

PT.20

TOTAL 109m²
(95m²)

PT.22

TOTAL 121m²
(107m²)

PT.24

TOTAL 104m²
(90m²)

PT.26

TOTAL 107m²
(93m²)

PT.28

TOTAL 112m²
(98m²)

PT.30

TOTAL 161m²
(103m²)

PT.32

TOTAL 242m²
(175m²)

PT.33

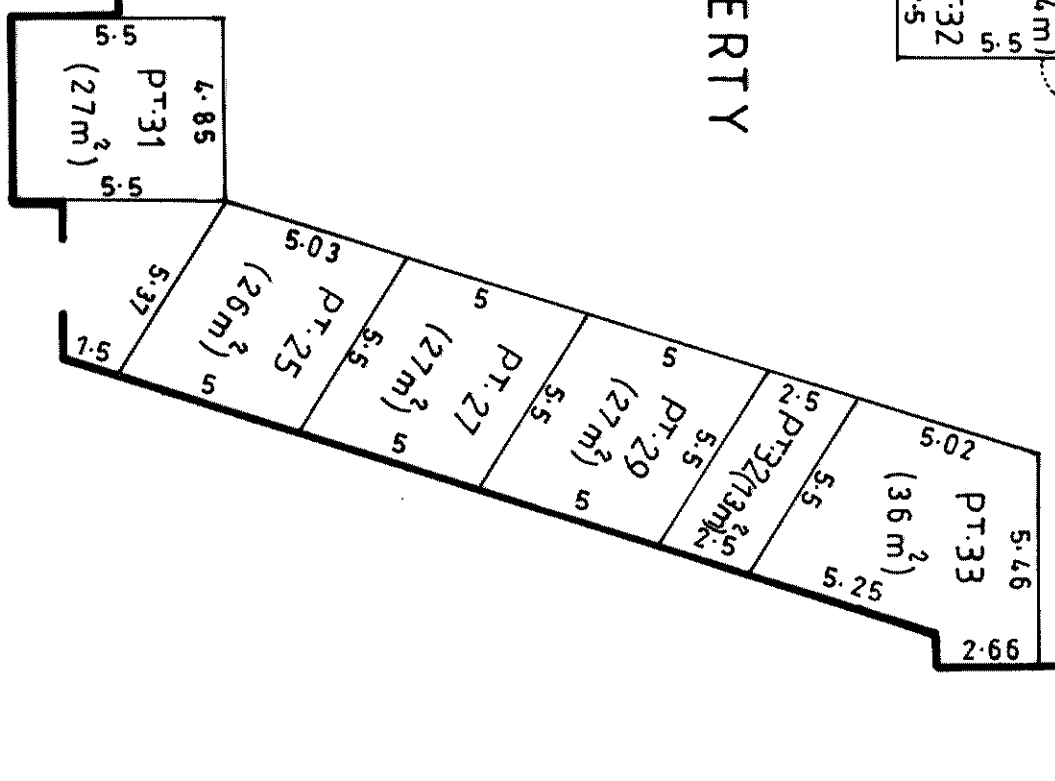
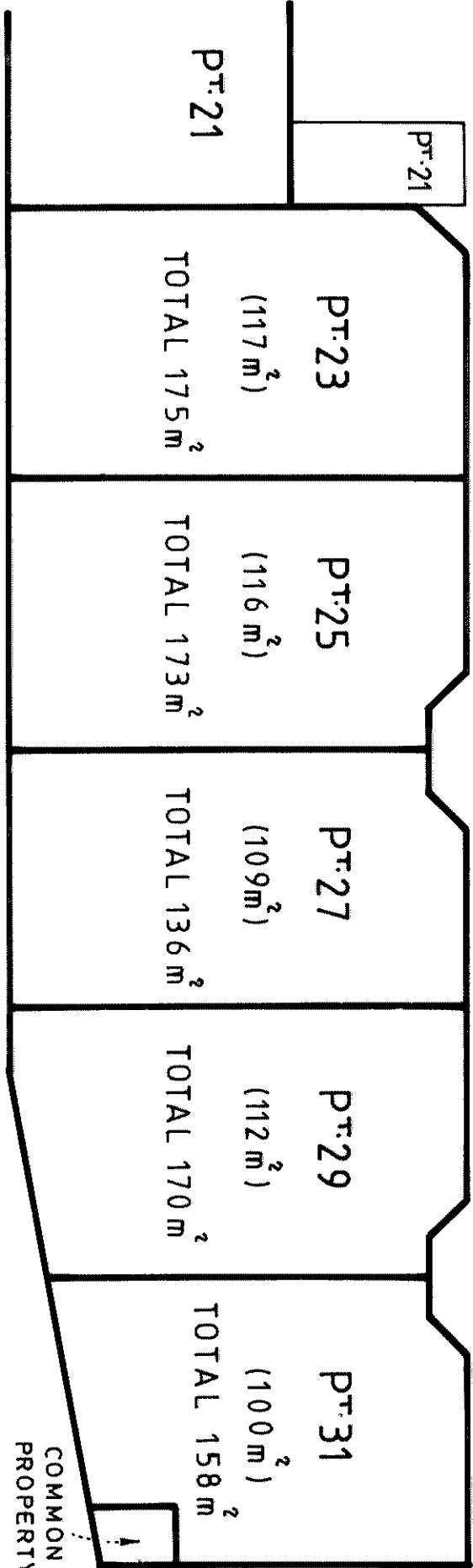
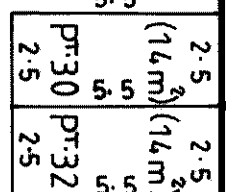
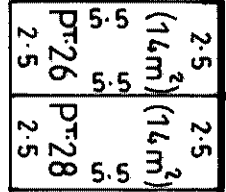
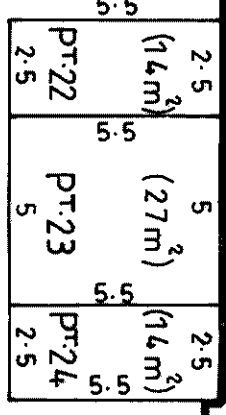

SHEET 4 ADJOINS

COMMON

PROPERTY

LEVEL 1

Reduction Ratio 1 : 200

Lengths are in metres

R.W. Barber
Surveyor Registered under Surveyors Act 1973

General Manager/Authorised Person



WARNING: CREASING OR FOLDING WILL LEAD TO REJECTION

NOTE: MEASUREMENTS OF FLOOR AREA SHOWN ARE APPROXIMATE AND ARE CALCULATED FOR THE PURPOSE OF THE STRATA SCHEMES (FREEHOLD DEVELOPMENT) ACT 1973 ONLY. THESE AREAS MAY DIFFER FROM MEASUREMENTS OF FLOOR AREA FOR OTHER PURPOSES.

SP64725

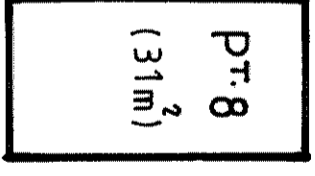
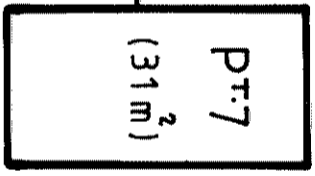
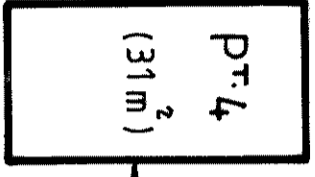
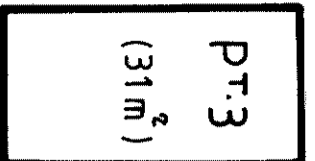
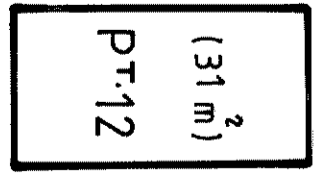
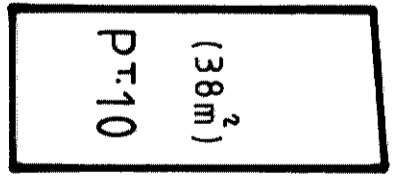
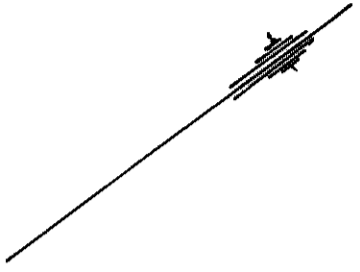

NOT TO SCALE

LEVEL 2

Reduction Ratio 1 : 200

Lengths are in metres



R.W. Barber
Surveyor Registered under Surveyors Act 1929

[Signature]
General Manager/Authorised Person

SURVEYOR'S REFERENCE : 990512 SP

WARNING: CREASING OR FOLDING WILL LEAD TO REJECTION

NOTE: MEASUREMENTS OF FLOOR AREA SHOWN ARE APPROXIMATE AND ARE CALCULATED FOR THE PURPOSE OF THE STRATA SCHEMES (FREEHOLD DEVELOPMENT) ACT 1973 ONLY. THESE AREAS MAY DIFFER FROM MEASUREMENTS OF FLOOR AREA FOR OTHER PURPOSES.

SP64725

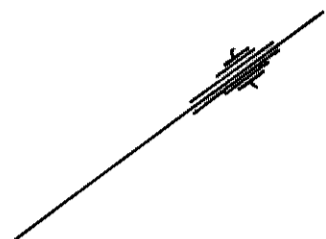

(31 m²)
PT.32

(31 m²)
PT.33

PT.23
(31 m²)

PT.25
(31 m²)

PT.29 (31 m²) PT.31 (31 m²)

LEVEL 2

Reduction Ratio 1 : 200

Lengths are in metres



R.W. Barker
Surveyor Registered under Surveyors Act 1929

[Signature]
General Manager/Authorised Person

SURVEYOR'S REFERENCE : 990512 SP