

FOR LEASE

Shop C1, Promenade West
Circular Quay, Sydney



ABOUT THE LOCATION

Circular Quay epitomises our waterfront city.

Set on Sydney Cove, between Bennelong Point and The Rocks, it accentuates both the Harbour Bridge and Opera House.

Its proximity to both the main artery of George Street, Macquarie Street, and the Circular Quay wharves allows for terrific access to the many tourists, office workers and residents that visit Circular Quay each year. With its proximity to the city and the significance of the precinct, there are few places that allow for this kind of opportunity.

Place Management NSW, a NSW Government agency, is dedicated to activating and growing this area for the benefit of tenants, visitors, and the people of NSW.





LOCATION PLAN

SHOP C1, PROMENADE WEST CIRCULAR QUAY, SYDNEY

An idyllic location in the heart of Circular Quay.



ABOUT THE PROPERTY

SHOP C1, PROMENADE WEST CIRCULAR QUAY, SYDNEY

A highly sought after corner retail location in one of Australia's most iconic precincts, Circular Quay.

Existing Services

- Water supply provided to a location
- Waste point provided to a location. No trade waste.
- 3 phase 63amp EDB

Estimated Site Availability

From 1 July 2026





TENANCY PLAN

SHOP C1, PROMENADE WEST
CIRCULAR QUAY, SYDNEY

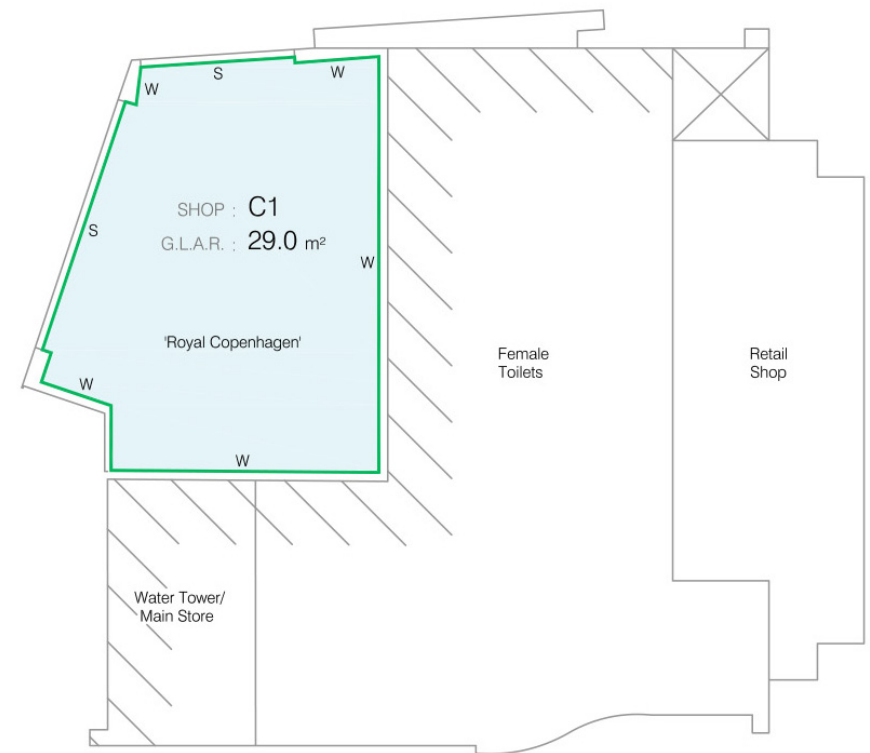

LIKE TO KNOW MORE?

CONTACT US

Patrick Sergi
Retail Leasing Director

M +61 407 923 230
E psergi@unitedpropertyservices.com.au

Submissions close 6 March 2026, 4pm AEDT

