

BICYCLE PARKING AREA DETAIL  
Scale 1:100

NOTE:  
EXTENT OF 2000 x 2500 SIGHT TRIANGLE  
TO BE IN ACCORDANCE WITH AS 2890.2 2002, FIGURE 9.4  
SITE TRIANGLE TO BE KEPT CLEAR OF VISUAL OBSTRUCTIONS.  
ANY LANDSCAPING WITHIN SITE TRIANGLES TO BE MAXIMUM OF  
900mm IN HEIGHT AT MATURE GROWTH LEVEL.

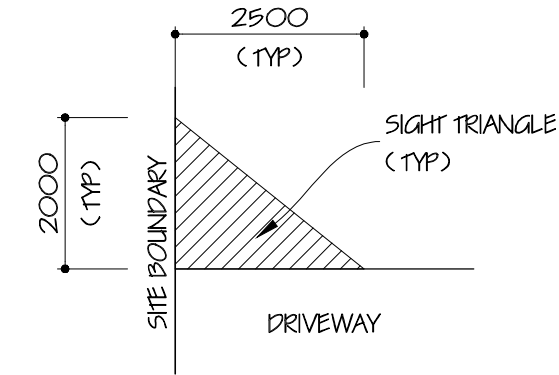

TYPICAL LINE OF SIGHT TRIANGLE DETAIL  
(Scale 1:100)

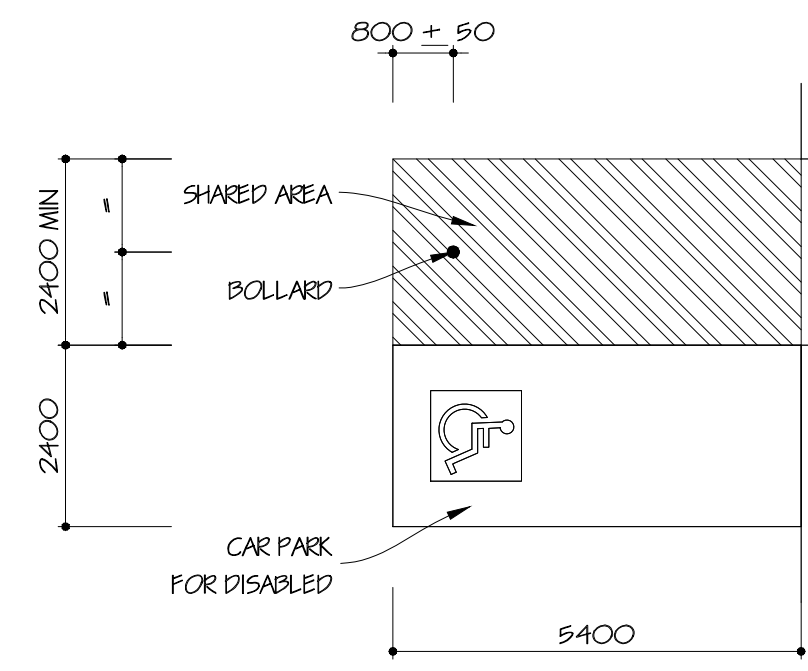

TYPICAL CAR PARK FOR DISABLED DETAIL  
(Scale 1:100)

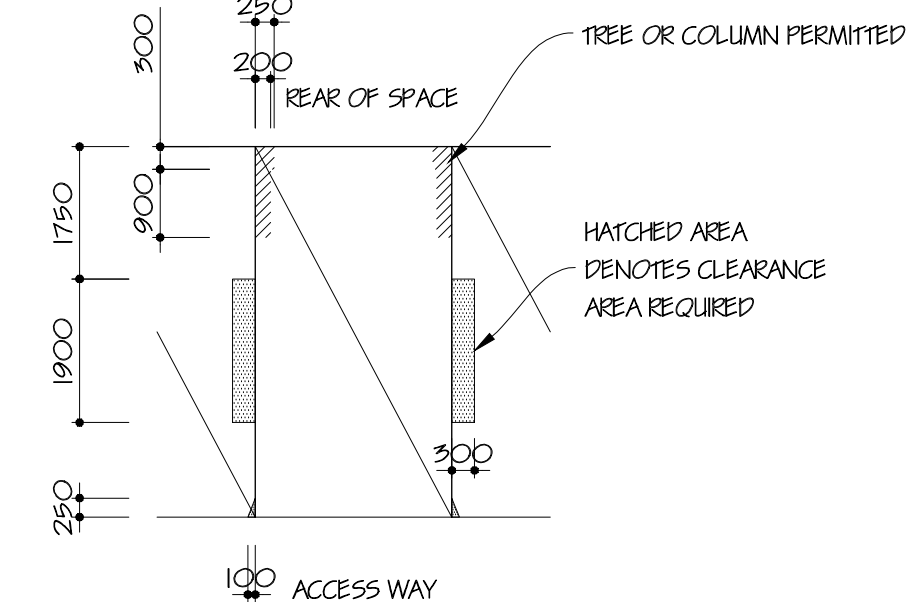

TYPICAL MINIMUM CAR PARK CLEARANCE DETAIL  
(Scale 1:100)

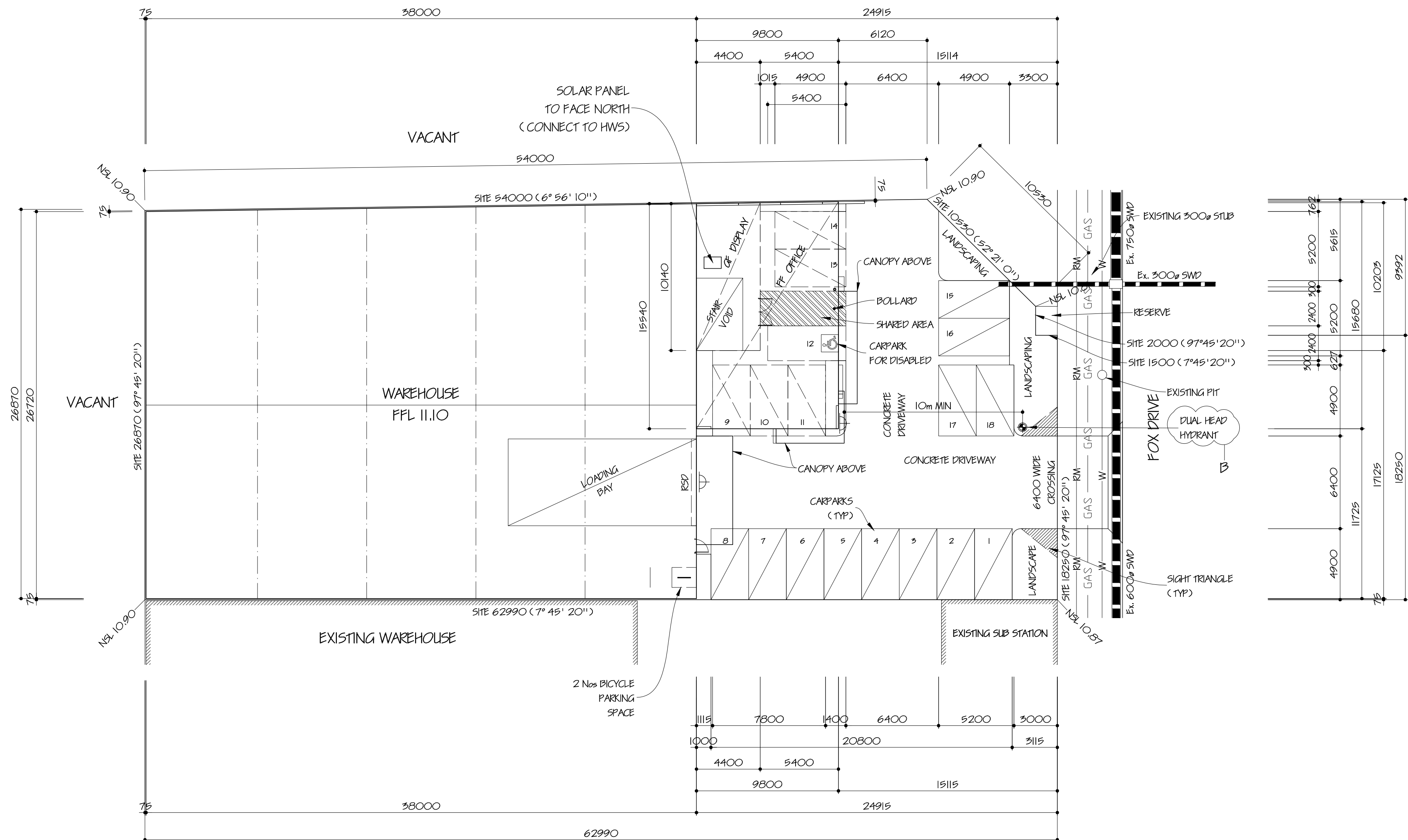

SITE DEVELOPMENT PLAN

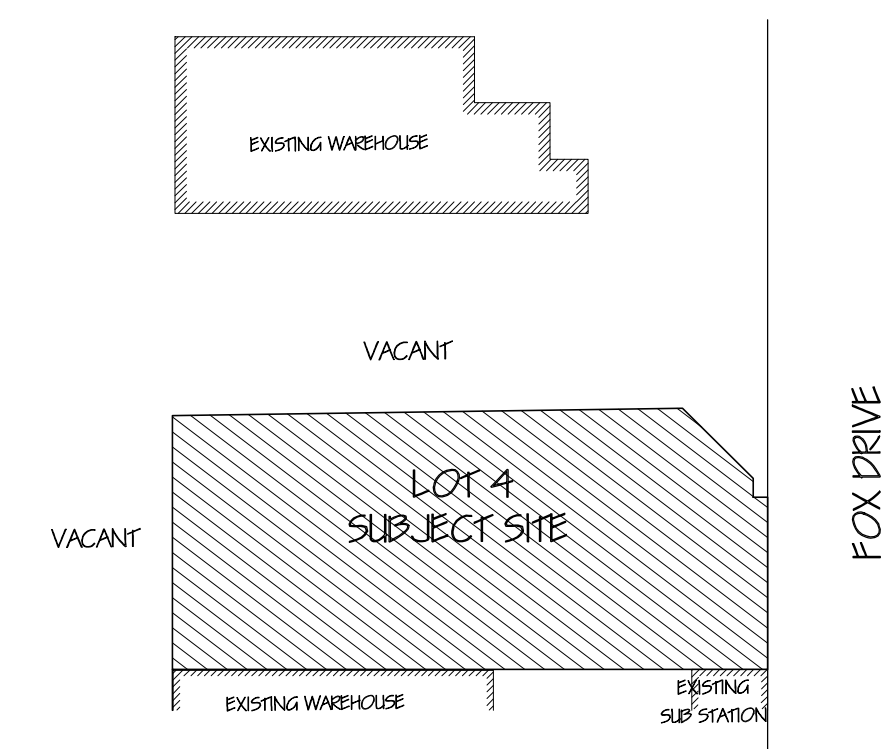

KEY PLAN  
SCALE NTS

BICYCLE PARKING SPACES  
FLAT TOP BICYCLE PARKING SPACE.  
DIMENSIONS AND ACCESS TO BE IN  
ACCORDANCE WITH BICYCLE VICTORIA, THE  
BICYCLE HANDBOOK.  
SIGNAGE FOR BICYCLE PARKING TO  
CONFORM WITH CLAUSE 52.34-5 OF THE  
PLANNING SCHEME

MARKETING AREAS:

SITE AREA:	1679 m <sup>2</sup>
WAREHOUSE:	1026 m <sup>2</sup>
OFF OFFICE:	45 m <sup>2</sup>
PF OFFICE:	153 m <sup>2</sup>
TOTAL:	1224 m <sup>2</sup>
CARPARKS:	18 OFF

- ALL CARPARKS TO BE 2600 W x 4900 L MIN DIMENSIONS AND GRADIENTS TO BE IN ACCORDANCE WITH CLAUSE 52.06 OF THE GREATER DANDENONG PLANNING SCHEME AND AS/ NZS 2890.1 - 2009.
- CARPARKS FOR DISABLED TO BE 2400 W x 5400 L MIN WITH 2400 W SHARED PATHWAY
- ALL LOADING BAYS TO BE MINIMUM 6000 W x 5500 H x 13000 L
- ALL DRIVEWAYS & CARPARKS TO HAVE 150mm THICK REINFORCED CONCRETE
- PATHWAYS TO BE CONCRETE PAVED UNLESS OTHERWISE NOTED
- RAMPS FOR DISABLED TO COMPLY WITH AS 1428.1 - 2009
- ALL LEVELS TO AHD

DISABLED SIGNAGE TO COMPLY WITH BCA D3.6 AND AS 2890.6-2009

EXTENT OF PATHWAY, SHARED AREA AND CIRCULATION SPACE FOR DISABLED

150 WATT METAL HALIDE FLOOD LIGHT TO BE BAFFLED TO LIMIT LIGHT SPILL BEYOND SITE BOUNDARIES

ISSUE FOR CONSTRUCTION

22/01/2021	B	HYDRANT RELOCATED AWAY FROM SUBSTATION
26/11/2020	A	B5 QUERIES - HYDRANT
REVISION		

All levels and dimensions to be checked and verified by the relevant Builder prior to commencement of construction. This Document is Copyright and is supplied on the express condition that it is not to be used for any other purpose or copied or communicated to any other person, without the prior permission of Stephen D'Andrea Pty. Ltd.

**STEPHEN D'ANDREA** PTY. LTD.  
A.C.N. 005 676 568  
SUITE 9 / 84 - 90 LAKEWOOD BOULEVARD  
BRAESIDE 3195  
TELEPHONE 9587 5000  
FAX 9588 2020  
MOBILE (0418) 314 021  
EMAIL design@stephendandrea.com.au  
WEB SITE www.stephendandrea.com.au

PROJECT  
PROPOSED WAREHOUSE & OFFICE  
AT LOT 4 FOX DRIVE,  
DANDENONG SOUTH.

CLIENT

DATE	JUL '20	SCALE	1:200
DRAWN	SM	SHEET	1 OF 11
DRG No	6124/20	ISSUE	B

