





# PREMIUM, AWARD WINNING OFFICE SPACE

A rare opportunity has emerged at Sixty Martin Place for a tenant to lease office space. This is the first time space has been available for direct lease since the building was constructed in 2019.

Sixty Martin Place is a 31-storey premium grade office tower that overlooks the Domain and offers breathtaking views of the East and Sydney Harbour.

Designed by Hassell, the building has been recognized for its innovative and unique architectural design, winning numerous awards for interior design and façade engineering. It also offers a range of premium facilities, allowing it to achieve the coveted WELL Platinum rating.

Deutsche Bank



# WELL CONNECTED

Sixty Martin Place enjoys an unrivalled location with close proximity to major transport connections, landmarks and a spectacular array of retail and dining amenity. Sixty Martin Place is conveniently located at the end of the iconic Martin Place and is within walking distance of Sydney’s attractions including Circular Quay, museums and galleries.

RESTAURANTS

- 01. Rockpool Bar & Grill
- 02. Alfie's
- 03. Balcon by Tapavino
- 04. Brasserie 1930
- 05. Hubert
- 06. Masuya
- 07. Chophouse Sydney
- 08. Aalia
- 09. The Gidley
- 10. Long Chim Sydney
- 11. Ragazzi Wine & Pasta
- 12. Clam Bar

RETAIL

- 13. Chifley Plaza
- 14. Giorgio Armani
- 15. Farage
- 16. Tiffany & Co
- 17. Pitt Street Mall
- 18. Westfield Sydney
- 19. The Strand Arcade

HOTELS

- 20. Sofitel Sydney
- 21. Capella Sydney
- 22. Radisson Blu
- 23. Tank Stream Hotel
- 24. The Fullerton Hotel

FITNESS

- 25. Barry's Bootcamp
- 26. F45 Training
- 27. Anytime Fitness
- 28. Fitness First The Zone
- 29. Virgin Active on Bligh
- 30. Virgin Active on Pitt

CAFES & BARS

- 31. Mordeo
- 32. The Library Bar
- 33. Toppi's
- 34. Avenue on Chiefly
- 35. The Naked Duck
- 36. Caffeine Cartel
- 37. Cabana Bar
- 38. Barrio Cellar
- 39. The Carter Sydney
- 40. Bowery Lane
- 41. Verandah Bar
- 42. Toby's Estate

CULTURE & RECREATION

- 43. State Library Of NSW
- 44. Art Gallery of NSW
- 45. Museum of Sydney
- 46. Theatre Royal Sydney

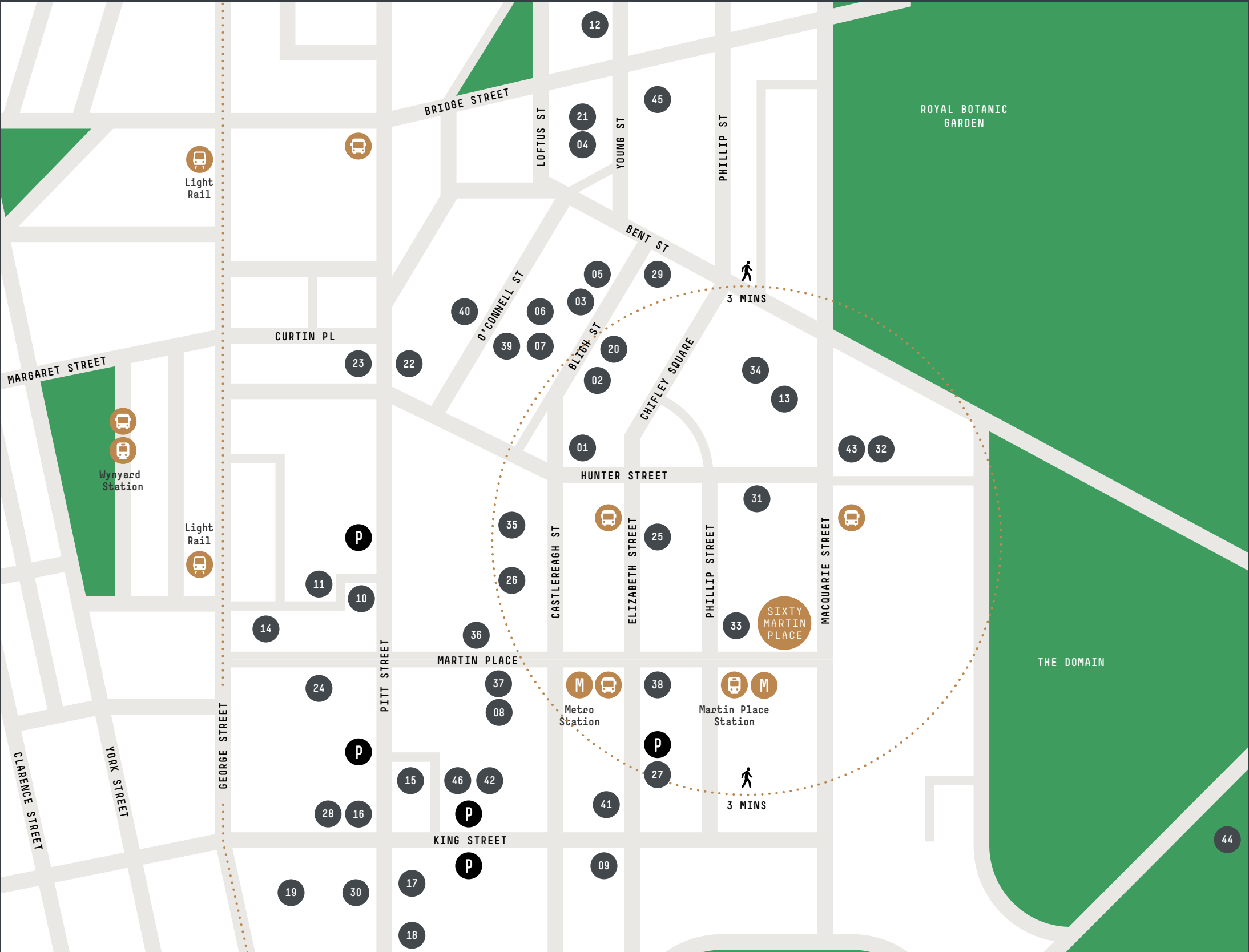

# THE OPPORTUNITY

## LEVEL 19, SUITE 19.01

Total NLA	644 sqm
Reception	1
Workstations	32
Boardroom (24p)	1
Meeting Room (6p)	2
Quiet Room	3
Kitchen Breakout	1
Collaboration Areas	1

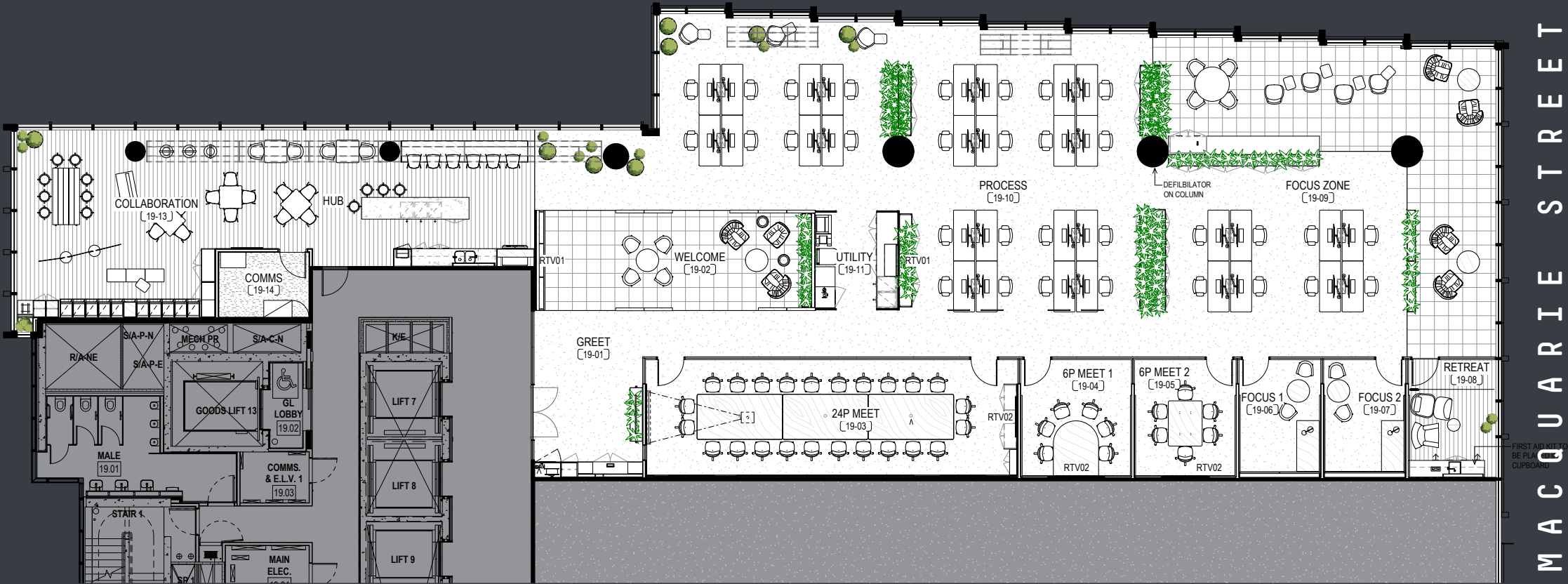

# THE OPPORTUNITY

## LEVEL 22, SUITE 22.01

Total NLA	958sqm
Density	1:12
Reception	1
Workstations	78
Executive Office	2
Quiet Room	6
6 pax Meeting Room	5
8 pax Meeting Room	2
Kitchen Area	2
8 pax Collaboration	1
20 pax Boardroom	1



MACQUARIE STREET

MARTIN PLACE

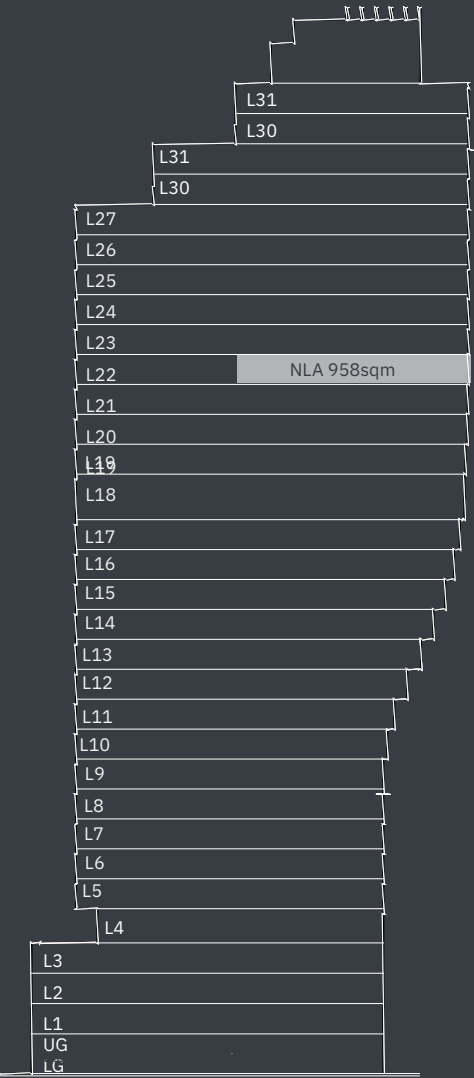



# THE OPPORTUNITY

## LEVEL 24

Total NLA	1,504 sqm
Workstations	108
Meeting Rooms (3p)	17
Boardroom (14p)	2
Meeting Room (10p)	1
Meeting Room (8p)	1
Meeting Room (6p)	1
Focus Room (1p)	10
Kitchen Breakout	1
Collaboration Areas	3

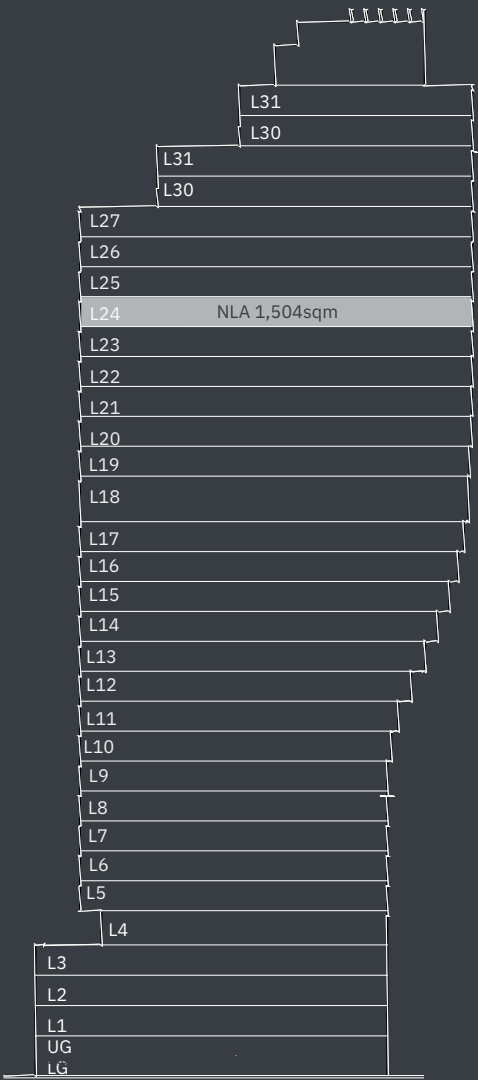

MARTIN PLACE





# SUSTAINABILITY AT 60 MARTIN PLACE

- ✓ 5-STAR NABERS ENERGY
- ✓ 6 STAR NABERS ENERGY WITH GREENPOWER
- ✓ 4.5-STAR NABERS WATER
- ✓ WELL PLATINUM RATED
- ✓ WELL EQUITY RATED
- ✓ WELL HEALTH AND SAFETY RATED
- ✓ 3 STAR PERFORMANCE V1.2
- ✓ 6 STAR DESIGN AND AS BUILT v1 2020





# INVESTA ESG

Investa is transforming tomorrow with measurable social and environmental impacts through our investments, sustainable building practices and commitment to inclusivity and wellbeing. We are continually striving to improve and innovate on our strong ESG performance.

As part of our strategy, we regularly measure and provide metrics on the performance of our ESG initiatives against our social, environmental and financial benchmarks.

- ✓ 4 STAGE PATHWAY TO NET ZERO
- ✓ 100% GREEN DEBT
- ✓ WELL CONCEPT LEADERSHIP AWARD - MATERIALS (ICPF & IGO)
- ✓ WELL CONCEPT LEADERSHIP AWARD - COMMUNITY (ICPF & IGO)





# MARKETPLACE

## GET IN TOUCH



**Mark Podgornik**  
Investa  
+61 400 763 389  
[MPodgornik@investa.com.au](mailto:MPodgornik@investa.com.au)



**Alex Allan**  
Investa  
+61 432 298 099  
[AAllan@investa.com.au](mailto:AAllan@investa.com.au)

Disclaimer: Investa Property Group and its Agents take no responsibility for any errors or omissions or discrepancies, if any, in this document which have been compiled from information supplied to us by various sources and are subject to withdrawal without notice. All maps, plans and areas are approximate and are given as guidance only. This document is for marketing purposes only. Interested parties/prospective tenants should make their own independent assessment and enquiries before entering into any transaction. This document is subject to copyright. Information as at May 2024 unless otherwise stated, and is subject to change.