

# LEVEL 3 - TENANCY (65M<sup>2</sup> - 836M<sup>2</sup>)

## FITOUT PLAN

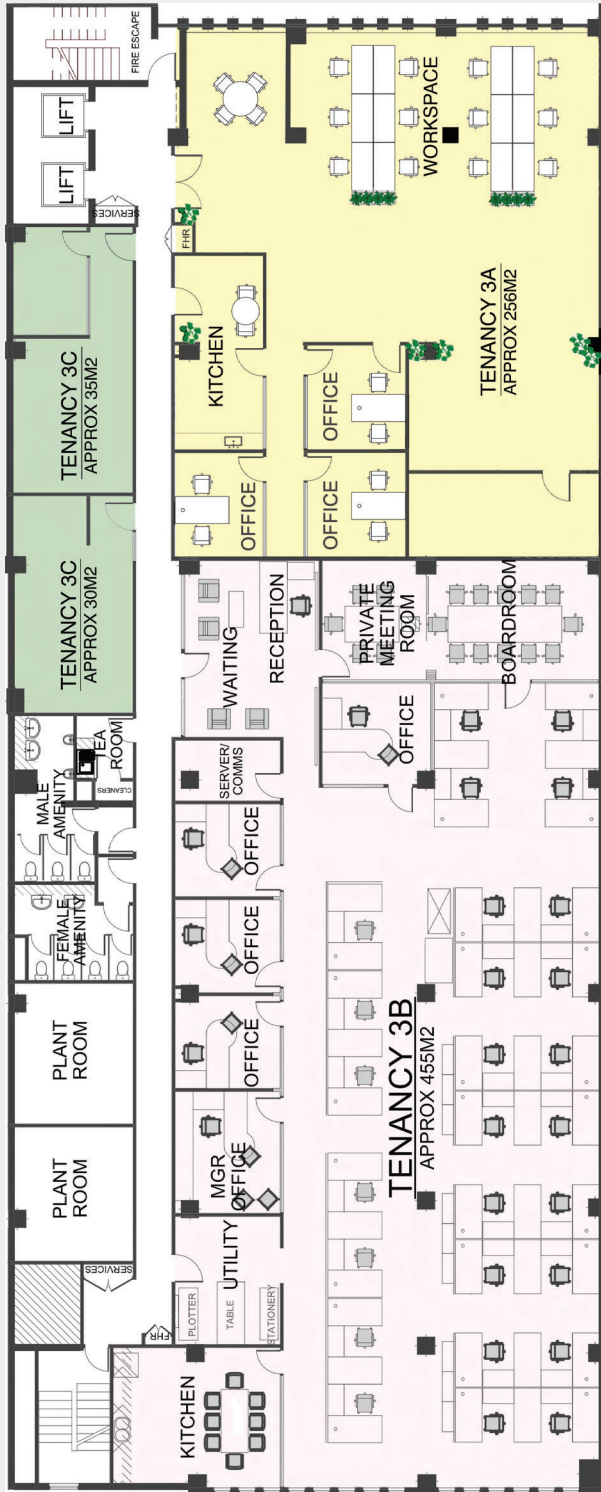

- TENANCY 3A - APPROX 256M2
- TENANCY 3B - APPROX 455M2
- TENANCY 3C - APPROX 30M2
- TENANCY 3C - APPROX 35M2

No responsibility is accepted by Sentinel Property Group (SPG), the Landlord, or their representatives for the accuracy of any information contained herein or for any action taken in reliance thereon. Prospective tenants should make their own enquiries to satisfy themselves on all aspects. Details contained herein do not constitute any representation by SPG, the Landlord, or by the agent and are excluded from any contract or agreement. A number of the statements are based on information and research published by others. The parties have not confirmed and the parties do not warrant the accuracy of completeness of such statements. Past performance is not a reliable indicator of future performance. Rights are reserved to change the tenancy mix for that shown or described in this brochure. The parties do not warrant the accuracy of the information in this brochure and to the maximum extent permitted by law, disclaim responsibility of any loss or damages of any nature whatsoever which may be suffered by any person directly or indirectly through relying upon it, whether that loss or damage is caused by any fault or negligence of the parties or otherwise. References to future matters in this brochure are based on the parties current knowledge or intentions and are subject to change. SPG is a trademark of Sentinel Property Group Pty Ltd ACN 149 805 489.