



1,294 North East Road, Tea Tree Gulley

ESTIMATED LETTABLE AREAS

Total Net Lettable Area*	178 sq. metres
Gross Building Area	195 sq. metres

Site (approx.) 729 sq. metres

*Complies with the PCA Method of Measurement

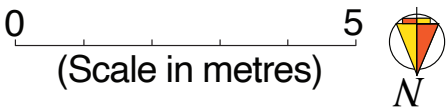

a/c outlets

Leslie Street

36.58m.

MetBx

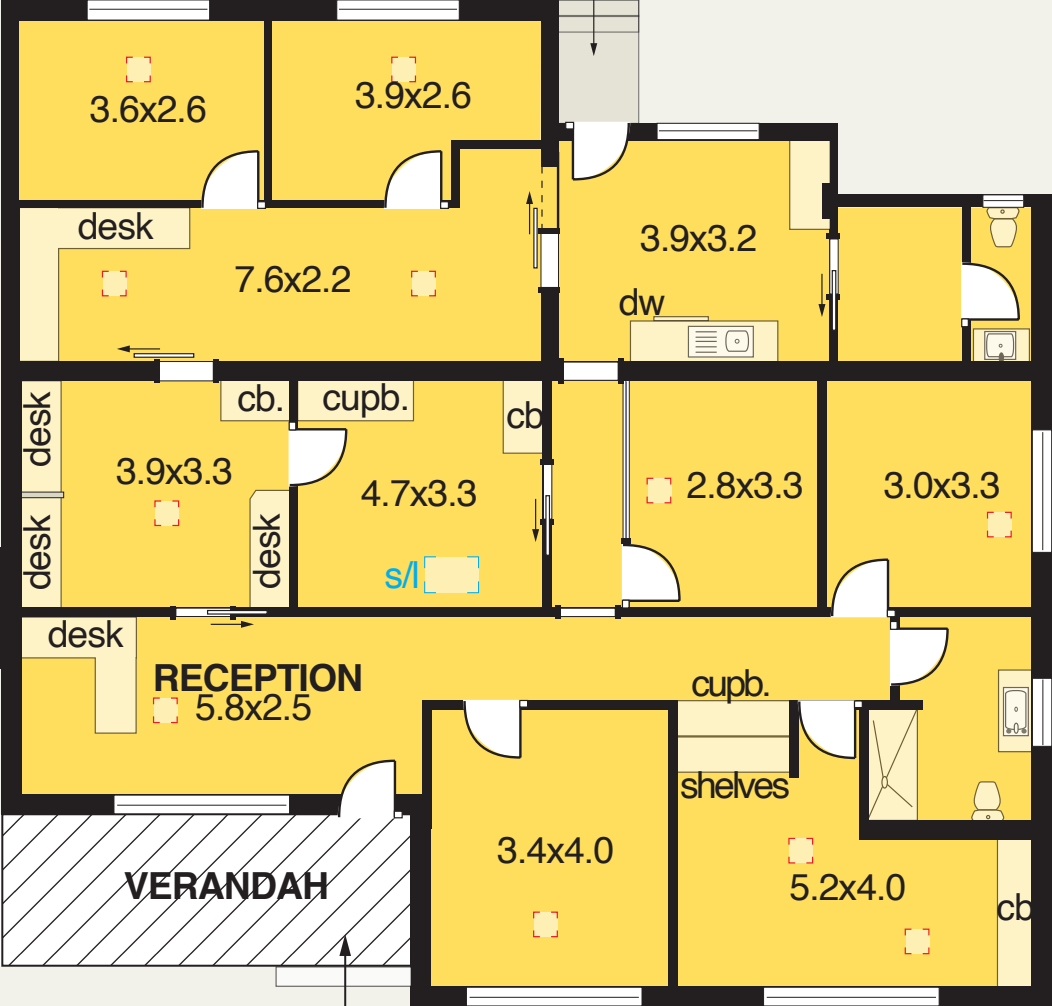

VERANDAH

CARPORT

GARAGE

6.7x5.5
span clearance: 2.0m.

PARKING / HARD STAND

15.29m.

North East Road

39.62m.

4.32m.