

Ground

Clear exposure and sight line to Khartoum Road

Ground floor activation with F&B and medical providers

Separate lift bank potential with discreet security arrangement

All-gender bathrooms



All details on this page are indicative only and subject to change and authority approvals. Please note sizes and areas are approximate.

L3-L6

Traditional

- Flexispace opportunity
- Large contiguous floorplates
- Side core lift banks
- Abundant natural light
- 1:10 people per sqm

Traditional Test-fit Metrics

- Headcount: 182
- Work stations: 184
- Meeting rooms: 14
- Kitchen: 1

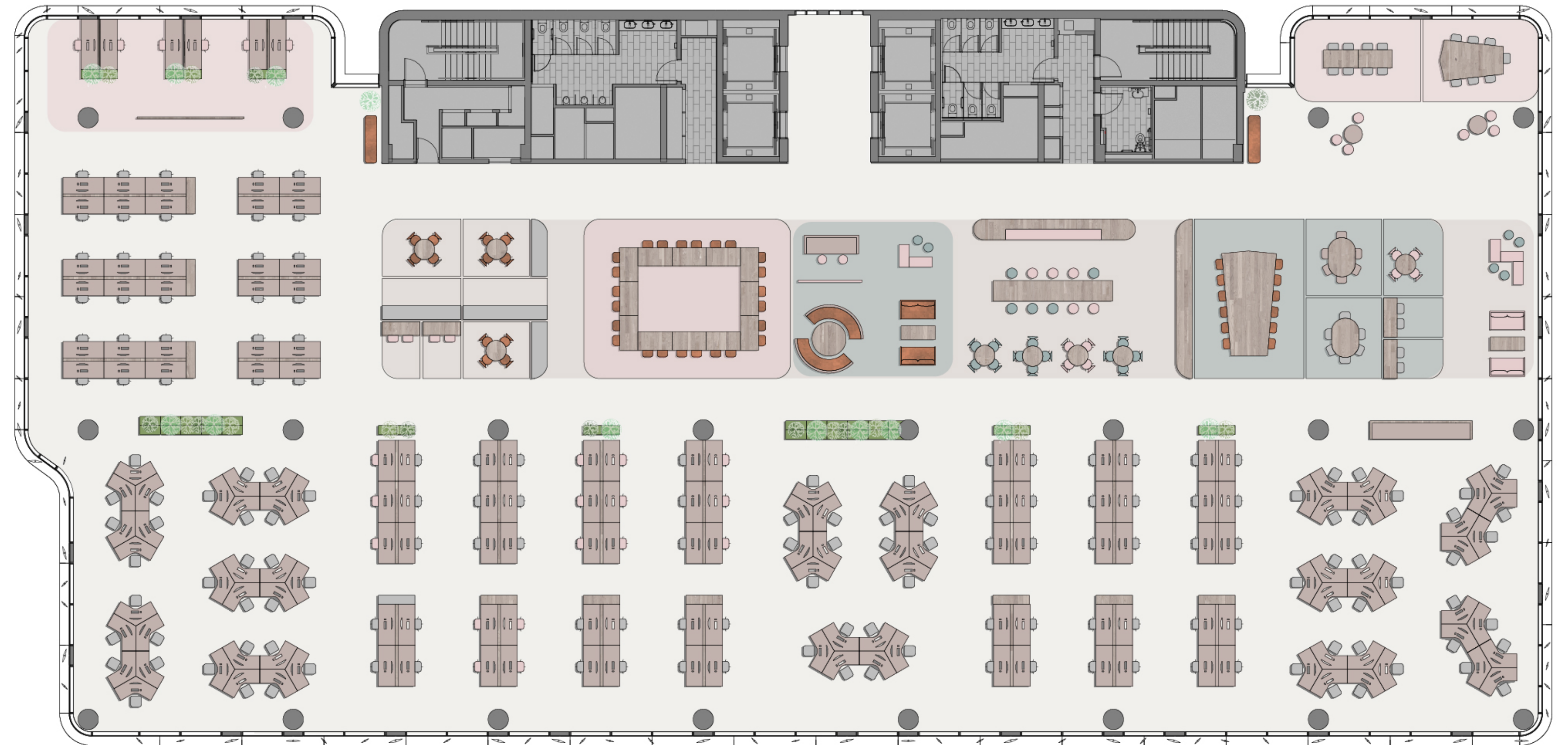

L7-L9

Agile

1,800sqm* typical floor NLA
Flexible design to maximise productivity in the workplace
Options for interconnecting stairs between flooring
Minimal perimeter columns

Agile at 70% Test-fit Metrics

Headcount: 184
Work stations: 130
Meeting rooms: 11
Kitchen: 1

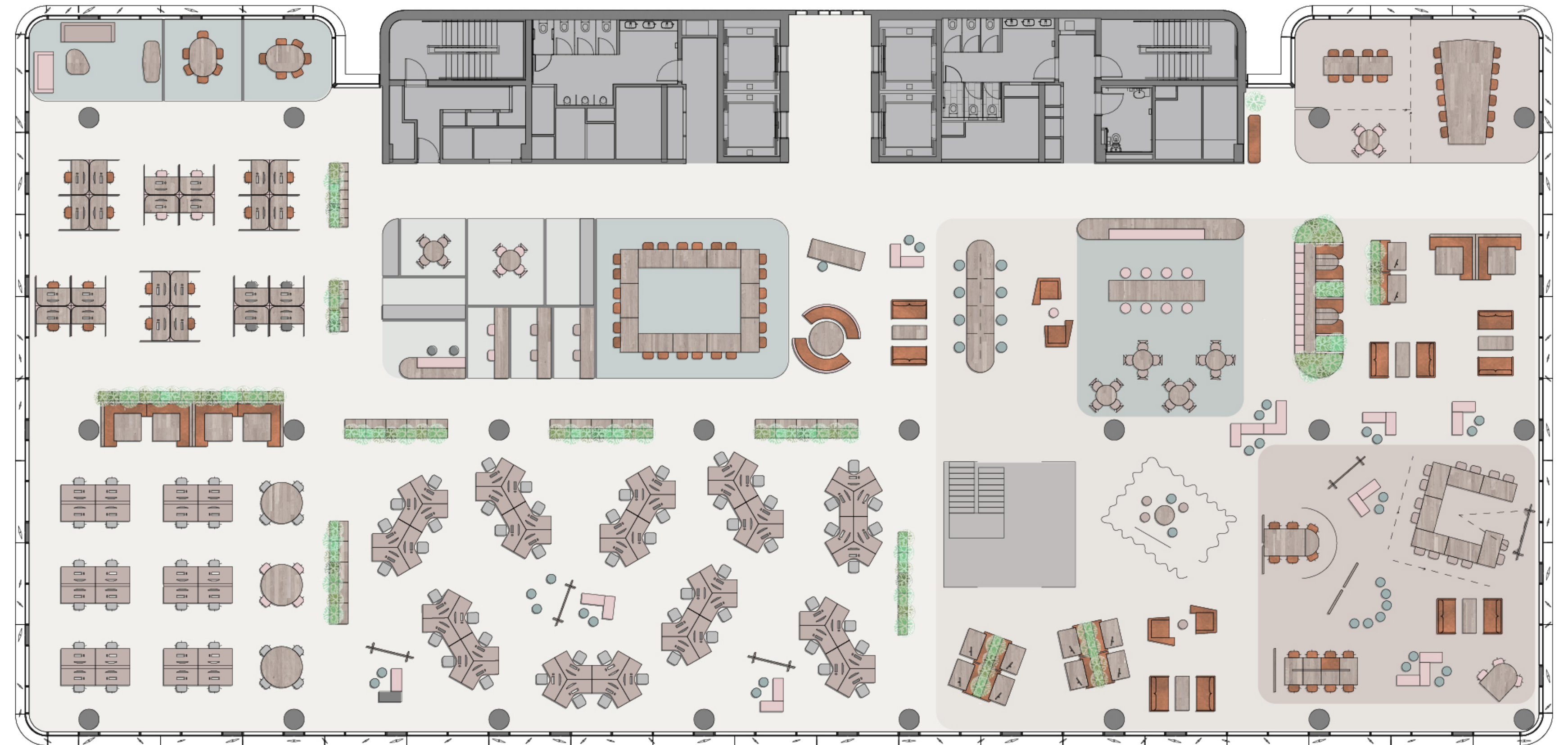

*Approximate figures, subject to change as the project progresses.
Represents the permissible office space under the current LEP.
All details on this page are indicative only and subject to change and authority approvals. Please note sizes and areas are approximate.