



# BENNETT + BENNETT

Property Consultants, Surveyors + Town Planners  
All mail to: PO Box 5021, GCMC, Qld. 9726  
mail@bennettandbennett.com.au

**GOLD COAST OFFICE**  
85 Upton Street, Bundall, 4217  
Ph (07) 5574 0733

**BRISBANE OFFICE**  
Suite 1,  
115 Cross Road  
Kedron, 4059  
Ph (07) 3838 7200

**COONERA OFFICE**  
8 Jovett Street,  
Coonera, 4202  
Ph (07) 5574 6177

**SUNSHINE COAST OFFICE**  
Suite 5,  
5-11 Downs Street,  
North Ipswich, 4305  
Ph (07) 3202 1575

Rev \_\_\_\_\_ Date \_\_\_\_\_

- NOTES:
1. Drawn to Scale on A3 sheet
  2. Lease area measured in accordance with the P.C.A. recommendations for G.L.A. (Gross Lettable Area).
  3. Title Reference: 15717003.
  4. Adjoining tenancies shown have been compiled from other sources and are diagrammatic only.
  5. Lease Boundaries are defined by structural elements, distances shown are indicative only unless noted otherwise.
  6. Meridian of RP157785.

TITLE

**PLAN OF LEASE AREA 4**  
being part of the Ground Floor  
of the building erected on  
Lot 8 on RP157785

CLIENT	ETOILE 6 PTY LTD		
Drawn	DA	Parish	NERANG
Surv'd	PCW	County	WARD
Approved	RMA	Job Ref.	13118
Comp File	13118.ccx		
Date	26/04/13	Dwg File	13118LEA1
SCALE	1:200	PLAN No.	2
Rev.			

NOTE: Lease boundaries are to the Glass Line unless noted otherwise.

## HARVEST COURT

## WAREHOUSE ROAD

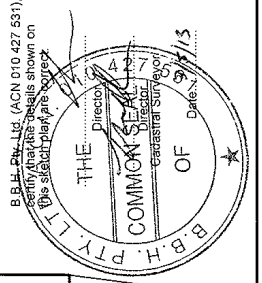
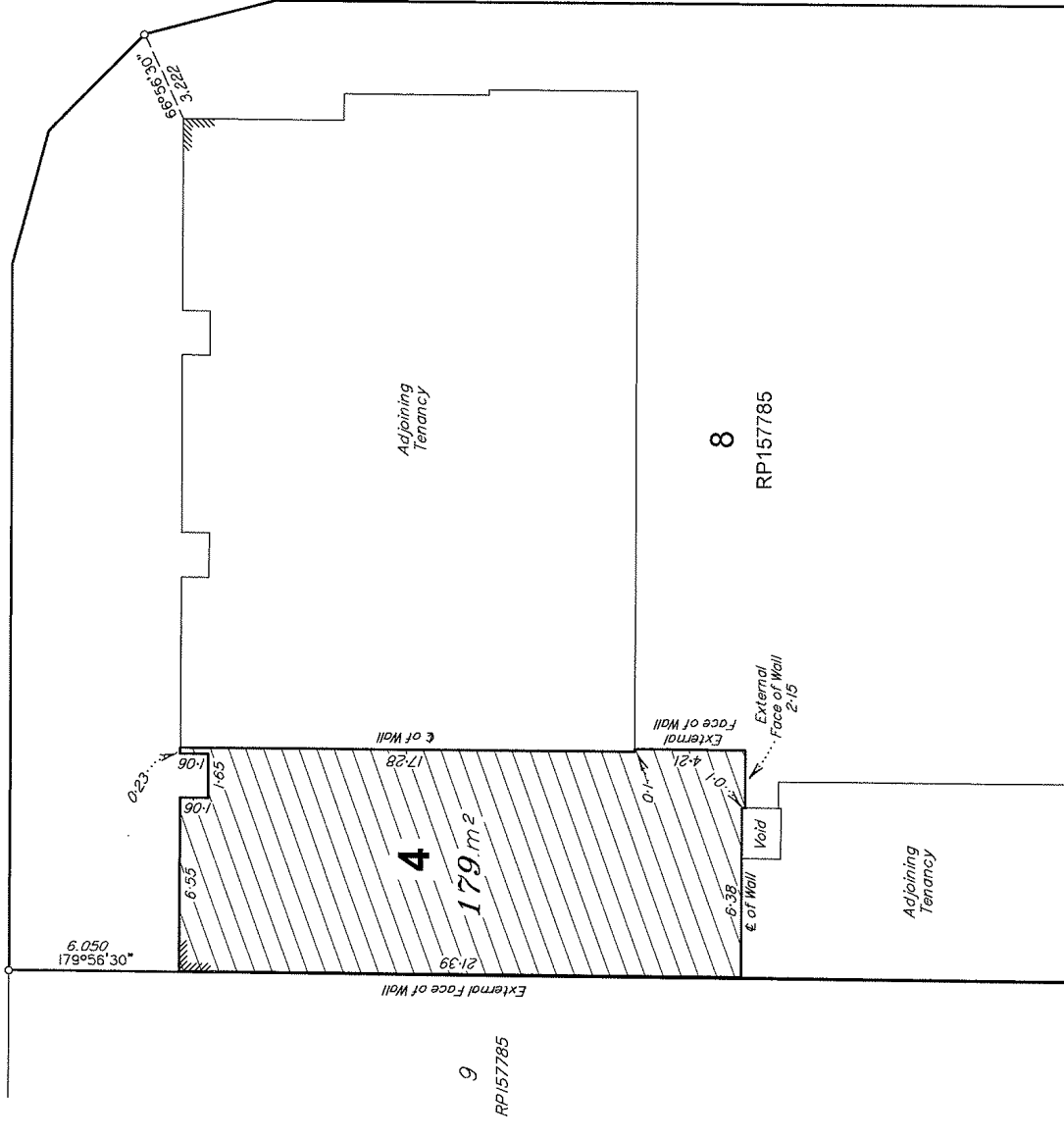

CP  
BUP/04226

SCALE 1:200

