

32.00



2 Kiwi Court, Lonsdale

ESTIMATED GROSS LETTABLE AREA

	Workshop 1:	352 sq.m
	Workshop 2:	180 sq.m
	Office & Amenities:	51 sq.m
	Workshop 3:	130 sq.m
	Office & Amenities:	36 sq.m

TOTAL GROSS LA: 749 sq.m

	Canopy:	15 sq.m
	Shed:	48 sq.m

Site Area: 1840 sq.metres

Complies with the
PCA Method of Measurement



57.50

57.50

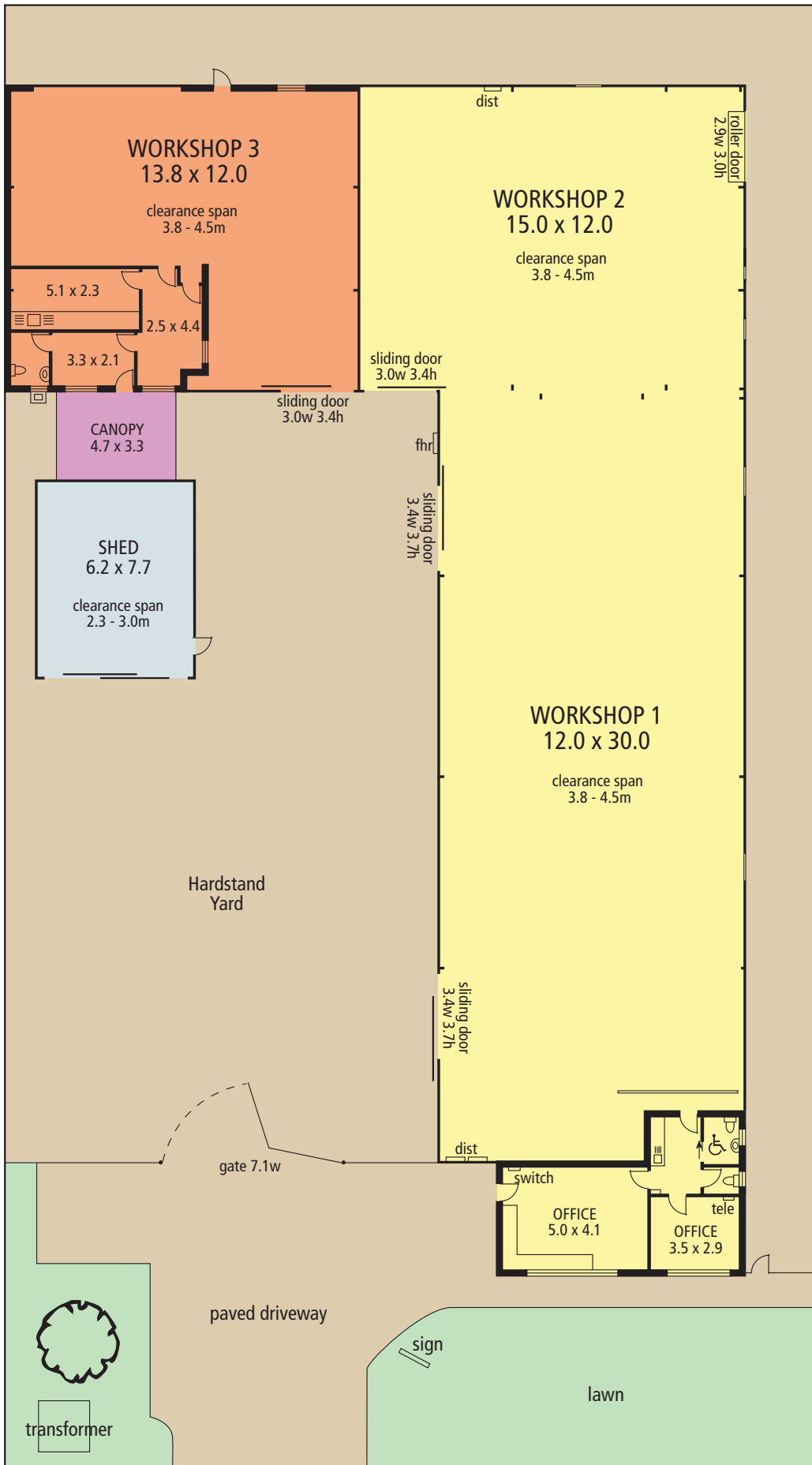

32.00

K I W I C O U R T