

BUILDING WORKS LEGEND	
[Symbol]	FULL HEIGHT WALL
[Symbol]	FULL HEIGHT INTERFERENCE WALL
[Symbol]	FULL HEIGHT NATURAL ANCHORED ALUMINUM GLAZING (TO MATCH EXISTING)
[Symbol]	MDF DOOR
[Symbol]	NATURAL ANCHORED FRAMED GLAZED DOOR
[Symbol]	NATURAL ANCHORED FRAMED SLIDING GLAZED DOOR
[Symbol]	EXISTING DOORS TO REMAIN
[Symbol]	EXISTING WALLS TO REMAIN
[Symbol]	RECESSED CURTAIN CHANNEL
[Symbol]	POLISHED CONCRETE
[Symbol]	CARPET
[Symbol]	FEATURE CARPET
[Symbol]	NOT INCLUDED IN THE SCOPE OF WORKS (EXISTING FITS)
[Symbol]	NEW OFFICE FURNITURE (IN WHITE OR COLOURS AS FITS)
[Symbol]	EXISTING FURNITURE TO BE RELOCATED TO DIFFERENT AREA
[Symbol]	EXISTING FURNITURE

PLEASE NOTE:
 - NUMBER OF TASK CHAIRS TO BE REQUESTED TO BE CONFIRMED ON SITE

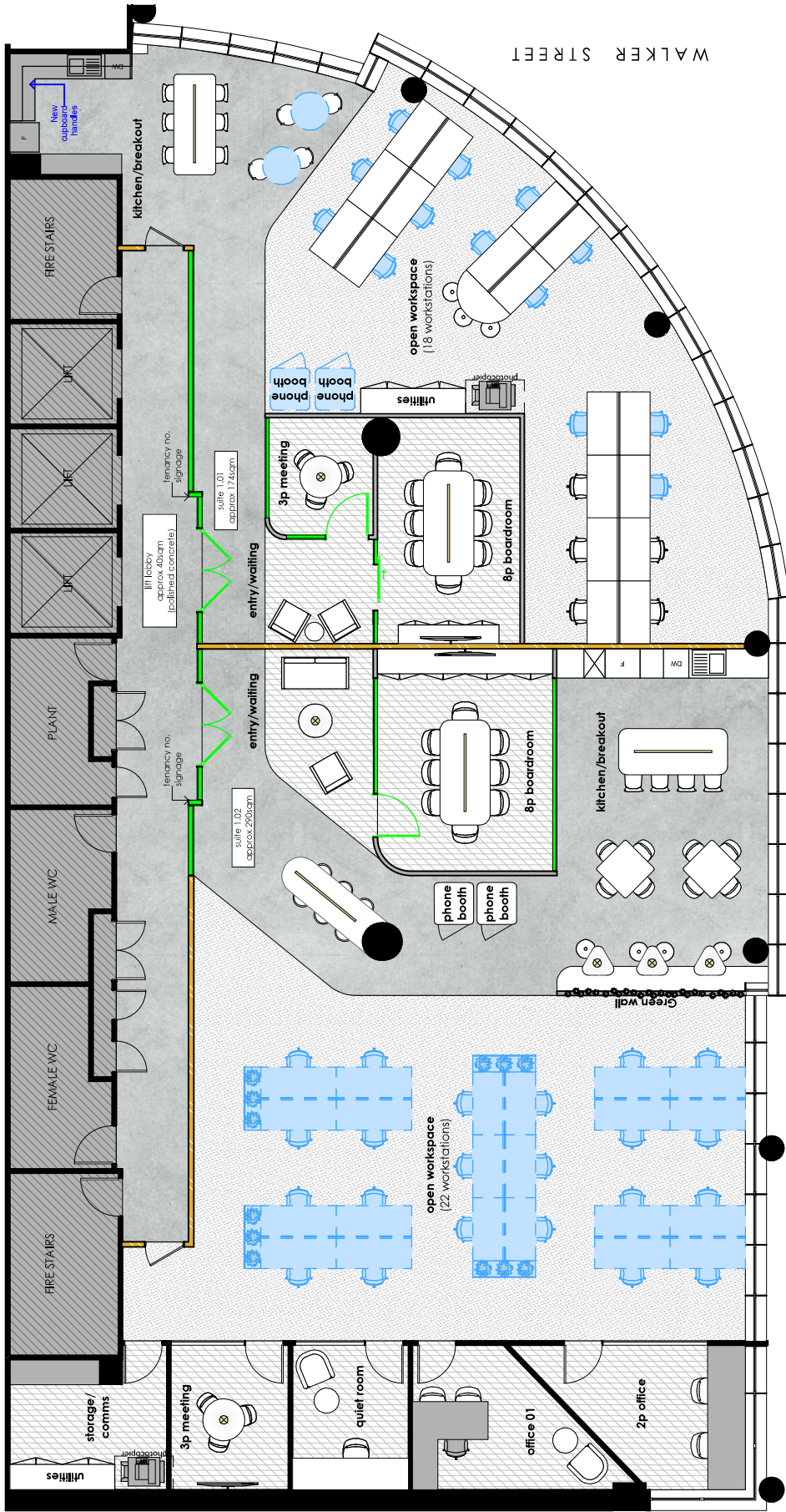

BLUE STREET

WALKER STREET

01 OPTION 01 - PROPOSED FLOOR PLAN
 1:100

PROJECT NO. 221128 DRAWN BY: AK SCALE: A3 @ 1:100

DATE	ISSUE	DESCRIPTION
02/06/2023	03	REVISED DESIGN
13/06/2023	04	REVISED DESIGN
20/06/2023	05	REVISED DESIGN

PROPOSED FLOOR PLAN

DESIGN & CONSTRUCT - OFFICE FIT-OUTS - REFURISHMENTS - MAKE-GOODS



L1 32 WALKER ST. NORTH SYDNEY

Level 1.6, 99 Mount Street, North Sydney 2060
 info@hasbullprojects.com.au
 02 8055 3770
 www.hasbullprojects.com.au



© Copyright Hasbull Projects Pty Ltd. Use or copying of this document is prohibited without the written consent of Hasbull Projects Pty Ltd. All dimensions must be verified on site. Do not scale from drawings. This drawing is to comply with all relevant local authority regulations.