

PROPOSED LEASE AREA
125.8 SQUARE METRES

AREA HAS BEEN DETERMINED IN ACCORDANCE WITH THE PROPERTY COUNCIL OF AUSTRALIA GUIDELINES FOR METHOD OF MEASUREMENT OF LETTABLE AREA (2004)

PROPOSED LEASE AREA IS LIMITED IN HEIGHT TO RL 6.4(AHD)
RL 6.4(AHD) LIES WITHIN THE ROOF STRUCTURE OF THE CAFE
THE VIEWING PLATFORM ABOVE THE CAFE IS NOT PART OF THE PROPOSED LEASE AREA

1
DP 1162572 "PIRRAMA PARK"

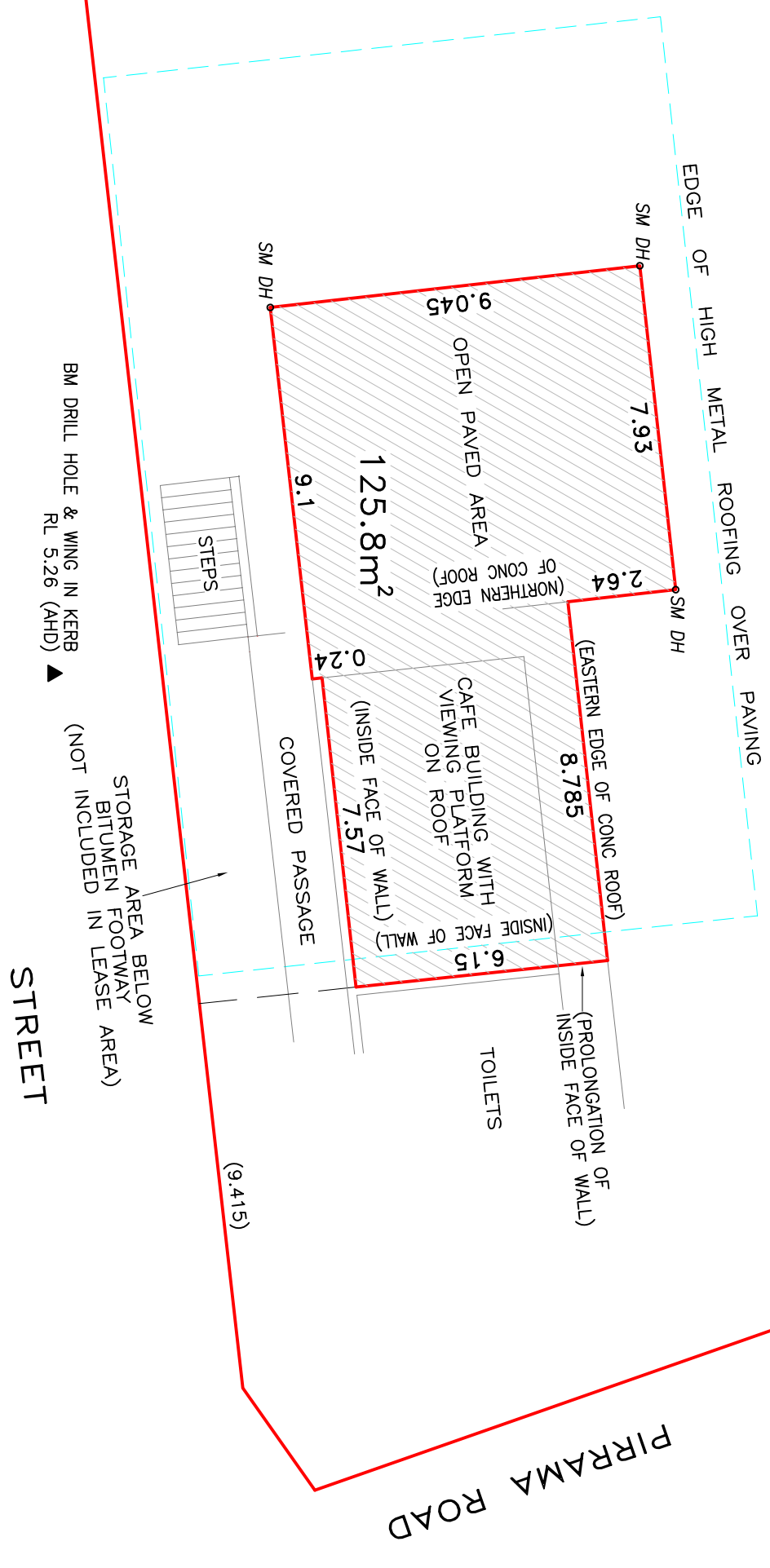

LEGEND
SM DH SMALL DRILL HOLE IN CONCRETE
CONC CONCRETE

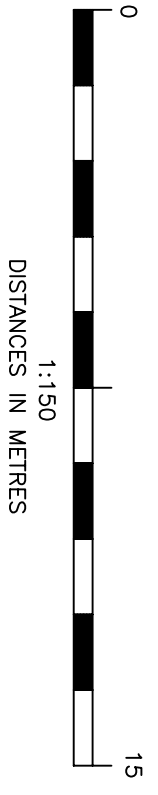

CLIENT: CITY OF SYDNEY

PLAN
SHOWING PROPOSED LEASE AREA
WITHIN PIRRAMA PARK
PYRMONT

SJ FEENEY & ASSOCIATES PTY LIMITED

LAND AND ENGINEERING SURVEYORS
POST OFFICE BOX 424
PETERSHAM NSW 2049
Phone: 9569 4442 Fax: 9569 4426
Email: feeneysurvey@optusnet.com.au

- NOTES:
- * THIS PLAN HAS BEEN PREPARED FOR THE PURPOSE OF SHOWING A LEASE AREA WITHIN THE LAND AND SHOULD NOT BE USED FOR ANY OTHER PURPOSE
 - * LEASE AREA HAS, WHERE APPLICABLE, BEEN DETERMINED USING THE PROPERTY COUNCIL OF AUSTRALIA GUIDELINES IN "METHOD OF MEASUREMENT" (REPRINTED IN 2004) FOR GROSS LETTABLE AREA. IN OTHER CIRCUMSTANCES THE SHAPE OF THE LEASE AREA HAS BEEN DETERMINED FOLLOWING ADVICE FROM COUNCIL
 - * NO SERVICE SEARCH HAS BEEN UNDERTAKEN AND UNDERGROUND SERVICES HAVE NOT BEEN INVESTIGATED. IF ANY EXCAVATION ON OR NEAR THE SITE IS INTENDED WE STRONGLY RECOMMEND THAT A FULL SERVICE SEARCH BE UNDERTAKEN WITH 'DIAL BEFORE YOU DIG' (PHONE NO. 1100) TO ENSURE THAT THE MOST UP TO DATE SERVICE INFORMATION IS AVAILABLE PRIOR TO WORK TAKING PLACE
 - * THESE NOTES ARE AN INTEGRAL PART OF THE PLAN

AMENDMENT A (5 OCT 2011): SHAPE OF LEASE AREA AMENDED

RATIO on A3 Sheet-1:150	LGA: CITY OF SYDNEY
DATUM: AHD	Date of Plan: 14 JULY 2011
Origin of Levels:	
SSM 168147-RL 2.895(AHD)	21086A
	SHEET 1 OF 1