

GROUND FLOOR PLAN

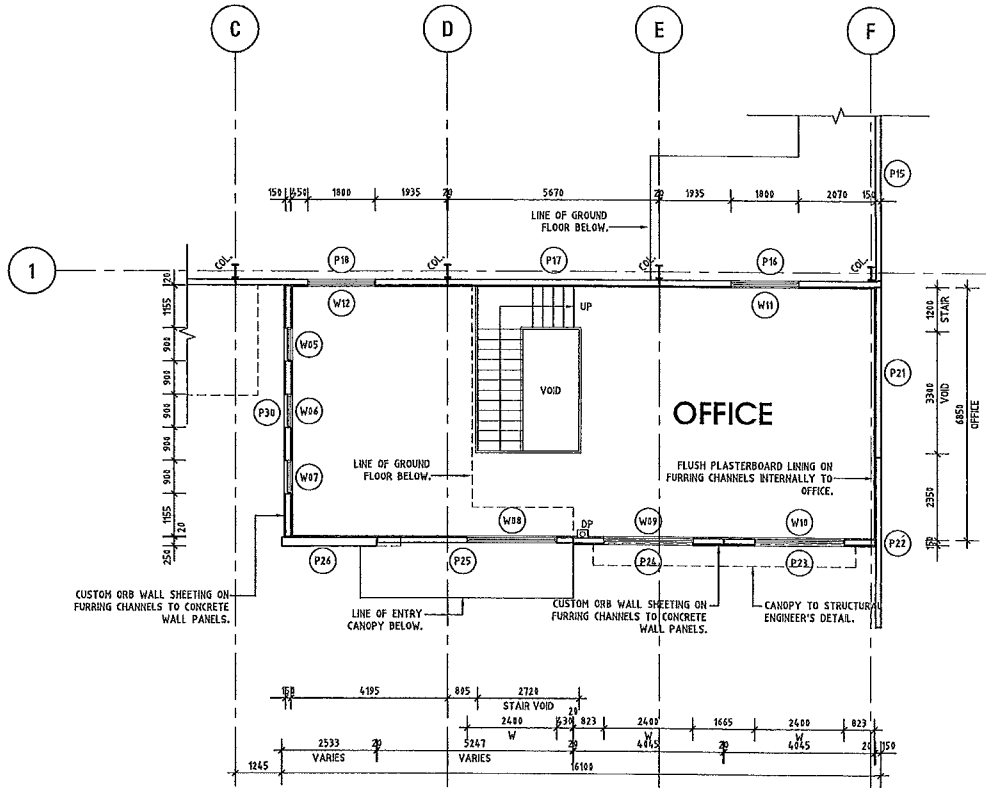

FIRST FLOOR PLAN

NOTE :

THE BUILDER IS TO ENSURE THE FOLLOWING ITEMS TO BE IN ACCORDANCE WITH CURRENT BUILDING CODE OF AUSTRALIA AND AUSTRALIAN STANDARD REQUIREMENTS

1. EMERGENCY LIGHTING
2. EXIT SIGNAGE
3. ESCAPE DOOR HARDWARE
4. FIRE HYDRANTS
5. FIRE HOSE REELS
6. PORTABLE FIRE EXTINGUISHERS
7. DISABLE ACCESS, DOORS AND HARDWARE
8. DISABLE TOILET AND FIXTURES
9. STAIR HANDRAILS AND BALUSTRADES
10. SMOKE DETECTION
11. FALL SAFE ANCHORAGE POINTS
12. FIRE DOORS & AUTOMATIC/Self CLOSING DEVICES

ALL DOORS TO BE 870 WIDE UNLESS NOTED OTHERWISE

ALL DIMENSIONS TO BE CHECKED AND CONFIRMED ON SITE PRIOR TO CONSTRUCTION

ED : DENOTES ESCAPE/EXIT DOOR  
 FHR : 36 M FIRE HOSE REEL

REV	DATE	CHKD	DESCRIPTION
C	17.07.18	TW	RE-ISSUED FOR APPROVAL / BLDG LICENCE
B	14.07.18	HC	ISSUED FOR APPROVAL / BLDG LICENCE
A	12.07.18	HC	CLIENT REVIEW

**MEG**

**MAROCCHI ENGINEERING GROUP**

SUITE 4, 110 HAY STREET, SUBIACO W.A. 6008  
 Tel: (08) 9380 9500 Fax: (08) 9380 9588

PROJECT  
**PROPOSED DEVELOPMENT  
 LOT 969 MEARES WAY  
 CANNINGVALE**

SHEET  
**GROUND & FIRST FLOOR PLAN**

DRAWN	HCA	SCALE	1:100 @ A1
DESIGNED	GN	DRG No	<b>07-583-A102</b>
CHECKED	GN	REV	<b>C</b>