

All drawings are the property of Empire Office Furniture (EOF), and only to be used for design, quoting & installation purposes between EOF and client. All furniture items shown on drawings are for pricing purposes only. Furniture selection and dimensions to be verified by EOF and approved by the client after the final site check and before manufacture.

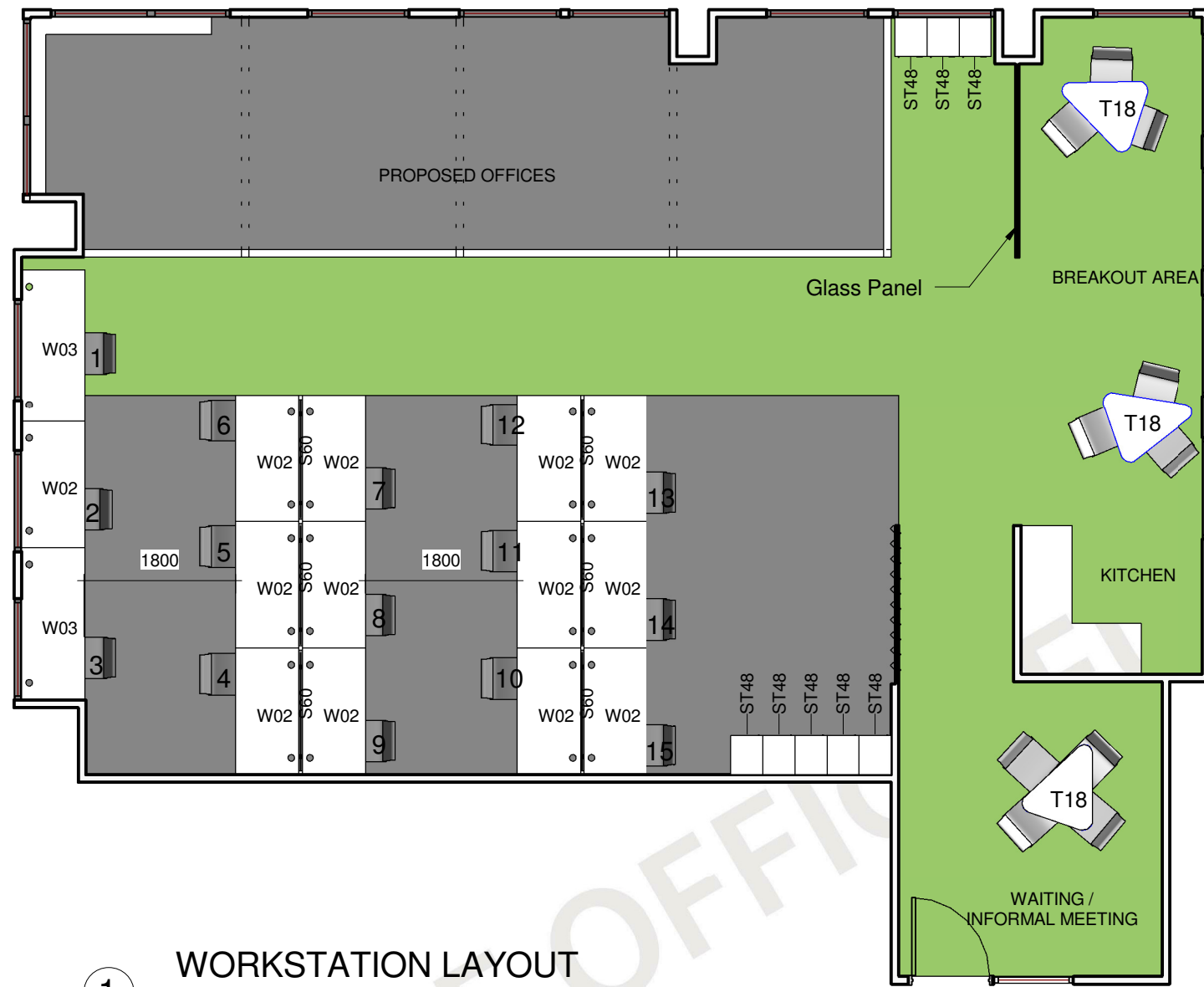

1 WORKSTATION LAYOUT
1 : 75

WORKTOP SCHEDULE	
CODE	DESCRIPTION
W02	CITI STRAIGHT WORKTOP 1500 x 750
W03	CITI STRAIGHT WORKTOP 1800 x 750

STORAGE SCHEDULE	
CODE	DESCRIPTION
ST48	TWO DOOR LOCKER 380 x 460 x1827 (H)

SCREEN SCHEDULE	
CODE	DESCRIPTION
S60	ECO PANEL SCREEN - 1400W

TABLE SCHEDULE	
CODE	DESCRIPTION
T18	CUSTOM SHAPED TABLE 725 HIGH

Note : Softwiring cable management included (4 power & 3 data outlets under worktops) for each workstation.
Allowance for up to a maximum of 24 GPO per 20 AMP circuit.

it's easier with **empire** CORPORATE PROJECTS
www.empirefurniture.com.au

Client: **DeMartini Fletcher**
PROPERTY DEVELOPMENT & INVESTMENT
WORKSTATION LAYOUT

REV	DESCRIPTION	DATE

CERTIFICATION
Certification and compliance of appropriate building codes and standards to be confirmed with certifiers by client prior to installation as is not the responsibility of EOF.

Floor Level	46 EDWARD STREET, BRISBANE	
10	Project Reference	WG-DEMART
Date		31.03.17
Drawn by		SS
Checked by		CE
A 101		Scale 1 : 75