

**BENNETT + BENNETT**  
 PO Box 502, GCMC QLD 9726  
 Ph: (07) 5631 8000  
 mail@bennettandbennett.com.au  
 Surveying, Town Planning & Spatial Services  
 GOLD COAST, BRISBANE, SUNSHINE COAST DISTRICTS  
 www.bennettandbennett.com.au

**NOTES:**  
 1. Drawn to Scale on A3 sheet  
 2. Lease area measured in accordance with the P.C.A. recommendations for G.L.A. (Gross Lettable Area.)  
 3. Title Reference: 17360071.  
 4. Adjoining tenancies shown have been compiled from other sources and are diagrammatic only.  
 5. Lease boundaries are defined by structural elements. Elements shown are indicative only unless noted otherwise.  
 6. Method of RP217869

Issue	Revision	Int	Date
A	Original Issue	JEW	21/12/2017

**Title:**  
**Plan of Lease Area "C1/C2"**  
 being part of the Ground Floor  
 of the building erected on  
 Lot 4 on RP217869

Client:	CENTRAL PARK
Locality:	ASHMORE
Local Gov:	GCCC
Prepared By:	JEW
Surveyed By:	LC
Approved:	PCW
Date Created:	21/12/2017
Scale:	1:750
Comp File:	09245_12D
Plan No:	09245_017_LEA_A

A3

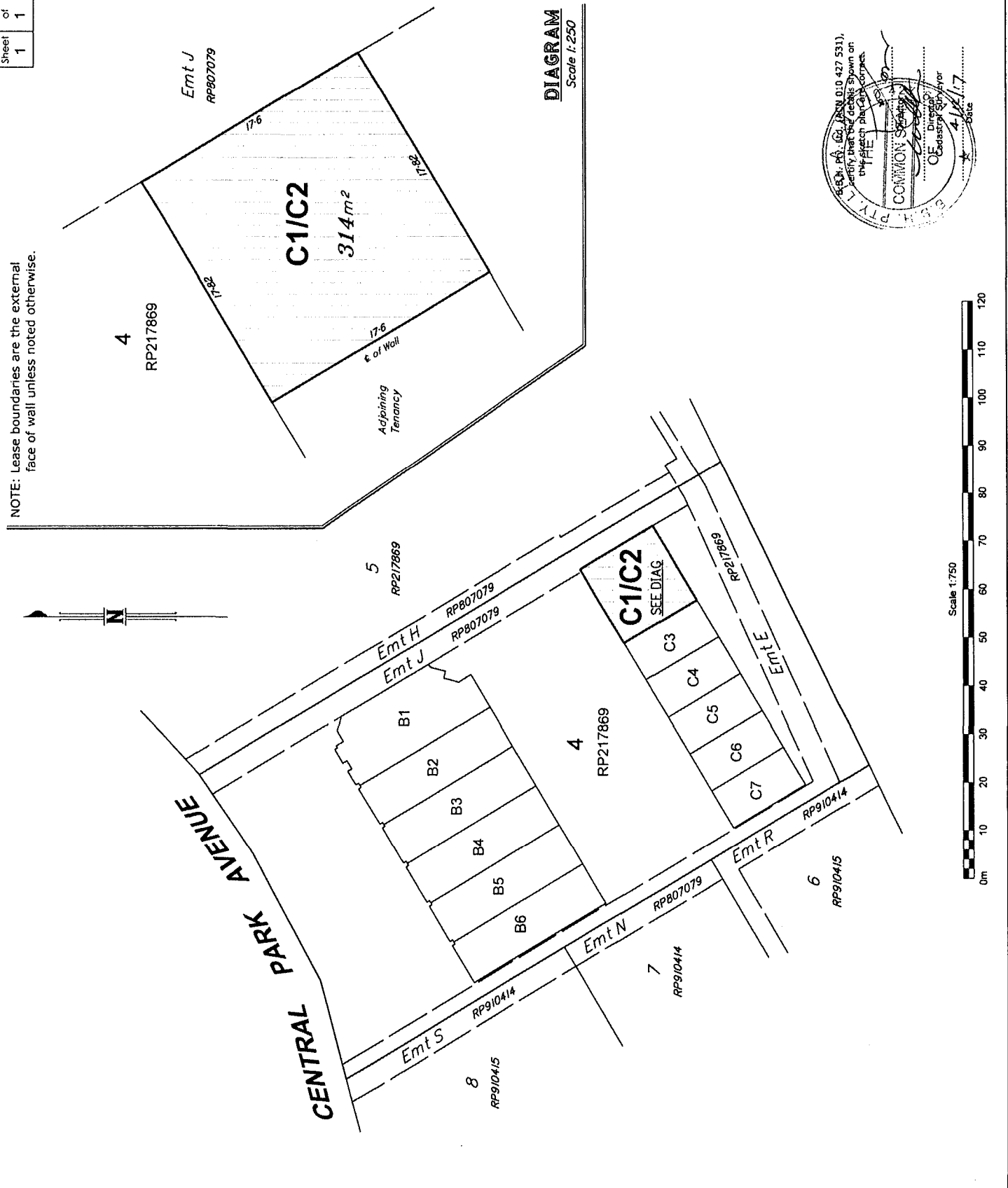

Sheet 1 of 1