

1/244 Unley Road, Unley

ESTIMATED GROSS LETTABLE AREA RETAIL

 Total Gross L.A.	132.9 sq. metres
 Cellar	32.0 sq. metres

Total Gross L.A.R. 164.9 sq. metres

Complies with the PCA Method of Measurement

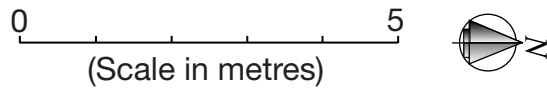

Cellar

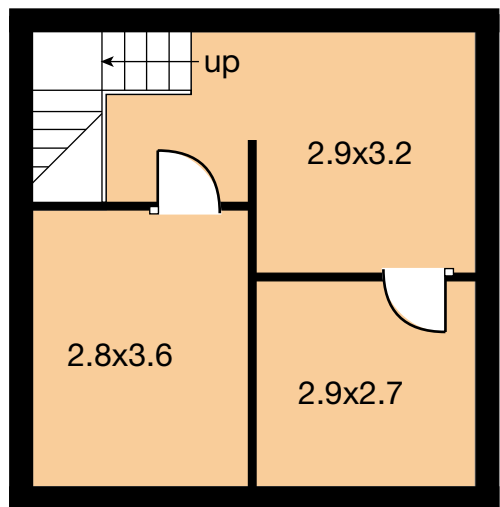

Hart Avenue

Unley Road