

NORTH

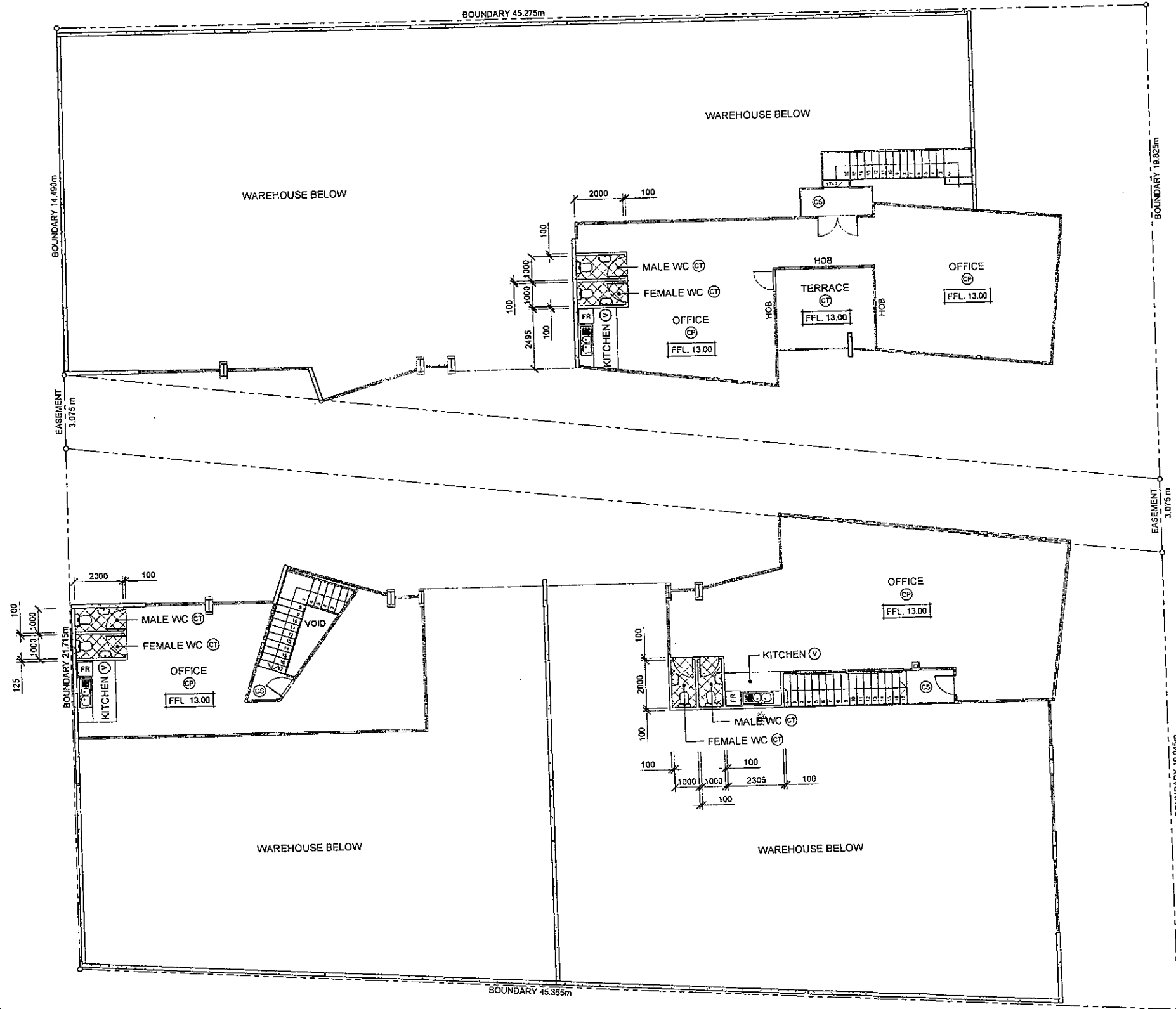

### FIRST FLOOR PLAN SCALE 1:100

#### FINISHES LEGEND

- Ⓢ DENOTES CONCRETE WITH STEEL TROWEL FINISH.
- Ⓣ DENOTES SELECTED CERAMIC TILING.
- Ⓟ DENOTES SELECTED CARPET.
- Ⓥ DENOTES SELECTED VINYL FLOORING.
- Ⓧ DENOTES STORMWATER DOWNPIPE LOCATION.

#### NOTES:

1. ALL OFFICE AREAS ARE TO BE AIR CONDITIONED, UNLESS NOTED OTHERWISE.
2. ALL OFFICE AREAS ARE TO HAVE SKIRTINGS CAPABLE OF CONCEALING ELECTRICAL AND DATA CABLING, UNLESS NOTED OTHERWISE.
3. ALL LOADING DOCK ROLLER DOORS ARE TO BE MOTORIZED, UNLESS NOTED OTHERWISE.
4. THE BUILDER IS TO SUPPLY 1 x 3PHASE OUTLET FOR THE CHARGING OF FORKLIFTS ADJACENT TO THE ELECTRICAL DISTRIBUTION BOARD IN EACH WAREHOUSE UNIT, UNLESS NOTED OTHERWISE.
5. THE BUILDER IS TO PROVIDE EXTERNAL LIGHTING TO THE LOADING DOCK AND DRIVEWAY AREAS OF THE DEVELOPMENT.
6. THE BUILDER IS TO PROVIDE MECHANICAL VENTILATION TO ALL TOILETS, UNLESS NOTED OTHERWISE.
7. THE BUILDER IS TO PROVIDE CLEAR SEALER TO ALL WAREHOUSE FLOOR AREAS, UNLESS NOTED OTHERWISE.

AMENDMENTS:  
 A DRIVEWAY & FLOOR LEVELS REVISED AS REQUESTED BY COUNCIL 8.4.2006

**W. G. SCOTT A.S.T.C. CONSULTING ENGINEER**  
 22 OLOLA AVENUE  
 CASTLE HILL, N.S.W. 2154  
 Tel: (02) 9634-1993, (02) 9634-5093 Fax: (02) 9634-7803

### FIRST FLOOR PLAN

Proposed Industrial Development for:  
**FIRE DAM CIVIL ENGINEERING PTY LTD**  
 88-88 ASQUITH STREET, AUBURN  
 LOTS 27 & 28 IN D.P.6484 & PART LOT 2 IN D.P.791686.

BUILDER			Ph:
SCALE	1:100		
DRAWN	CDS-bez	AUG. 2005	
REFERENCE			
CHECKED			

**A1 8021/05A**