

2 Perspective View

TRANSPARENT WALLS
INDICATIVE CEILINGS / BEAMS

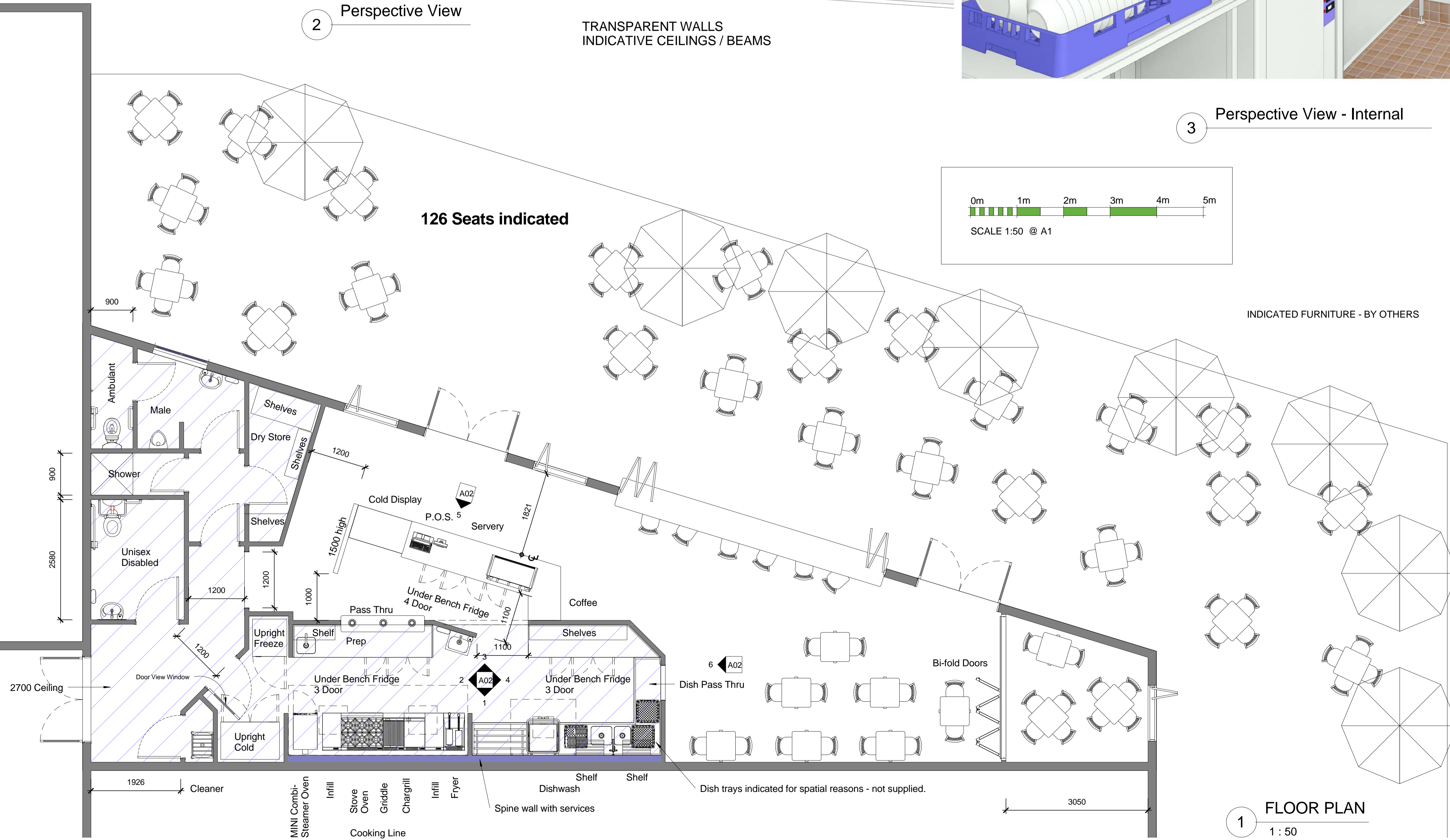

3 Perspective View - Internal



Item	Description	Dimensions	No Off
01	Economy Passthrough Dishwasher, 500mm Rack	765w x 765d x 1525h (2035h open)	1
02	Mini Combi Oven Stand - 6, 10	515w x 776.5d x 698h	1
03	Electric MINI Combi-Steamer Oven - 10 x 1/1 GN capacity	515w x 657h x 777h	1
04	In Fill Bench Top - Leg Stand with Standard Splashback	400w x 805d x 915h Incl. Splashback 1130h	2
05	Oven Range - Gas, 6 Burner, Gas Static Oven with Standard Splashback	900w x 805d x 915h Incl. Splashback 1130h	1
06	Griddle - Gas, Leg Stand & Standard Splashback	450w x 805d x 915h Incl. Splashback 1130h	1
07	Char grill - Gas, Leg Stand with Standard Splashback	450w x 805d x 915h Incl. Splashback 1130h	1
08	Fryer - Gas, Single Pan, 20 Litre, Mechanical Controls with Standard Splashback	450w x 805d x 915h Incl. Splashback 1130h	1
09	Espresso Maker - 3 Group	BY OTHERS	1
10	Chilled Food Display - Sliding rear doors & two wired shelves	1200w x 725d x 1250h	1
11	LH - Food Service 1/1 - 3 Hinged Doors Chiller - Integral	1799w x 680d x 716h*	2
12	LH - Food Service 1/1 - 4 Hinged Doors Chiller - Integral	2267w x 680d x 716h*	1
13	Double Solid Door Upright Chiller	1260w x 803d x 1930h	1
14	Single Solid Door Upright Freezer	740w x 803d x 1930h	1
15	Cleaners Sink - Wall Mounted - Front Legs, c/w grate.	560w x 460d	1
16	Post Style with Wire Grid Shelving - Zinc Finish, 5 Tier	1350w x 600d x 2000h	1
17	Post Style with Wire Grid Shelving - Zinc Finish, 5 Tier	1050w x 300d x 2000h	1
18	Point Of Sale - Cash Register	BY OTHERS	1
19	Wash Basin - Knee Operated	500 x 420	1
20	Towel Dispenser - White	302w x 102d x 444h	3
21	Liquid Soap Dispenser - White	112w x 114d x 291h	3
22	Hob Mounted Dual Mixer Assembly with Pot Filler		1
23	Dorf Flickmixer Plus Sink Mixer	BY OTHERS	1
24	Heat Lamp		3
F01	Chair - Lancaster Style 02 - Black		126
F02	Round Table - Avila Feet	600 x 600	34
F03	Long Benchtop	5950 x 600	1
F04	Pass Through Top	1795 x 350	1
M1	Exhaust Canopy - Twin Duct - Vapour sealed fluo lighting.	3850w x 1500d x 700h	1
M2	Exhaust Canopy - Dishwash Area	1400w x 1200d x 700h	1
S01	Bench 'L' - Stainless Steel, P Frame, Wet Edge, DW RH end, 300mm Splashback, Mid Shelf Under RH side. Sinks - 450x400x300 & 400x 350x300	2200x700d 2100x550d x 900h Plus Splashback	1
S02	Bench Straight, Stainless Steel, P Frame, Wet Edge, DW LH end, 300mm Splashback & Mid Shelf Under	1200w x 700d x 900h Plus Splashback	1
S03	Bench Straight, Stainless Steel, P Frame, 300mm Splashback, 45" end.	2845w x 700d x 900h Plus 300 Splashback	1
S04	Bench Straight, Stainless Steel, P Frame, 300mm Splashback (3 sides) Mid shelf under & Sink 400x350x300	3000w x 700d x 900h Plus 300 Splashback	1
S05	Bench Servery Custom	3342/1153w x 800d x 900h	1
S06	Wall Mounted Shelf - Wash Trays	1100w x 569d x 428h	1
S07	Wall Shelf - 1.2mm SS.	2100w x 300d	3
S08	Wall Shelf - 1.2mm SS.	900w x 300d	1
S09	Wall Shelf - Pipes - 1.2mm SS.	600w x 300d	1
S10	Wall Shelf - Pipes - 1.2mm SS.	600w x 300d	1



4 Perspective View - Internal
FRONT WALL REMOVED

EQUIPMENT SERVICES - DETAILED

ITEM	DESCRIPTION	No. OFF	DIMENSIONS	TYPE COMMENTS	VOLTAGE	PHASE - Ø	kW	AMPS	GAS: CONNECT	GAS - USAGE	WASTE: CONNECT	WASTE: LINE	WATER SUPPLY: COLD	WATER SUPPLY: SOFT	WATER PRESSURE
01	Economy Passthrough Dishwasher. 500mm Rack	1	705w x 765d x 1530h (2035h open)		240V 50 Hz or 400-415V 50Hz	Single +N+E or Three +N+E	-	15 Amps			1.5" BSP	2" BSP	3/4" BSP - 20mm. 65°C	Potable & Soft.	200-350k Pa
02	Mini Combi Oven Stand - 6.10	1	515w x 776.5d x 698h	Open with 7 Pairs of shelf rails											
03	Electric MINI Combi-Steamer Oven - 10 x 1/1 GN capcity	1	515w x 857h x 777h	10 x 1/1 GN tray capacity.	400-415V 50/60Hz	Three +N+E	10.5kW	15.7 Amps			R40		R3/4"		
04	In Fill Bench Top - Leg Stand with Standard Splashback	2	400w x 805d x 915h Incl. Splashback 1130h												
05	Oven Range - Gas, 6 Burner, Gas Static Oven with Standard Splashback	1	900w x 805d x 915h Incl. Splashback 1130h	COOKTOP: Cast iron 28MJ/hr open burners. OVEN: GN 2/1 capacity with 4 position racking. 30MJ oven burner.					R3/4 (BSP) male	198MJ/hr					
06	Griddle - Gas, Leg Stand & Standard Splashback	1	450w x 805d x 915h Incl. Splashback 1130h	40MJ single 3 bar even heat burner with single thermostatic control.					R3/4 (BSP) male	53MJ/hr					
07	Chargrill - Gas, Leg Stand with Standard Splashback	1	450w x 805d x 915h Incl. Splashback 1130h	1 x 48 MJ/hr 304 stainless steel U-burners. Reversible heavy-duty top grates. Inclined position to reduce flare and enhance grease run.						48MJ/hr					
08	Fryer - Gas, Single Pan, 20 Litre, Mechanical Controls with Standard Splashback	1	450w x 805d x 915h Incl. Splashback 1130h	450mm wide single pan fryer. 2 nickel plated wire baskets 140w x 335d x 145h					R3/4 (BSP) male	90MJ/hr					
09	Espresso Maker - 3 Group	1	BY OTHERS		220 - 240V - 50/60Hz	Single									
10	Chilled Food Display - Sliding rear doors & two wired shelves	1	1200w x 725d x 1250h	2 to 8°C - Ambient 32°C & 90% RH. Carel digital temp. control & read-out	230-240V 50/60Hz	Single +N+E									
11	LH - Food Service 1/1 - 3 Hinged Doors Chiller - Integral	2	1799w x 680d x 716h*	* = Height excludes castors, adjustable legs or optional 35mm Stainless Steel worktop.	230-240 Volts AC 50 Hz	Single	0.485	3.17 Amps							
12	LH - Food Service 1/1 - 4 Hinged Doors Chiller - Integral	1	2267w x 680d x 716h*	* = Height excludes castors, adjustable legs or optional 35mm Stainless Steel worktop.	230-240 Volts AC 50 Hz	Single	0.63	3.24 Amps							
13	Double Solid Door Upright Chiller	1	1260w x 803d x 1930h	NOTE: Min. 200mm clear ventilation space above. 3 adjustable shelves per door.	220-240 Volts AC 50 Hz	Single		3.31 Amps							
14	Single Solid Door Upright Freezer	1	740w x 803d x 1930h	NOTE: Min. 200mm clear ventilation space above. 3 adjustable shelves per door.	220-240 Volts AC 50 Hz	Single	0.58	4.13 Amps							
18	Point Of Sale - Cash Register	1	BY OTHERS												
24	Heat Lamp	3		250W Teflon coated light bulb to Food Standards Regulations											

MECHANICAL EQUIPMENT

ITEM	DESCRIPTION	DIMENSIONS	NO. OFF
M1	Exhaust Canopy - Twin Duct - Vapour sealed fluro lighting.	3850w x 1500d x 700h	1
M2	Exhaust Canopy - Dishwash Area	1400w x 1200d x 700h	1