

SCHEDULE

743 - 745 NICHOLSON STREET	
TITLE DETAILS	TP782782
LAND AREA	436 m ²
BUILDING AREA	175 m ²

DISCLAIMER: THIS PLAN HAS BEEN PREPARED FOR MARKETING PURPOSES ONLY. INTERESTED PARTIES SHOULD UNDERTAKE THEIR OWN ENQUIRIES AS TO THE ACCURACY OF THE INFORMATION. AREAS ARE APPROXIMATE AND DIMENSION ROUNDING MAY RESULT IN AREA DISCREPANCIES.



CLIENT:



SITE PLAN

743 - 745 NICHOLSON STREET,
CARLTON NORTH, VIC

DATE: 04/02/2022

REF: 81345 REV: A
DRAWN: GC CHECKED: LW
SCALE: 1:125 @ A3 SHEET: 1 OF 2

Australia | New Zealand

REALSERVE
Start confident.

Building Measurement Specialist
Consulting Land Surveyors
3D Laser Scanning

ph. 03 9415 6565

www.realserve.com.au

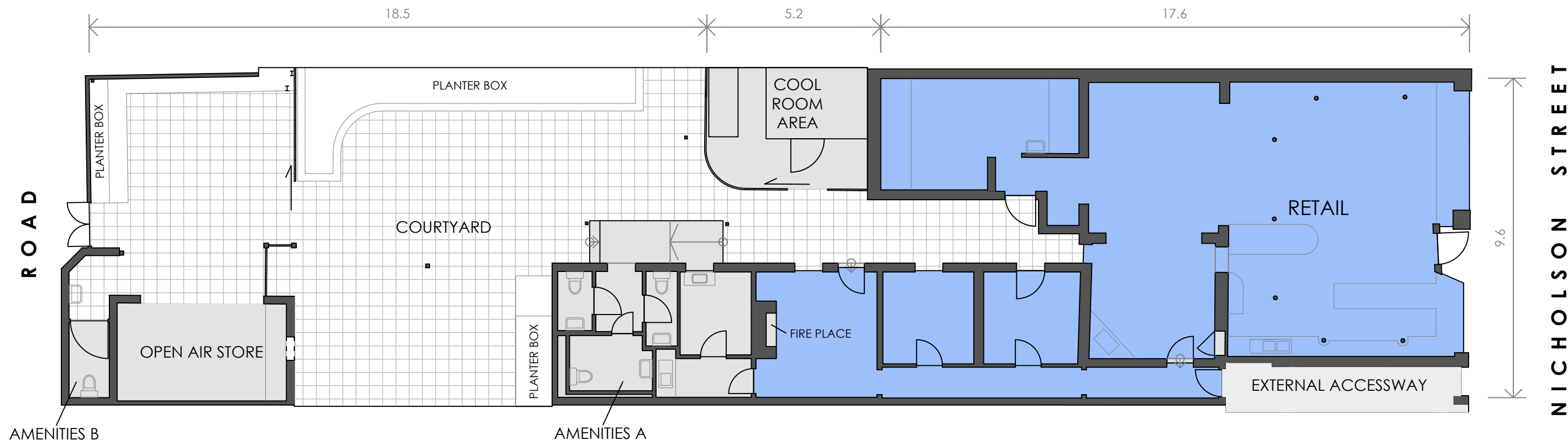

SCHEDULE OF AREAS

743 - 745 NICHOLSON STREET	
RETAIL	154 m ²
AMENITIES A	21m ²
TOTAL	175 m ²
COURTYARD	164 m ²
AMENITIES B	3 m ²
COOL ROOM AREA	17 m ²
OPEN AIR STORE	15 m ²

DISCLAIMER: THIS PLAN HAS BEEN PREPARED FOR MARKETING PURPOSES ONLY. INTERESTED PARTIES SHOULD UNDERTAKE THEIR OWN ENQUIRIES AS TO THE ACCURACY OF THE INFORMATION. AREAS ARE APPROXIMATE AND DIMENSION ROUNDING MAY RESULT IN AREA DISCREPANCIES.



CLIENT:



MARKETING DRAWING
743 - 745 NICHOLSON STREET,
CARLTON NORTH, VIC

DATE: 04/02/2022
REF: 81345
DRAWN: GC
SCALE: 1:125 @ A3
REV: CHECKED: A LW
SHEET: 2 OF 2

Australia | New Zealand
REALSERVE
Start confident.

Building Measurement Specialist
Consulting Land Surveyors
3D Laser Scanning
ph. 03 9415 6565
www.realserve.com.au