

ENFIELD

377 Main North Road

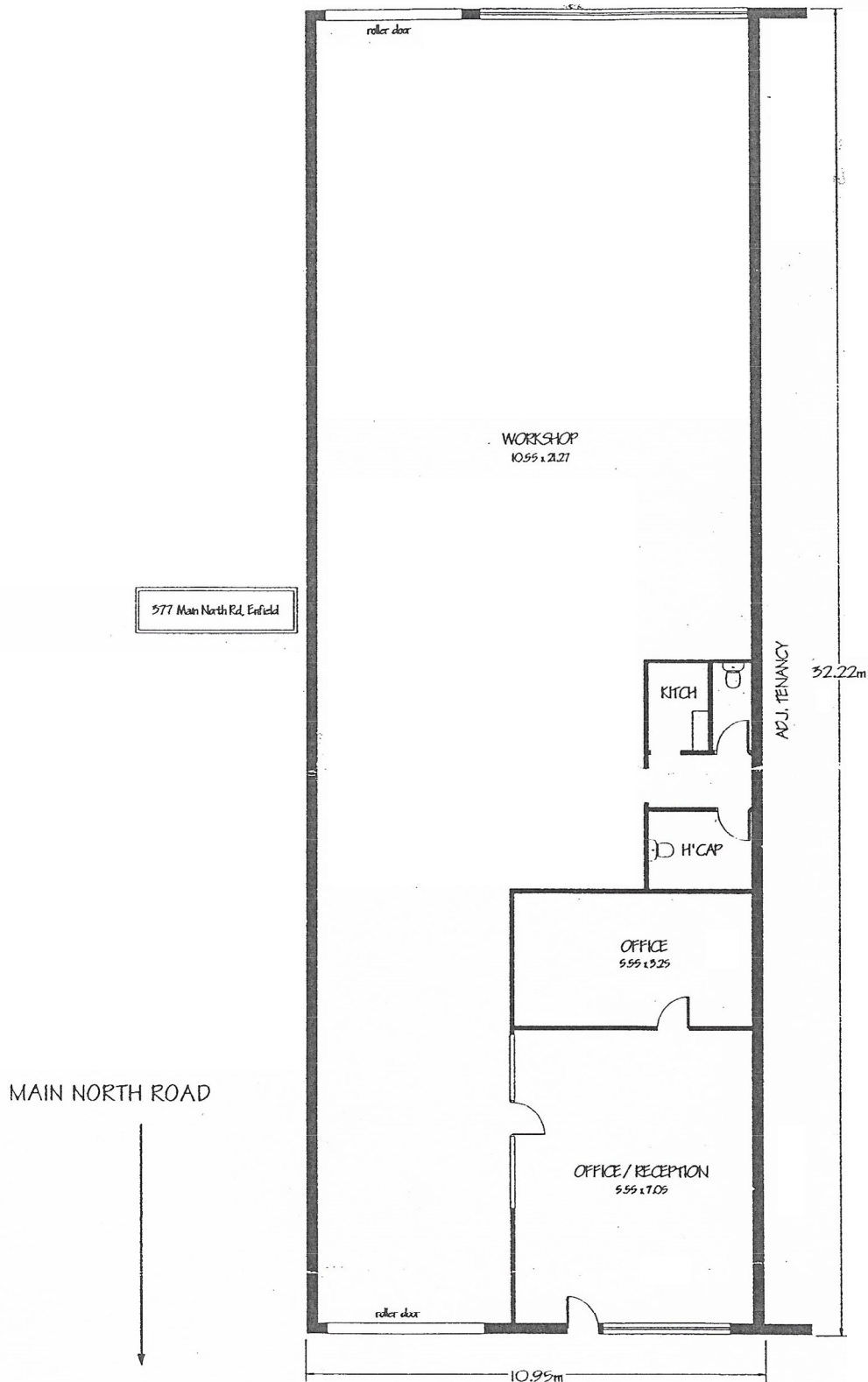

Council Area: Enfield Land Size: 10.66 x 40.08m (area: 427m²) CT: Vol 5262 Fol 439

Richardson & Wrench for themselves and the Vendors of this property whose Agents they are, give notice that (i) The particulars are set out as general outline for the guidance of purchasers and do not constitute an offer or contract. (ii) All descriptions, dimensions, references to conditions and necessary permission for use and occupation and other details are given in good faith and are believed to be connected by any intending Purchaser should not rely on them as statements of fact but must satisfy themselves by inspection or otherwise as to the correctness of each of them. (iii) No persons in the employ of Richardson & Wrench has any authority to make or give any representation or warranty whatsoever in relation to this property. Section 7 statements available at auctioneer's office 3 business days prior to auction and at place of auction 30 minutes prior to commencement. While every effort has been made to verify the information contained on this brochure, neither the agent or vendors accept liability for any errors and/or omissions. Produced by Final Image Photographics (08) 211 7000