





SITE

South Road

Grand Junction Road

Eastern Parade

Port River Expressway

CBD

Ocean Steamers Road

ANIL

No. 3 Dock

No. 2 Dock

No. 1 Dock

From	Dist	PM Number
PM FD	002-14	6628/53412
PM FD	1-00	6628/41674
MP FD	1-43	
SIN FD	3-64	
PM FD	28-05	6628/36098

NEW FIX

72-74 Grand Trunkway Gillman.

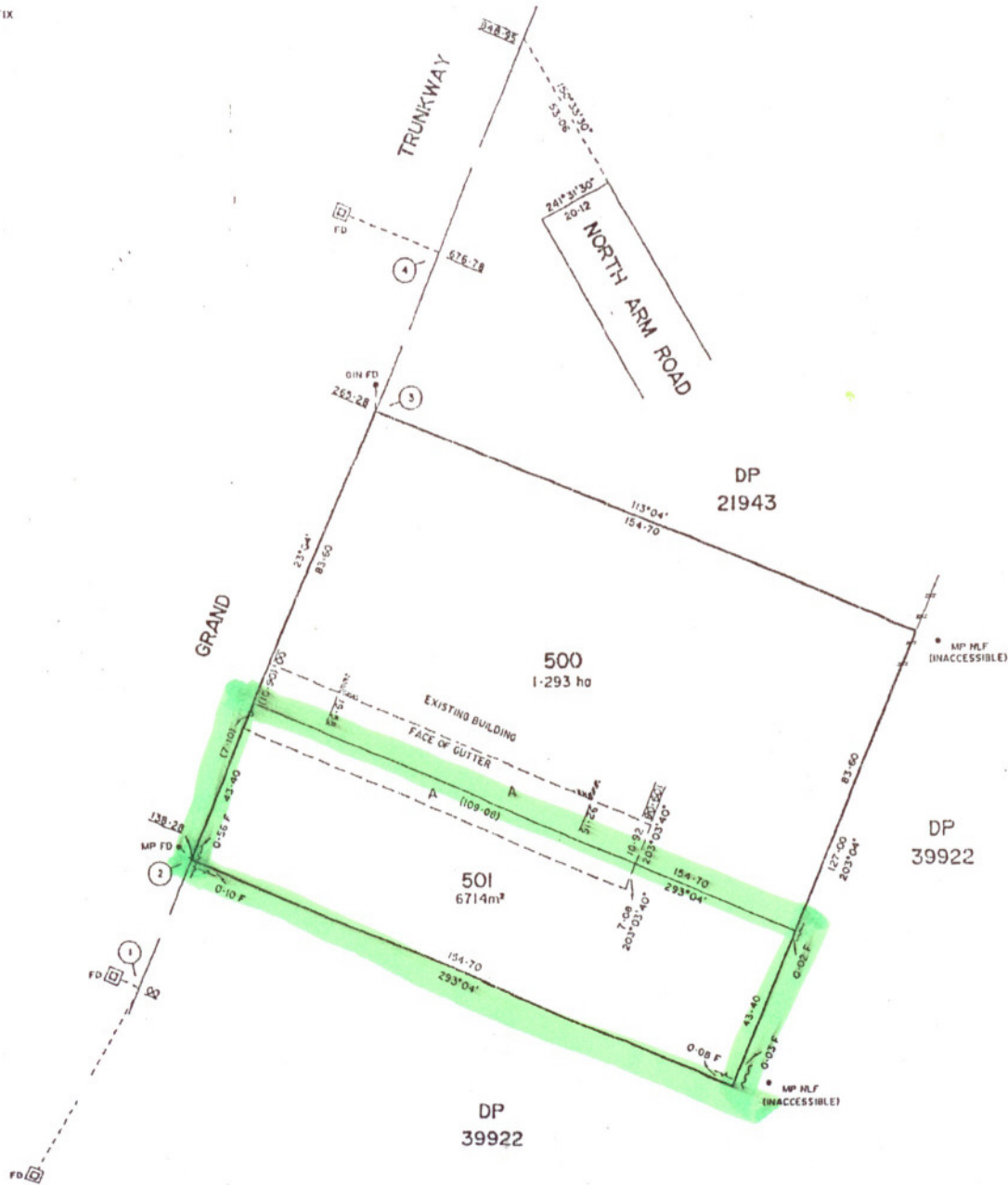

THIS IS SHEET 1 OF 1 SHEETS	
DEPOSITED	/ / 20
ACCEPTED FOR FILING	PRO REGISTRAR, CHERA
MAP REF 6628/31-1	REV No. 040/DS68'03
TITLE SYSTEM	REAL PROPERTY ACT
TITLE REFERENCE	CT 5123/451
DOB / LAST PLAN REF	TOTAL AREA
DOCKET No.	
FIELD BOOK No.	
CLOSURE CHECKED	PLAN EXAMINED
PLAN APPROVED	P.M.S APPROVED
IRRIGATION AREA	DIVISION
HUNDRED	PORT ADELAIDE
AREA	GILLMAN
COUNCIL	CITY OF PORT ADELAIDE ENFIELD

PLAN OF DIVISION
 ALLOTMENT 39 in DP 21943
 of PART SECTION 917

SCALE	0	15	30	45	60	METRES
STATEMENTS CONCERNING EASEMENTS, ANNOTATIONS AND AMENDMENTS						

PORTION OF ALLOTMENTS 500 AND 501 MARKED A ARE TO BE SUBJECT TO A FREE AND UNRESTRICTED EIGHTH OF WAY IN FAVOUR OF SOUTH AUSTRALIAN FIRE SERVICES.

LEGEND	
NETWORK PSM	
NETWORK STATION	
PERMANENT PLACED	
SURVEY FOUND	
MARK GONE	
REFERENCE PLACED	
MARKS FOUND	
GONE	
DRILL HOLE IN WIND	
DIRECTION CHANGE	
PART DISTANCES	[20.32]
CALCULATED DATA	20.85 CALC
COPIED DATA	100.85

ALL DISTANCES ARE GROUND DISTANCES
 COMBINED SCALE FACTOR 1-00023 ZONE 54 WGA 9
 BEARING DATUM 20°46'42" DISTANCE 677-32
 DERIVED FROM PSM 6628/41674 - 6628/36098

JOHN MILLS HARRIS
 Licensed Surveyor of South Australia do hereby certify:
 (1) That this plan has been made from surveys conducted by me, or my personal representatives in accordance with the Survey Act 1982
 (2) That the field work was completed on the 28th day of OCTOBER 2003
 (3) That the true and correct placement of survey marks [initials and not applicable]

BEYORS PTY LTD
 042 882 485
 30AD ROSE PATRIK BA 5067
 1000 FAX (08) 8394 0904
 (07) 8208 8588
 12/2/03 Dwg No. 137480C2
 DATE 8/11/2003

5/11/2003
 Date Licensed Surveyor