



BENNETT + BENNETT

Property Consultants, Surveyors + Town Planners

All mail to: PO Box 5021, GCMC., Qld. 9726
mail@bennettandbennett.com.au
BBH Pty. Ltd. A.C.N. 010 427 531

GOLD COAST OFFICE
95 Upton Street,
Bundall, 4217
Ph (07) 5574 0733
Fax (07) 5574 0202

COOMERA OFFICE
9 Jowett Street,
Coomera, 4209
Ph (07) 5573 6177
Fax (07) 5529 4342

BRISBANE OFFICE
Level 3,
490 Upper Edward St.
Spring Hill, 4004
Ph (07) 3839 7200
Fax (07) 3839 7277

IPSWICH OFFICE
Suite 5,
5-11 Downs Street
North Ipswich, 4305
Ph (07) 3202 1575
Fax (07) 3202 1576



I, Christopher Terence Swane,
cadastral surveyor/director of
BBH Pty Ltd (ACN 010 427 531),
certify that the details shown
on this sketch plan are correct.

Cadastral Surveyor/Director

Date 27/11/13

2
RP94975

1
RP10263

4
RP191179

3
RP191179

3
RP102172

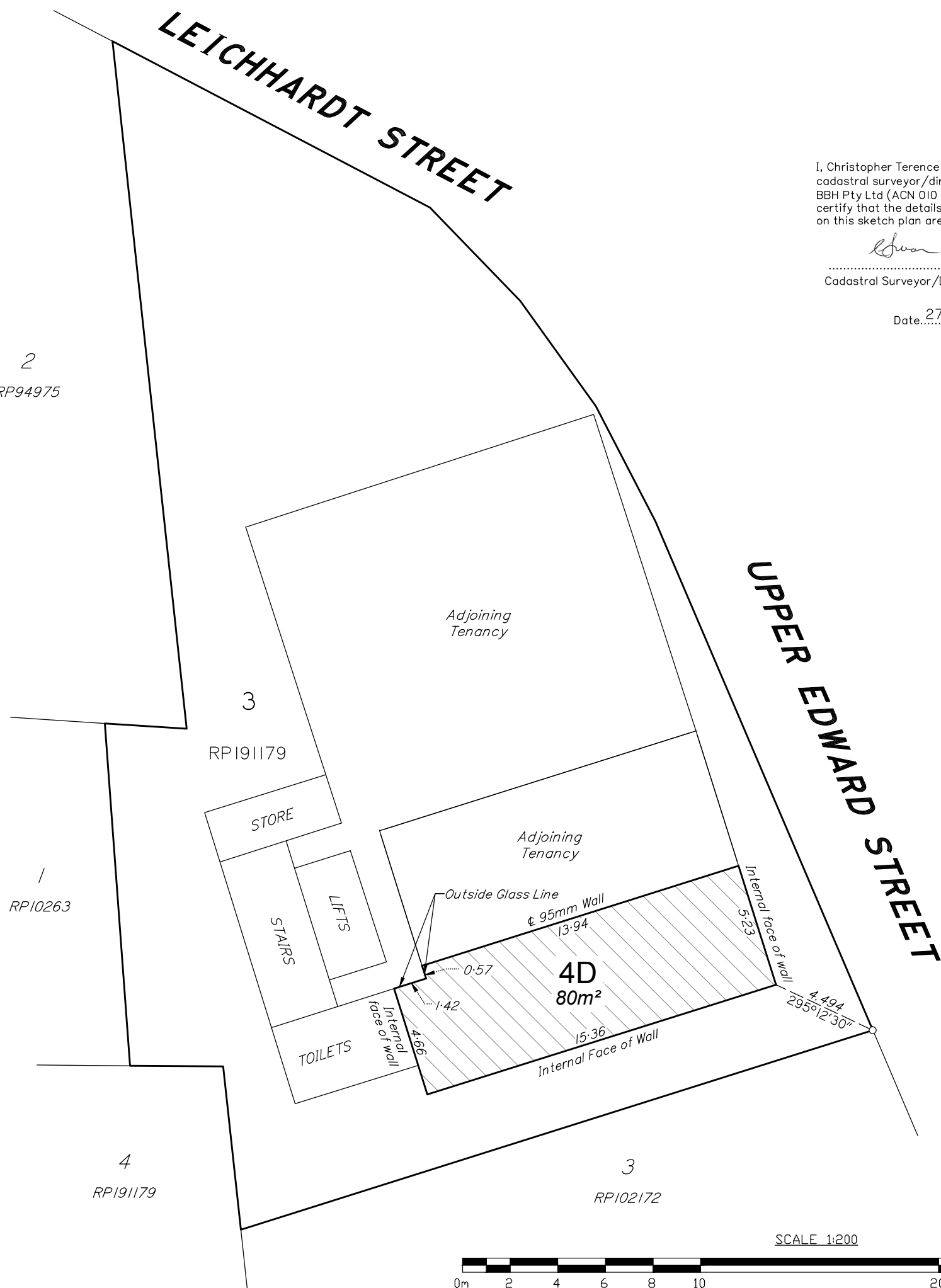

SCALE 1:200



Rev	Date
A	27/11/2013

- NOTES:
1. Drawn to Scale on A3 sheet
 2. Lease area measured in accordance with the P.C.A. recommendations for N.L.A (Net Lettable Area) Office Building.
 3. Title Reference : 18297108.
 4. Adjoining tenancies shown have been compiled from other sources and are diagrammatic only.
 5. Lease boundaries are defined by structural elements, distances shown are indicative only unless noted otherwise.

TITLE
"PLAN OF LEASE 4D"
 at 490 Upper Edward St,
 BRISBANE
 being part of the 4th Floor of the
 building erected on
 Lot 3 on RP191179

CLIENT Upper Edward Partnership		
Drawn	RC	Parish North Brisbane
Surv'd	JC	County STANLEY
Authorised		Job Ref. 05301
L/Book		Comp File -
Date	28/05/10	Dwg File 05301LEA3
SCALE	1:200	PLAN No. 4 Rev. A