

KEY PLAN

0 1000 2500



ISSUE	DESCRIPTION	DATE
2	FOR CONSTRUCTION	19.05.2025
1	FOR CONSTRUCTION	15.04.2025
C	UPDATED BUILDING NUMBER & WALL FINISHES	04.04.2025
B	ISSUE FOR TENDER	03.03.2025
A	ISSUE FOR TENDER	21.02.2025

DESIGN INTENT

THE DESIGNER'S DOCUMENTATION IS NOT INTENDED FOR SUBSTRATE ASSEMBLIES OR STRUCTURAL REQUIREMENTS FOR SUPPORT OR STABILITY. THE OVERALL RESPONSIBILITY FOR THE COORDINATION OF THE INFORMATION PREPARED SHALL REMAIN WITH THE CLIENT'S APPOINTED ARCHITECT. THE APPOINTED ARCHITECT SHALL RETAIN OVERALL RESPONSIBILITY FOR THE ARCHITECTURAL DETAILS OF THE BUILDING, COMPLIANCE WITH LOCAL REGULATION, RELEVANT LIFE SAFETY AND BUILDING CODES AND OTHER TECHNICAL PERFORMANCE REQUIREMENTS. FOLLOWING THE APPOINTMENT OF A CONTRACTOR, THE DESIGNER SHALL REVIEW AND COMMENT UPON ALL SHOP DRAWINGS PREPARED BY THE CONTRACTOR PRIOR TO CONSTRUCTION.

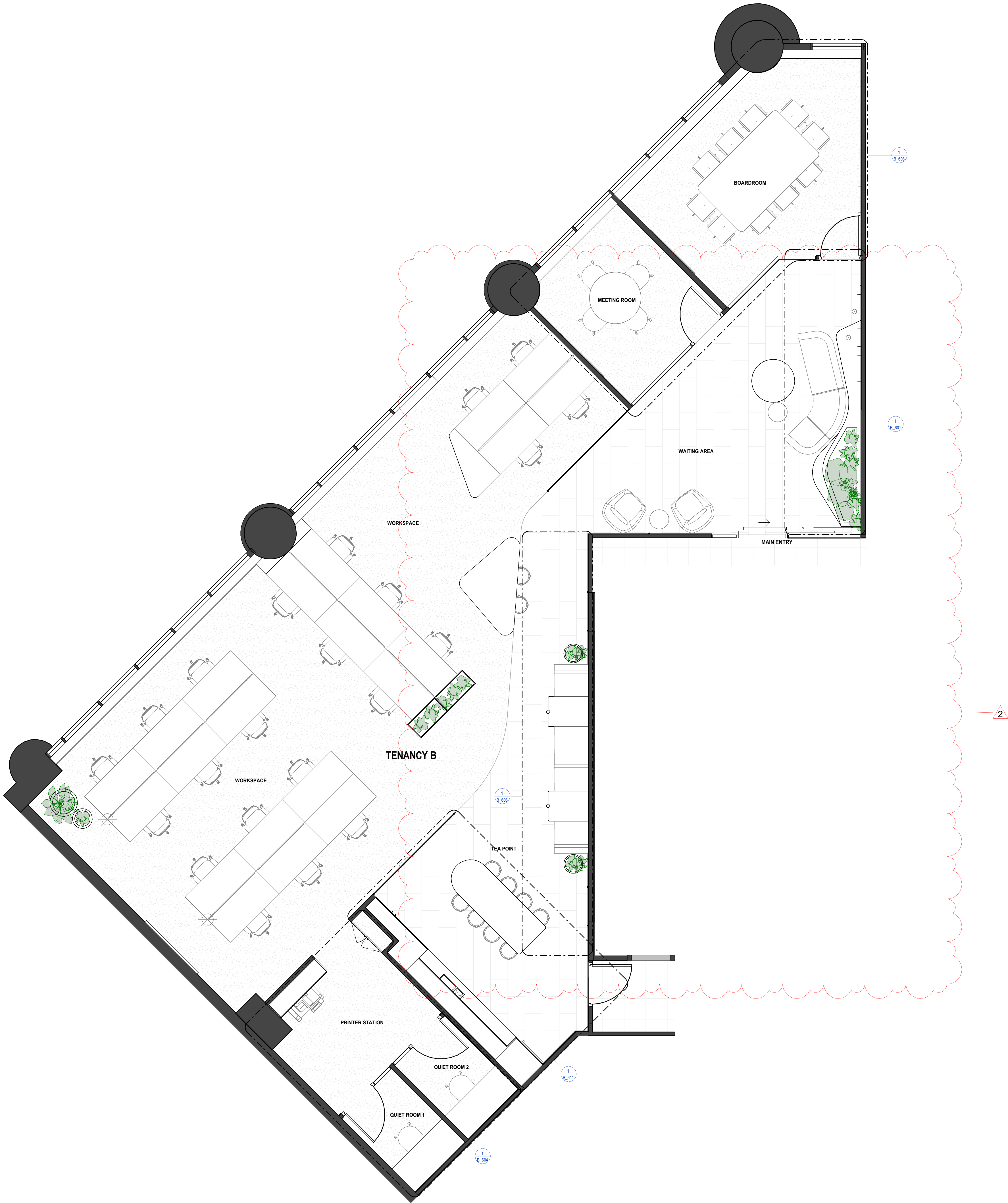

FOR CONSTRUCTION

CLIENT

Elanor

BUILDER

GIRVAN

PROJECT NAME

L18 OFFICE
REFURBISHMENT

PROJECT ADDRESS

LEVEL 18, 221
ADELAIDE STREET

DRAWING TITLE

GA PLAN - TENANCY B

CHECKER	DRAWN BY	SHEET SIZE	SCALE
JT	EPP	A1	1:50
DRAWING NUMBER	ISSUE		
1165_B_101	2		

